

STATE OF WISCONSIN  
DEPARTMENT OF NATURAL RESOURCES

LAKE SURVEY MAP

LELAND POND LAKE SAUK COUNTY  
SEC. 18, 19 T. 10 N. R. 5 E.

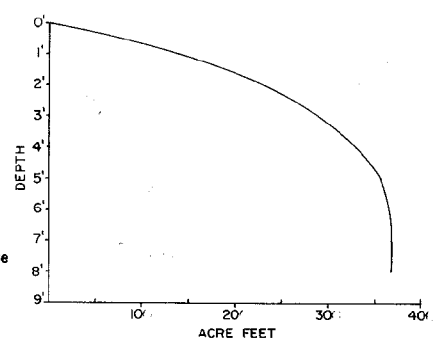
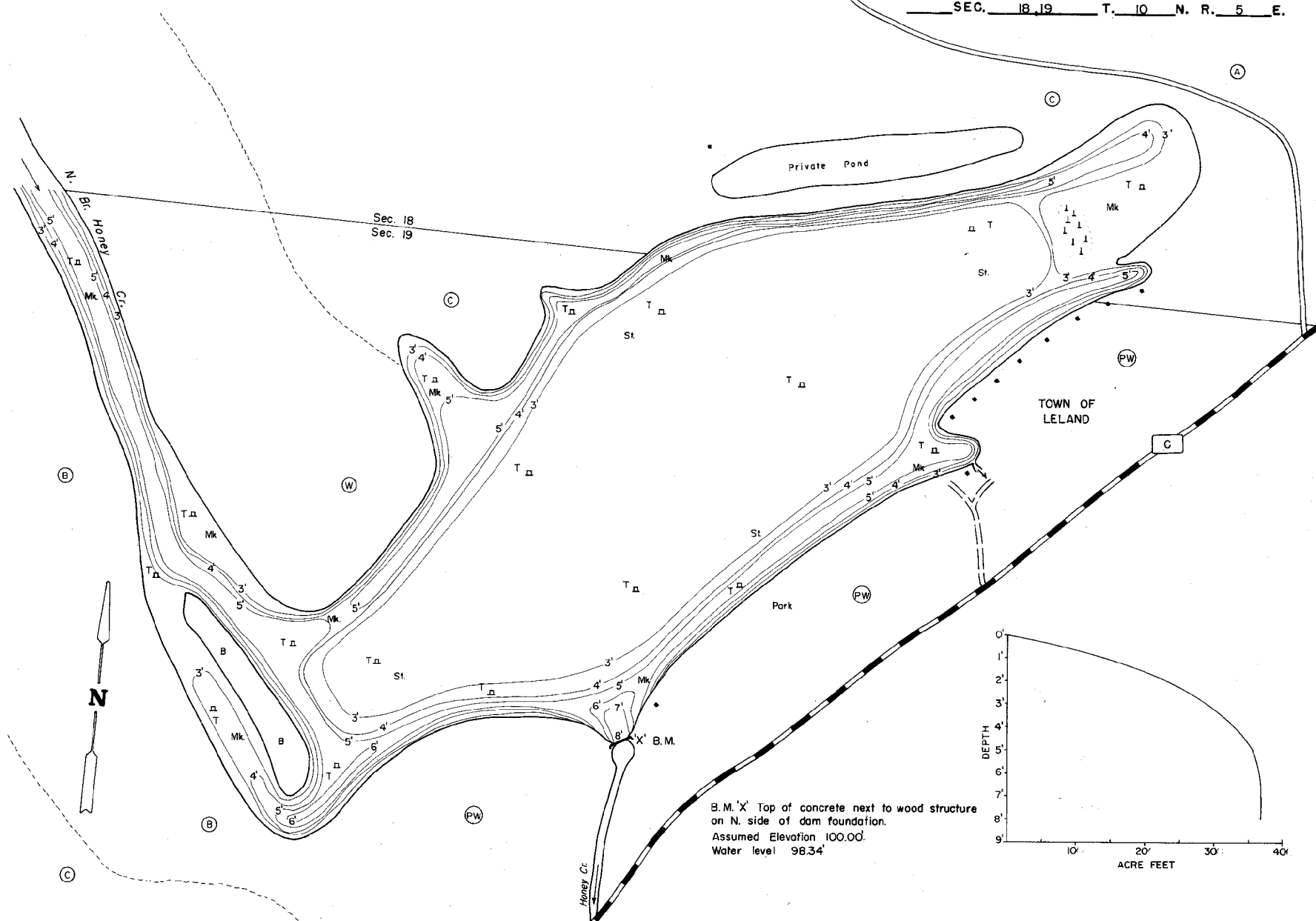

B.M. 'X' Top of concrete next to wood structure  
on N. side of dam foundation.  
Assumed Elevation 100.00'  
Water level 98.34'

EQUIPMENT RECORDING SONAR MAPPED AUG 1970  
MONTH YEAR

- | TOPOGRAPHIC SYMBOLS |                        | LAKE BOTTOM SYMBOLS |                             |
|---------------------|------------------------|---------------------|-----------------------------|
| (B) Brush           | Steep slope            | P. Peat             | B Boulders                  |
| (PW) Partly wooded  | ~ Indefinite shoreline | Mk. Muck            | ☼ Stumps & Snags            |
| (W) Wooded          | ~ Marsh                | C. Clay             | ⚠ Rock danger to navigation |
| (C) Cleared         | ~ Spring               | M. Marl             | T Submergent vegetation     |
| (P) Pastured        | ~ Intermittent stream  | Sd. Sand            | ⌊ Emergent vegetation       |
| (A) Agricultural    | ~ Permanent inlet      | St. Silt            | ⌋ Floating vegetation       |
| B.M. Bench Mark     | ~ Permanent outlet     | Gr. Gravel          | ⌋ Brush shelters            |
| • Dwelling          | ~ Dam                  | P. Subst.           |                             |

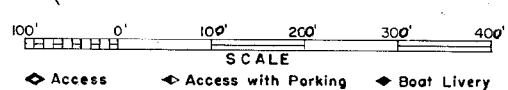

SPECIES OF FISH	Abundance		
	Abundant	Common	Present
Muskie			X
N. Pike			X
Walleye			X
L. M. Bass			X
S. M. Bass			X

WATER AREA 14.3 ACRES  
 UNDER 3 FT. 65 %  
 OVER 20 FT. 0 %  
 MAX. DEPTH 8 FEET.  
 TOTAL ALK. 172 P.P.M.  
 VOLUME 366 ACRE FT.