

STATE OF WISCONSIN
DEPARTMENT OF NATURAL RESOURCES

LAKE SURVEY MAP

LITTLE ST. GERMAIN LAKE
SEC. 19, 23 THRU 27 T. 40 N. R. 8.9 E.
30, 34, 35 (Sheet 1 of 2 sheets)

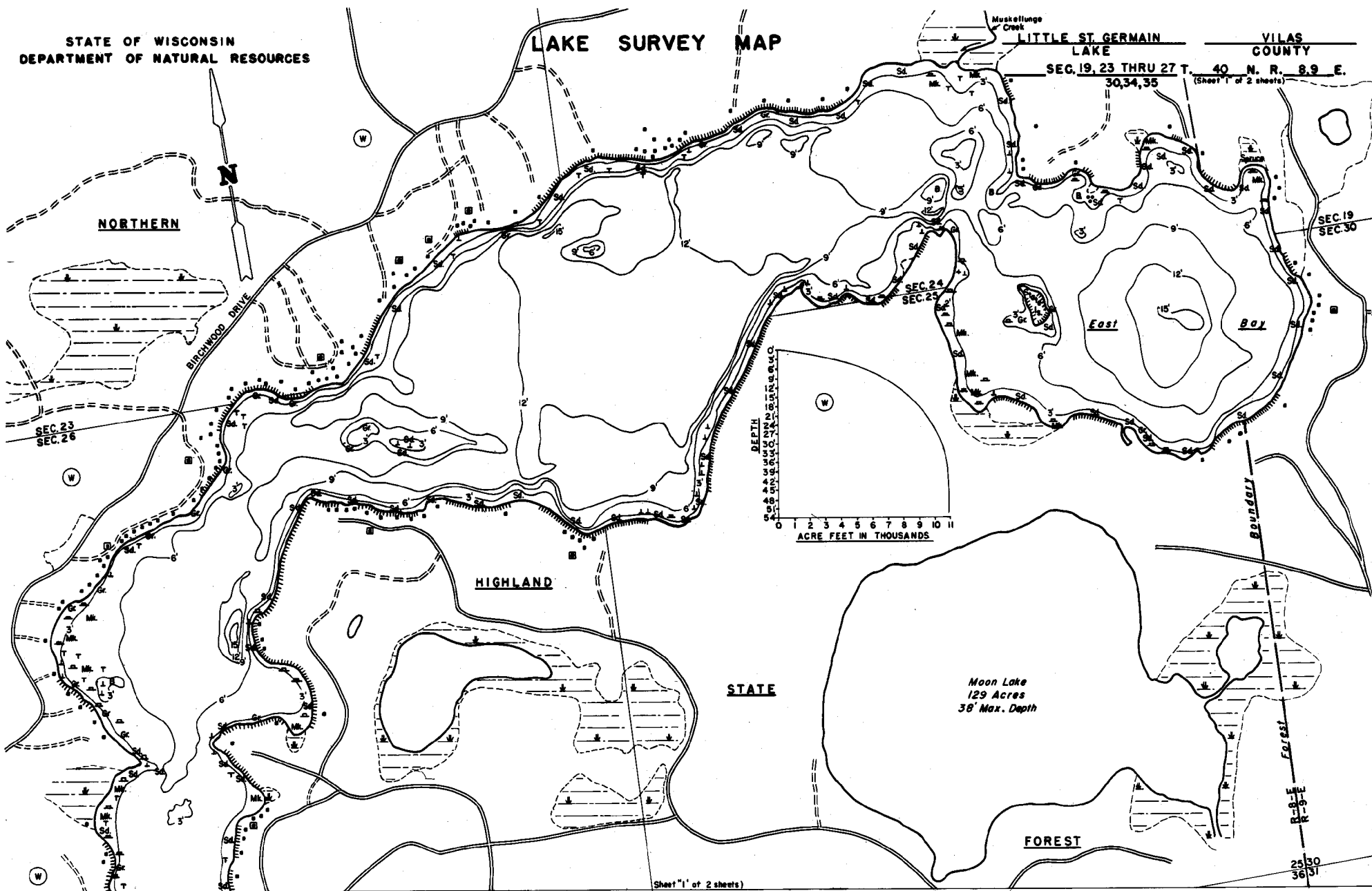

Sheet "1" of 2 sheets
(Sheet "2" of 2 sheets)

EQUIPMENT RECORDING SONAR MAPPED AUGUST 1975

- | TOPOGRAPHIC SYMBOLS | | LAKE BOTTOM SYMBOLS | |
|----------------------|-------------------------------|---------------------|-----------------------------|
| (B) Brush | () Steep slope | P. Peat | B Boulders |
| (W) Partially wooded | (---) Indefinite shoreline | Mk. Muck | ⚡ Stumps & Snags |
| (W) Wooded | (---) Marsh | C. Clay | ⚡ Rock danger to navigation |
| (C) Cleared | (---) Spring | M. Marl | T Submergent vegetation |
| (P) Pastured | (---) Intermittent stream | Sd. Sand | ⚡ Emergent vegetation |
| (A) Agricultural | (---) Permanent inlet | St. Silt | ⚡ Floating vegetation |
| B.M. Bench Mark | (---) Permanent outlet | Gr. Gravel | ⚡ Brush shelters |
| (D) Dwelling | (---) Dam | R. Rubble | |
| (R) Resort | (---) D.N.R. State owned land | Bc. Bedrock | |

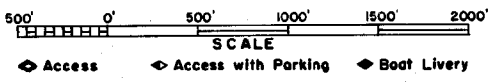

Drawn by: G. Thussen
Field work by: L. Smith

SPECIES OF FISH	Abundance			
	Abundant	Common	Present	Not Present
Muskie				
N. Pike				
Walleye		X		
L. M. Bass		X		
S. M. Bass		X		
Panfish	X			
Trout				
Cisco				

WATER AREA 980 ACRES
 UNDER 3 FT. 11.4 %
 OVER 20 FT. 14.5 %
 MAX. DEPTH 53 FEET.
 TOTAL ALK. 37 P.P.M.
 VOLUME 10980.49 ACRE FT.
 MAIN SHORELINE 14.50 MI.
 ISLAND SHORELINE 0.2 MI.