

WISCONSIN CONSERVATION DEPARTMENT

LAKE SURVEY MAP

LOON LAKE BARRON COUNTY
 SEC. 5.32 T. 34.35 N. R. 14 W.

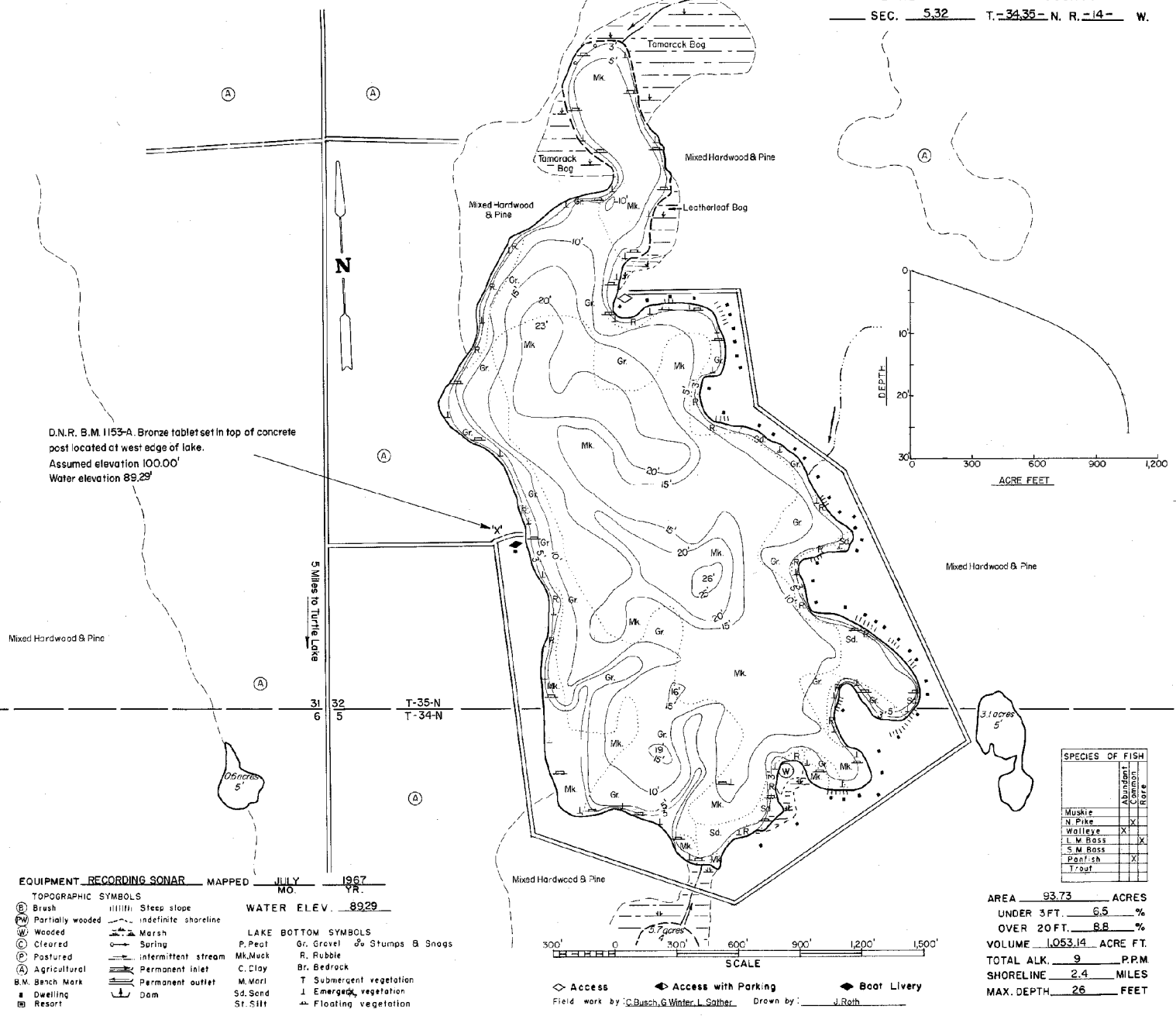

D.N.R. B.M. 1153-A. Bronze tablet set in top of concrete post located at west edge of lake. Assumed elevation 100.00' Water elevation 89.29'

SPECIES OF FISH		
	Abundant	Rare
Muskie		
N Pike	X	
Walleye	X	
L.M. Bass		X
S.M. Bass		X
Panfish	X	
Trout		

AREA 93.73 ACRES
 UNDER 3 FT. 6.5 %
 OVER 20 FT. 8.8 %
 VOLUME 1053.14 ACRE FT.
 TOTAL ALK. 9 P.P.M.
 SHORELINE 2.4 MILES
 MAX. DEPTH 26 FEET

EQUIPMENT RECORDING SONAR MAPPED JULY 1967
 MO. YR.

- TOPOGRAPHIC SYMBOLS
- (B) Brush
 - (PW) Partially wooded
 - (W) Wooded
 - (C) Cleared
 - (P) Pastured
 - (A) Agricultural
 - B.M. Bench Mark
 - Dwelling
 - Resort
- LAKE BOTTOM SYMBOLS
- P. Peat
 - Mk. Muck
 - C. Clay
 - M. Marl
 - Sd. Sand
 - St. Silt
 - Gr. Gravel & Stumps & Snags
 - R. Rubble
 - Br. Bedrock
 - T. Submergent vegetation
 - ↓ Emergent vegetation
 - ↔ Floating vegetation
- WATER ELEV. 89.29

SCALE 300' 0 300' 600' 900' 1200' 1500'

◆ Access ◀ Access with Parking ◆ Boat Livery
 Field work by C. Busch, G. Winter, L. Saiber. Drawn by J. Roth

Maps are not for navigation
 Source-Wisconsin Department of Natural Resources
 Hunt Fish Camp Wisconsin .Com 2005