

LAKE SURVEY MAP

LAKE LOWER KAUBESHINE  
 SECTION 3, 4, 9  
 TOWNSHIP 38 N  
 RANGE 6 E  
 TOWN OF HAZELHURST  
 COUNTY ONEIDA

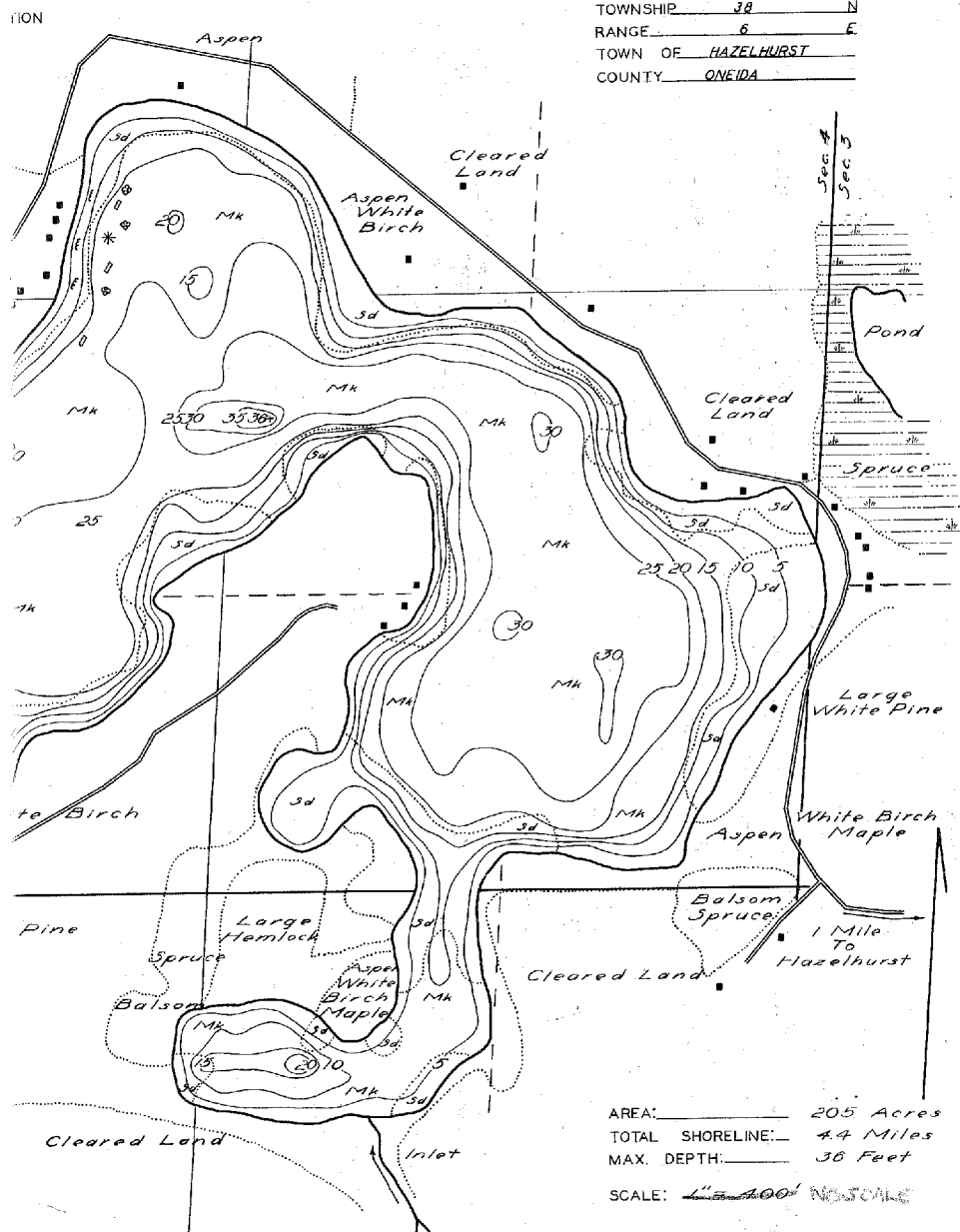

AREA: 205 Acres  
 TOTAL SHORELINE: 4.4 Miles  
 MAX. DEPTH: 38 Feet  
 SCALE: 1" = 400' NO SCALE

LAKE IMPROVEMENT RECORD			
TYPE	DATE	RECORD	
⊕	BRUSH REFUGES	<u>6</u>	
⊖	SAPLING TANGLES	<u>41</u>	
□	SPAWNING BOXES	<u>5</u>	
*	MINNOW SPAWNERS	<u>3</u>	
	TOTAL	<u>57</u>	

LEGEND	
⊕	WEED BEDS
⊖	ROCKY SHOALS
Sd	SAND
Cl	CLAY
Gr	GRAVEL
Mk	MUCK
■	DWELLING
□	ABANDONED DWELLING
■	RESORT

75-5  
 Blue Lake  
 15