

STATE OF WISCONSIN
DEPARTMENT OF NATURAL RESOURCES

LAKE SURVEY MAP

LYNX
LAKE

VILAS
COUNTY

SEC. 18, 19, 24 T. 43 N. R. 6, 7 E.

Rudolph Lake
79 Acres
26' Deep

Pleasure Isle 5 miles

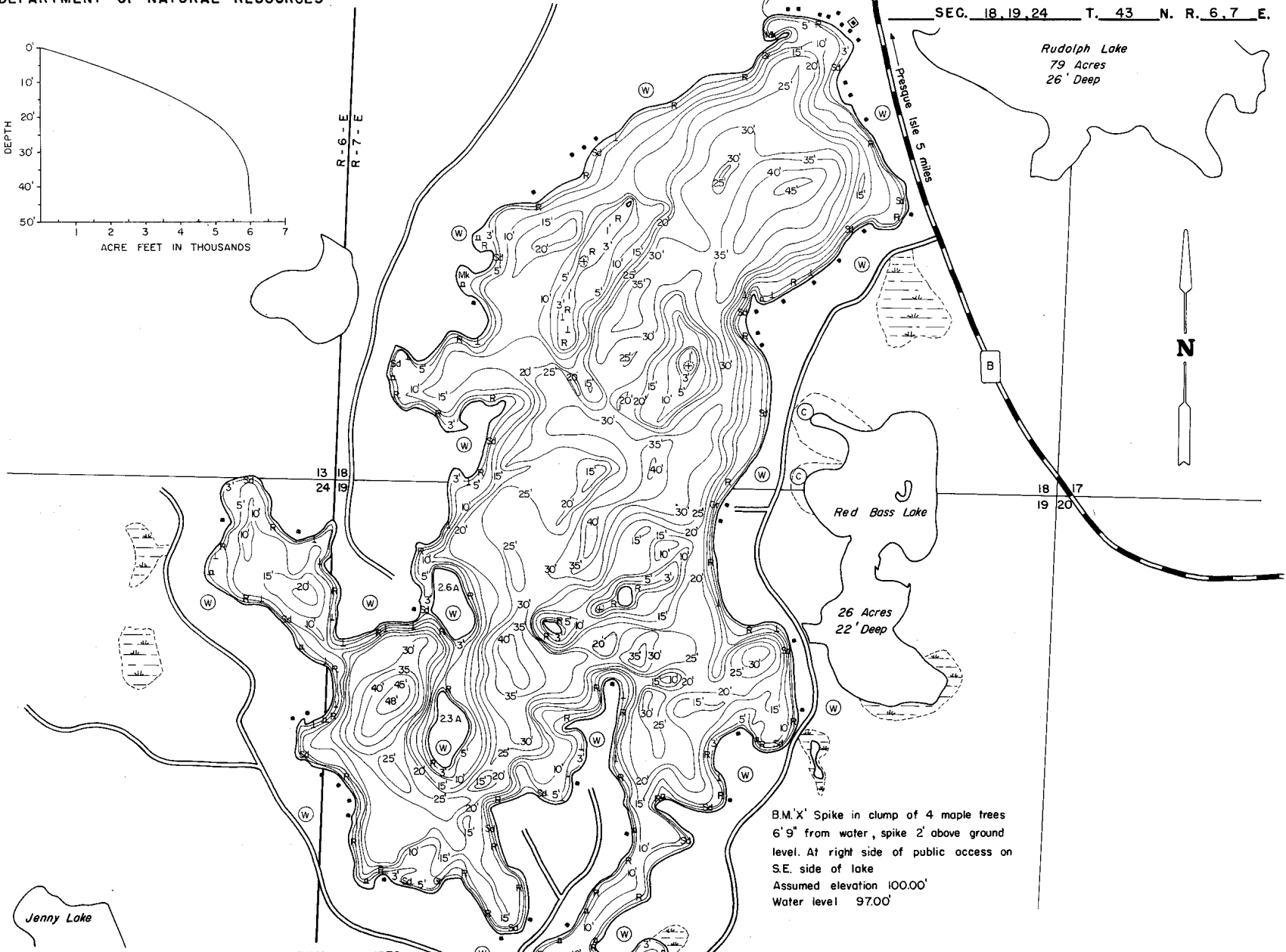
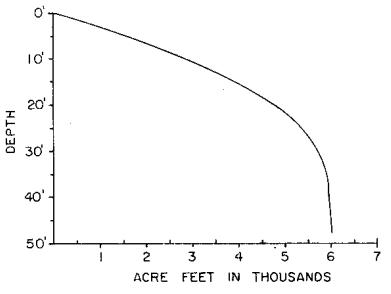

B.M.'X' Spike in clump of 4 maple trees
6' 9" from water, spike 2' above ground
level. At right side of public access on
S.E. side of lake
Assumed elevation 100.00'
Water level 97.00'

EQUIPMENT RECORDING SONAR MAPPED JULY 1970

TOPOGRAPHIC SYMBOLS		LAKE BOTTOM SYMBOLS	
(B) Brush	Steep slope	P. Peat	B Boulders
(PW) Partially wooded	----- Indefinite shoreline	Mk. Muck	* Stumps & Snags
(W) Wooded	----- Marsh	C. Clay	⊕ Rock danger to navigation
(C) Cleared	----- Spring	M. Marl	T Submergent vegetation
(P) Pastured	----- Intermittent stream	Sd. Sand	⊥ Emergent vegetation
(A) Agricultural	----- Permanent inlet	Sl. Silt	Δ Floating vegetation
B.M. Bench Mark	----- Permanent outlet	G. Gravel	⊕ Brush shelters
■ Dwelling	----- Dam	R. Rubble	



◆ Access ◀ Access with Parking ◆ Boat Livery

SPECIES OF FISH

Species	Abundance		
	Abundant	Common	Present
Muskie			X
N. Pike			X
Walleye		X	
L.M. Bass		X	
S.M. Bass		X	
Panfish		X	

WATER AREA 338.7 ACRES

UNDER 3 FT. 6.4 %
OVER 20 FT. 43 %

MAX. DEPTH 48 FEET.

TOTAL ALK. 8 P.P.M.

VOLUME 6008 ACRE FT.

SHORELINE 6.27 MILES