

STATE OF WISCONSIN
DEPARTMENT OF NATURAL RESOURCES

LAKE SURVEY MAP

MAPLE LAKE ONFIDA COUNTY
SEC. 6 T. 38 N. R. 11 E.

B.M. 'X' N.W. corner of 4' x 4' x 3' cement support for control structure on outlet at N. side of lake
Assumed elevation 100.00'
Water level 95.83' (July 1969)

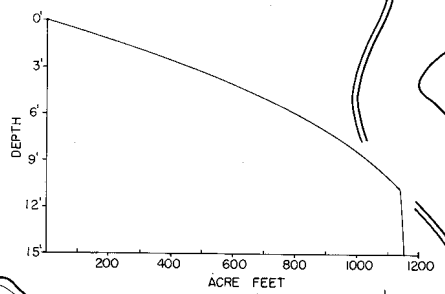
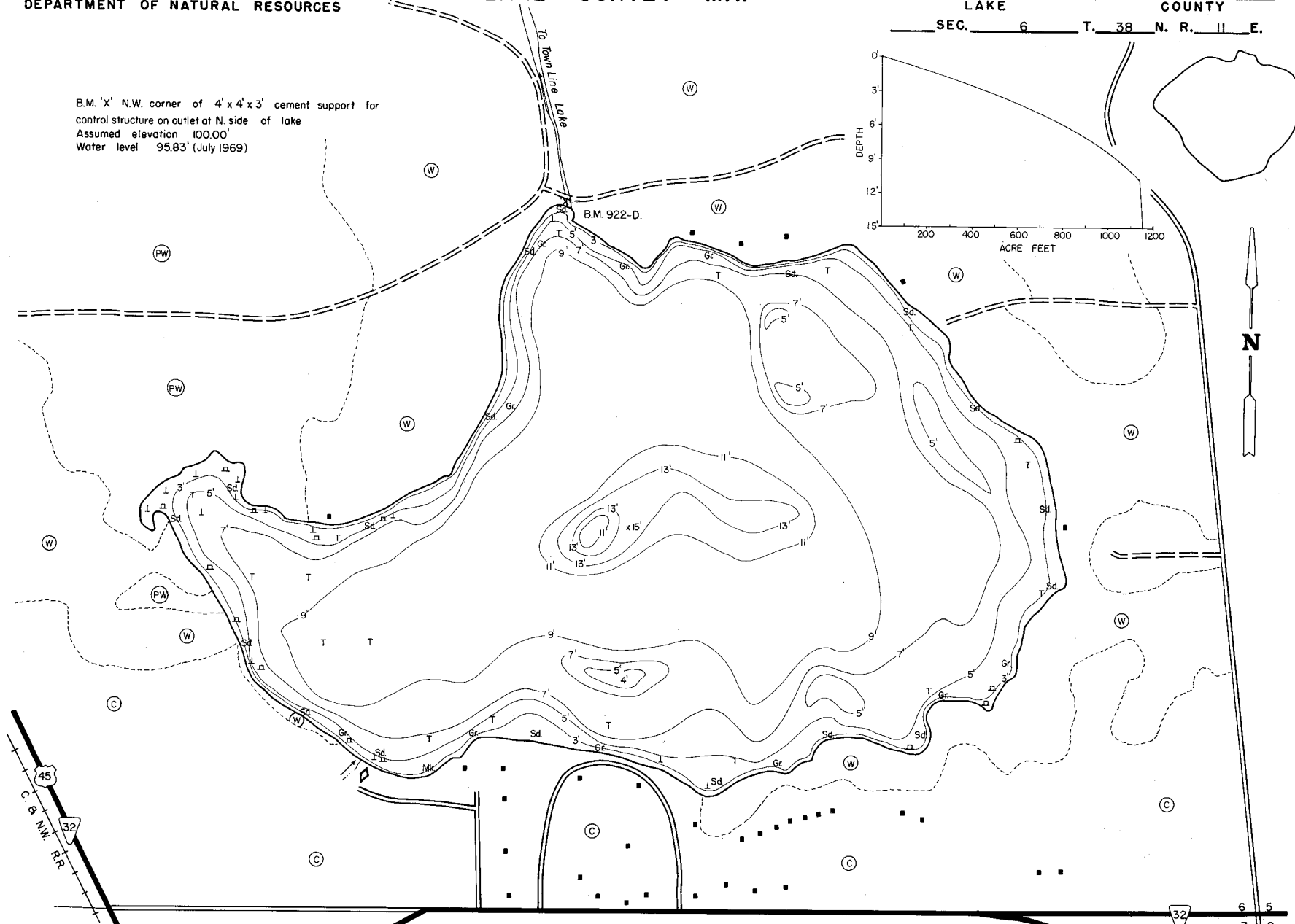

EQUIPMENT RECORDING SONAR MAPPED JULY 1969
MONTH YEAR

- | TOPOGRAPHIC SYMBOLS | | LAKE BOTTOM SYMBOLS | |
|-----------------------|----------------------------|---------------------|-----------------------------|
| (B) Brush | Steep slope | P. Peat | B Boulders |
| (PW) Partially wooded | ----- Indefinite shoreline | Mk. Muck | ☼ Stumps & Snags |
| (W) Wooded | ⊞ Marsh | C. Clay | ⚠ Rock danger to navigation |
| (C) Cleared | ○ Spring | M. Marl | T Submergent vegetation |
| (P) Pastured | --- Intermittent stream | Sd. Sand | ⌒ Emergent vegetation |
| (A) Agricultural | ==== Permanent inlet | Sl. Silt | ⌒ Floating vegetation |
| B.M. Bench Mark | ==== Permanent outlet | Gr. Gravel | ⌒ Brush shelters |
| ■ Dwelling | ⌒ Dam | R. Rubble | |

THREE LAKES



- ◆ Access ◆ Access with Parking ◆ Boat Livery

SPECIES OF FISH	Abundance		
	Abundant	Common	Present
Muskie			X
N. Pike	X		
Walleye	X		
L. M. Bass	X		
S. M. Bass	X		
Panfish	X		

WATER AREA 143.5 ACRES
UNDER 3 FT. 5.1 %
OVER 20 FT. 0 %
MAX. DEPTH 15 FEET.
TOTAL ALK. 36 P.P.M.
VOLUME 1149.1 ACRE FT.
SHORELINE 200 MILES