

STATE OF WISCONSIN
DEPARTMENT OF NATURAL RESOURCES

LAKE SURVEY MAP

McDERMOTT
LAKE

IRON
COUNTY

SEC. 30 T. 41 N. R. 3 E.

Sec. 29
Sec. 30

B.M. 'X' 1391-A Square cut in
outcrop, 44' S. of lake, 14' E. of access.
Assumed elevation 100.00'
Water level 93.38'

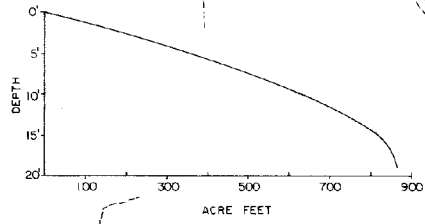
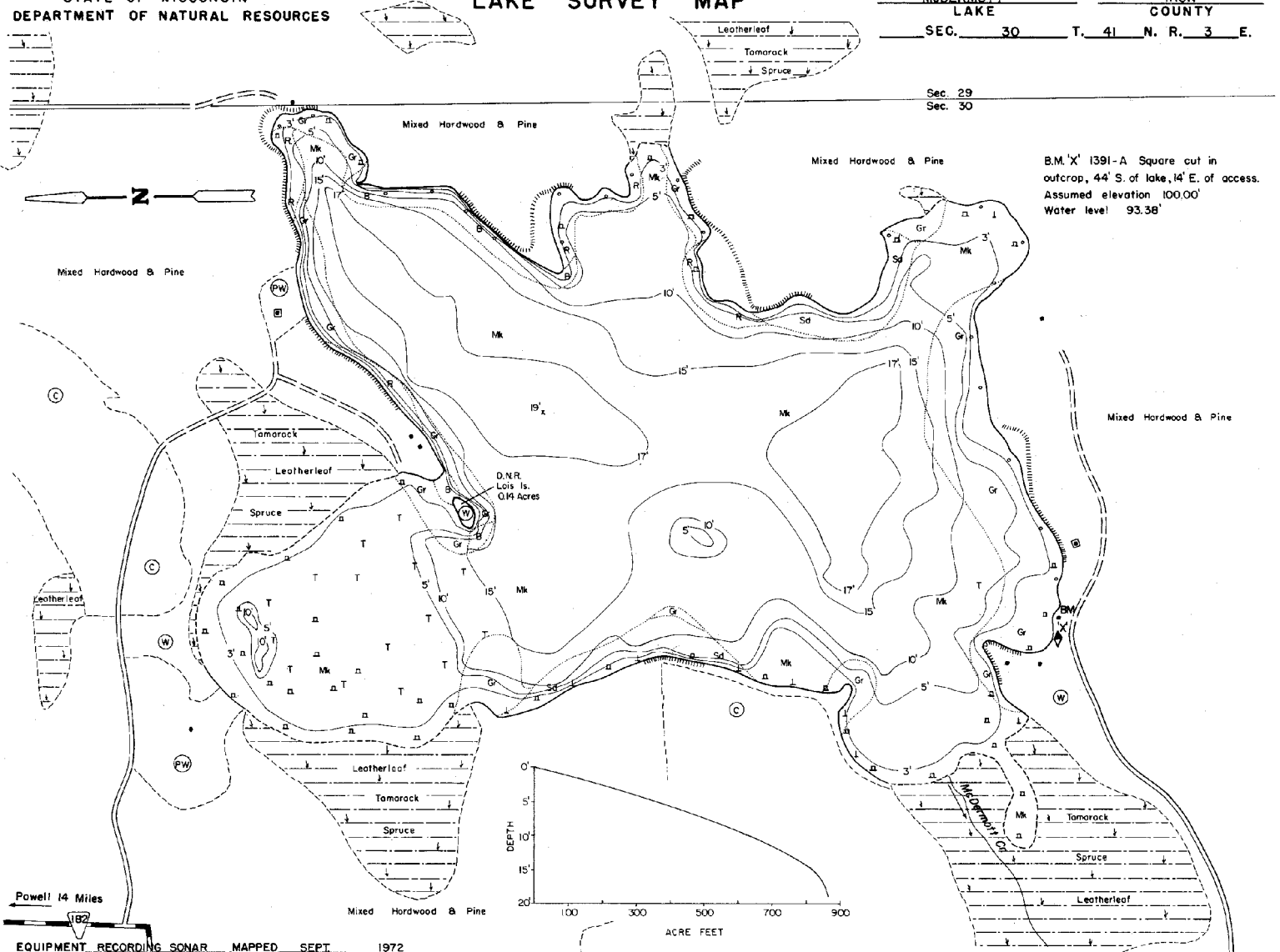

EQUIPMENT	RECORDING SONAR	MAPPED	SEPT	1972
TOPOGRAPHIC SYMBOLS		MONTH LAKE BOTTOM SYMBOLS		
(B) Brush	() Steep slope	P. Peat	B Boulders	
(PW) Partially wooded	(-----) Indefinite shoreline	Mk Muck	St Stumps & Snags	
(W) Wooded	(~) Marsh	C. Clay	(*) Rock danger to navigation	
(C) Cleared	(S) Spring	M. Marl	(T) Submergent vegetation	
(P) Pastured	(---) Intermittent stream	Sd. Sand	(J) Emergent vegetation	
(A) Agricultural	(=) Permanent inlet	Sl. Silt	(F) Floating vegetation	
B.M. Bench Mark	(=) Permanent outlet	Gr. Gravel	(B) Brush shelters	
(D) Dwelling	(/ /) Dam	R. Rubble		
(R) Resort	(---) D.N.R. State owned land	Bc Bedrock		
(C) Camp				

225' 0 225' 450' 675' 900'
SCALE
Access Access with Parking Boat Livery
Drawn by: C. Hilt
Field work by: C. Busch, G. Lund, L. Salber

SPECIES OF FISH	1972	
	Abundant	Common
Muskie	X	X
N. Pike	X	X
Walleye	X	X
L. M. Bass	X	X
S. M. Bass	X	X
Panfish	X	X
Trout		

WATER AREA 83.7 ACRES
UNDER 3 FT. 11 %
OVER 20 FT. 0 %
MAX. DEPTH 19 FEET.
TOTAL ALK. 38 P.P.M.
VOLUME 865 ACRE FT.
SHORELINE 2.52 MILES
SHORELINE 2.59 MILES WITH IS.

Maps are not for navigation
Source-Wisconsin Department of Natural Resources
Hunt Fish Camp Wisconsin .Com 2005