

# LAKE SURVEY MAP

STATE OF WISCONSIN  
DEPARTMENT OF NATURAL RESOURCES

MISSION LAKE  
MARATHON COUNTY  
SEC. 36 T. 27 N. R. 9 E.

Elderon 5 miles

25 30  
36 31

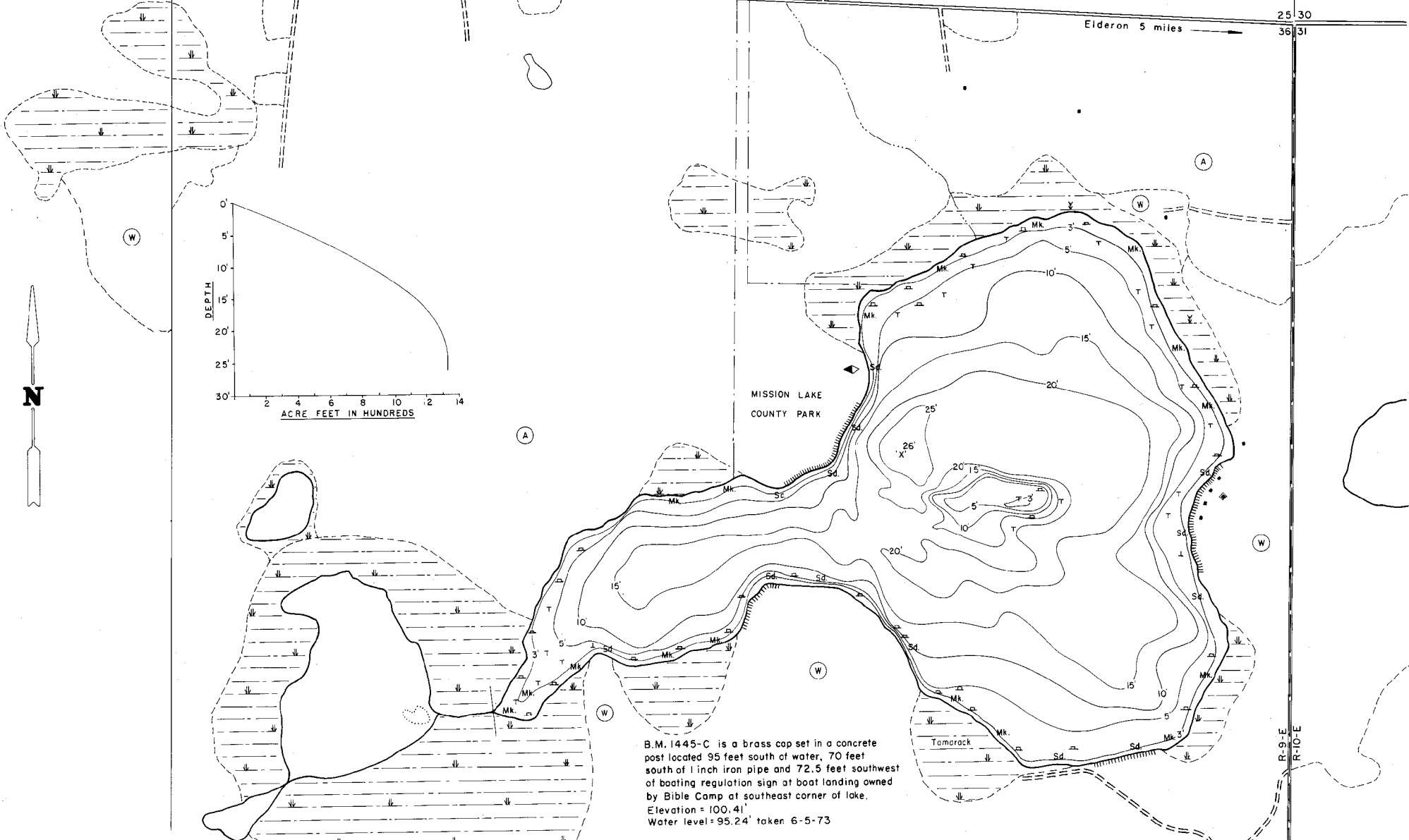

B.M. 1445-C is a brass cap set in a concrete post located 95 feet south of water, 70 feet south of 1 inch iron pipe and 72.5 feet southwest of boating regulation sign at boat landing owned by Bible Camp at southeast corner of lake.  
Elevation = 100.41'  
Water level = 95.24' taken 6-5-73

EQUIPMENT RECORDING SONAR MAPPED SEPT 1974  
MONTH YEAR

- | TOPOGRAPHIC SYMBOLS   |                         | LAKE BOTTOM SYMBOLS |                           |
|-----------------------|-------------------------|---------------------|---------------------------|
| (B) Brush             | Steep slope             | P. Peat             | B Boulders                |
| (PW) Partially wooded | ~ Indefinite shoreline  | Mk. Muck            | Stumps & Snags            |
| (W) Wooded            | Marsh                   | C. Clay             | Rock danger to navigation |
| (C) Cleared           | Spring                  | M. Marl             | Submergent vegetation     |
| (P) Pastured          | Intermittent stream     | Sd. Sand            | Emergent vegetation       |
| (A) Agricultural      | Permanent inlet         | Sl. Silt            | Floating vegetation       |
| B.M. Bench Mark       | Permanent outlet        | Gr. Gravel          | Brush shelters            |
| Dwelling              | Dam                     | R. Rubble           |                           |
| Resort                | D.N.R. State owned land | Bc. Bedrock         |                           |



Access Access with Parking Boat Livery

Drawn by G. Thuesen  
Field work by J. Smith, K. Kaplan

SPECIES OF FISH	Abundance		
	Abundant	Common	Present
Muskie			X
N. Pike			X
Walleye			X
L.M. Bass	X		
S.M. Bass			X
Panfish	X		
Trout			X

WATER AREA 102.84 ACRES

UNDER 3 FT. 7.7 %  
OVER 20 FT. 16.65 %  
MAX. DEPTH 26 FEET.  
TOTAL ALK. 77 P.P.M.  
VOLUME 1332.12 ACRE FT.  
MAIN SHORELINE 2.12 MI.  
ISLAND SHORELINE 0 MI.