

STATE OF WISCONSIN  
DEPARTMENT OF NATURAL RESOURCES

LAKE SURVEY MAP

MONROE  
LAKE  
LINGOLN  
COUNTY  
SEC. AS SHOWN T. 34. 35 N. R. 6 E.  
SHEET 1 OF 3

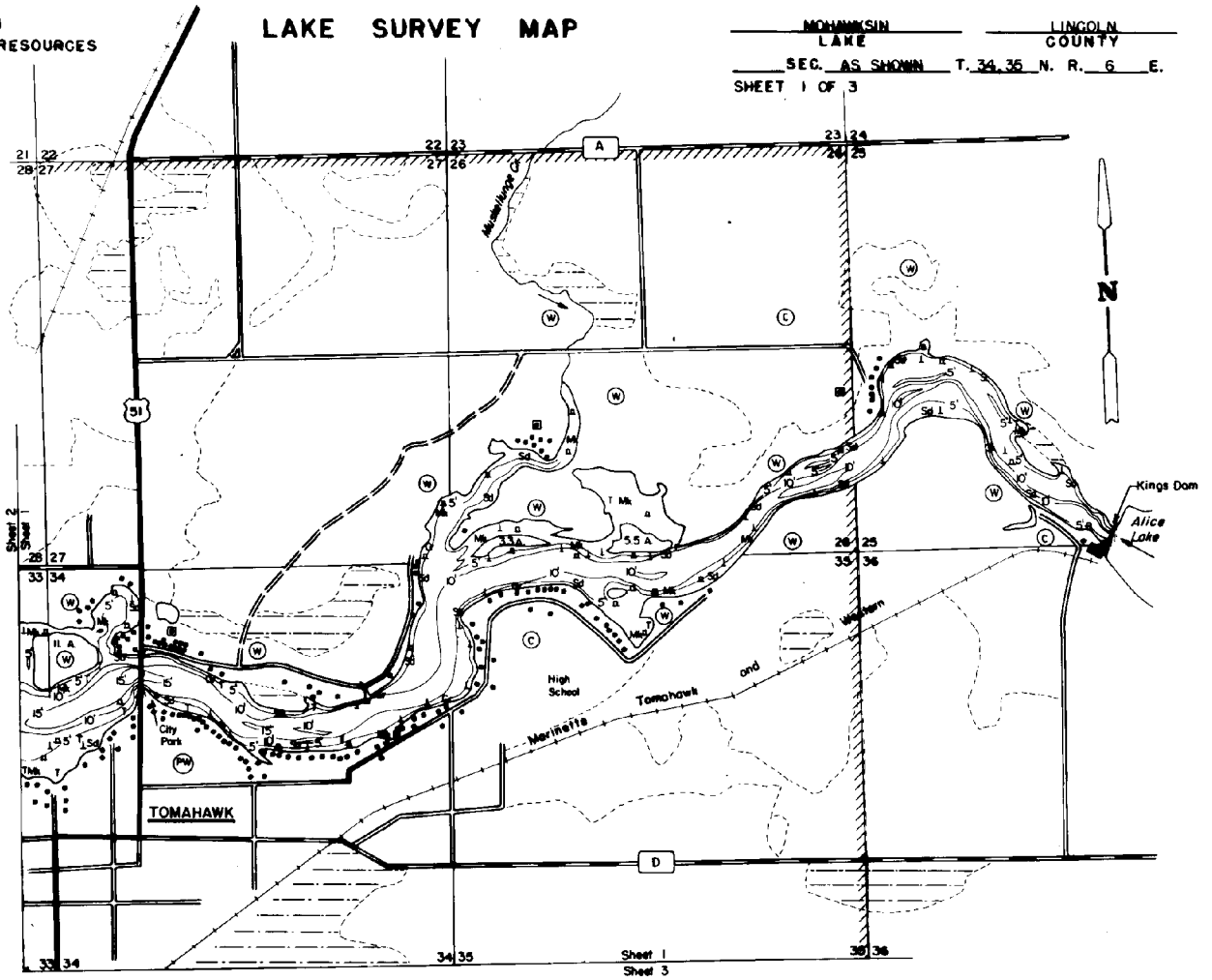

EQUIPMENT	RECORDING	SOUND	MAPPED	NOV	1999
TOPOGRAPHIC SYMBOLS			LAKE BOTTOM SYMBOLS		
(B) Brush	(W) Wounded	(M) Marsh	(P) Peat	(B) Boulders	(Mk) Muck
(PW) Partially wooded	(C) Cleared	(S) Spring	(M) Marl	(S) Stumps & Snags	(C) Clay
(P) Pastured	(A) Agricultural	(IS) Intermittent stream	(M) Marl	(RD) Rock danger to navigation	(M) Marl
(B.M.) Bench Mark	(D) Dwelling	(PI) Permanent inlet	(Sd) Sand	(SV) Submergent vegetation	(M) Marl
(R) Resort	(Camp) Camp	(PO) Permanent outlet	(Sl) Silt	(E) Emergent vegetation	(M) Marl
		(D) Dam	(Gr) Gravel	(F) Floating vegetation	(M) Marl
		(D.N.R.) State owned land	(R) Rubble	(BS) Brush shelters	(M) Marl
			(Br) Bedrock		(M) Marl

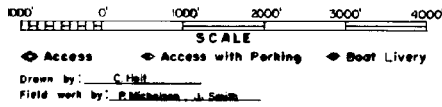

SPECIES OF FISH		ABUNDANCE	PERCENT
Bluegill		X	
W. Pike		X	
Shor. Eye		X	
L. H. Bass		X	
S. W. Bass		X	
Panfish		X	
Trout			

WATER AREA 1909.6 ACRES  
 UNDER 3 FT. 20 %  
 OVER 20 FT. 0.3 %  
 MAX. DEPTH 25 FEET.  
 TOTAL ALK. 32 P.P.M.  
 VOLUME 16,540 ACRE FT.  
 SHORELINE 30.12 MILES  
 SHORELINE 35.15 MILES WITH IS.

Maps are not for navigation  
 Source-Wisconsin Department of Natural Resources  
 Hunt Fish Camp Wisconsin .Com 2005