

STATE OF WISCONSIN  
DEPARTMENT OF NATURAL RESOURCES

LAKE SURVEY MAP

MONKSHISM LAKE LINCOLN COUNTY  
SEC. AS SHOWN T. 34, 35 N. R. 6 E.  
SHEET 3 OF 3

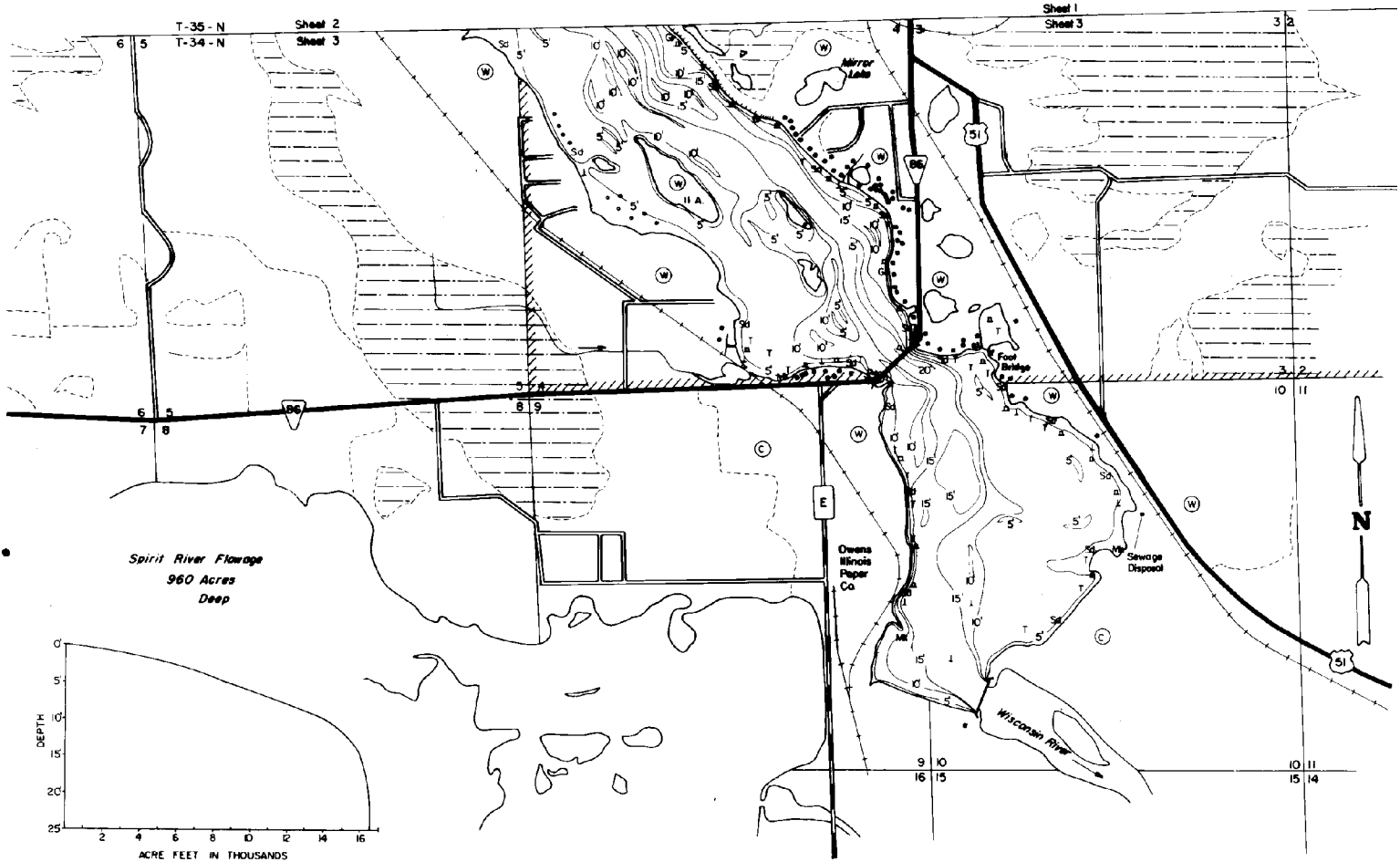

- EQUIPMENT RECORDING SONAR MAPPED JULY 1969
- | TOPOGRAPHIC SYMBOLS   |                            | LAKE BOTTOM SYMBOLS |                             |
|-----------------------|----------------------------|---------------------|-----------------------------|
| (B) Brush             | Steep slope                | P. Peat             | B Boulders                  |
| (PW) Partially wooded | - - - Indefinite shoreline | Mk Muck             | ⊙ Stumps & Snags            |
| (W) Wooded            | ⊖ Marsh                    | C. Clay             | ⊙ Rock danger to navigation |
| (C) Cleared           | ○ Spring                   | M. Marl             | T Submergent vegetation     |
| (P) Pastured          | - - - Intermittent stream  | Sd. Sand            | I Emergent vegetation       |
| (A) Agricultural      | ==== Permanent inlet       | Sl. Silt            | ⊖ Floating vegetation       |
| B.M. Bench Mark       | ==== Permanent outlet      | Gr. Gravel          | ⊖ Brush shelters            |
| ■ Dwelling            | ⊖ Dam                      | R. Rubble           |                             |
| ■ Resort              | D.N.R. State owned land    | Br Bedrock          |                             |
| ■ Camp                |                            |                     |                             |

SCALE 0 1000' 2000' 3000' 4000'

◆ Access ◆ Access with Parking ◆ Boat Livery

Drawn by: C. Hall  
Field work by: P. Michelson, J. Smith

SPECIES OF FISH	MAPPED		
	Abundant	Common	Present
Muskie			X
N. Pine	X		
Walleye	X		
L. Bass	X		
S. Bass	X		
Panfish	X		
Trout			

WATER AREA 1909.6 ACRES  
UNDER 3 FT. 20 %  
OVER 20 FT. 0.3 %  
MAX. DEPTH 25 FEET.  
TOTAL ALK. 32 P.P.M.  
VOLUME 16,540 ACRE FT.  
SHORELINE 30.12 MILES  
SHORELINE 35.15 MILES WITH IS.

Maps are not for navigation  
Source-Wisconsin Department of Natural Resources  
Hunt Fish Camp Wisconsin .Com 2005