

LAKE SURVEY MAP

WISCONSIN CONSERVATION DEPARTMENT  
BIOLOGY DIVISION  
LAKE AND STREAM IMPROVEMENT SECTION

LAKE MOON  
SECTION 17-18  
TOWNSHIP 47 N  
RANGE 8 W  
TOWN OF IRON RIVER  
COUNTY BAYFIELD

FORM F-11

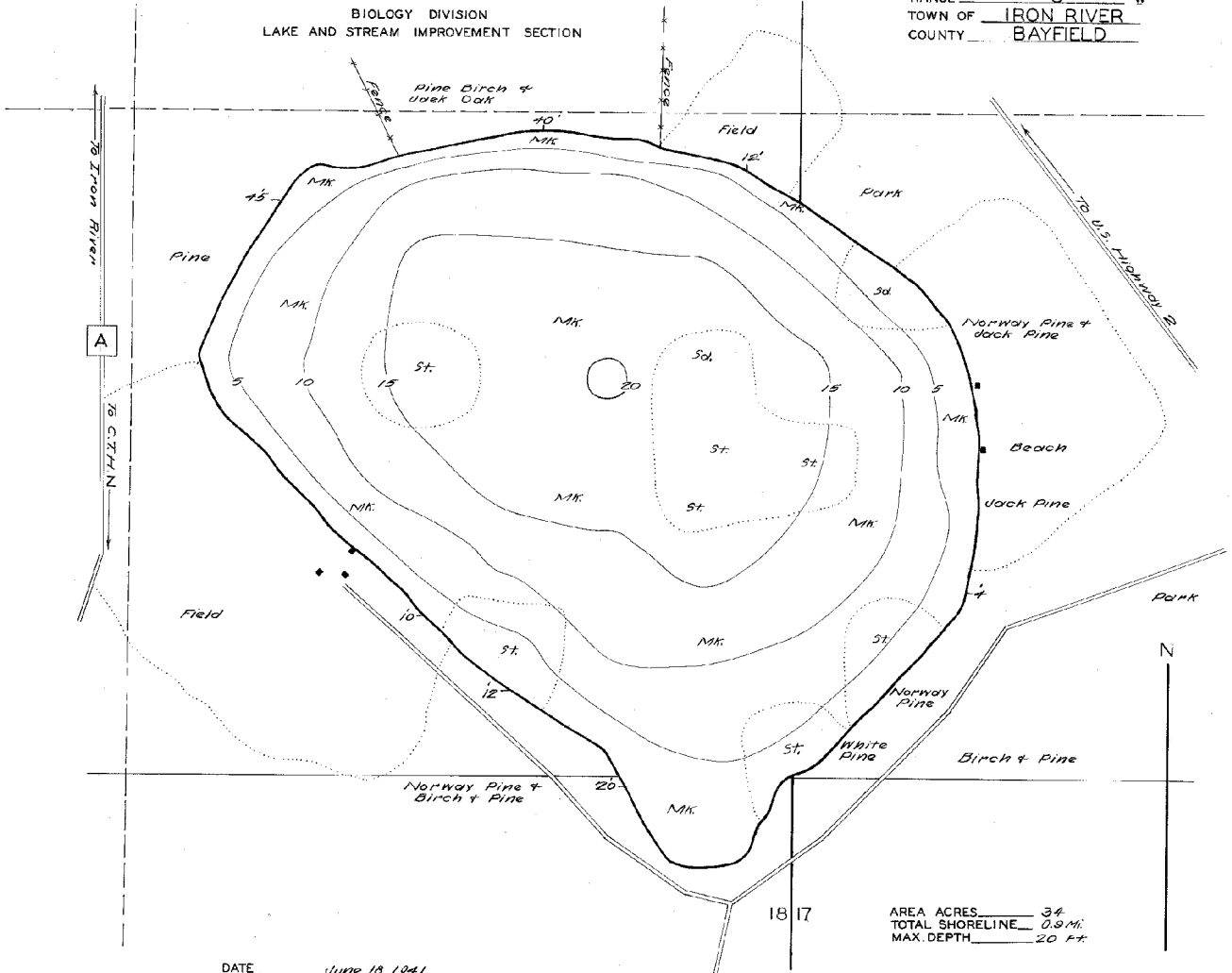

AREA ACRES 34  
TOTAL SHORELINE 0.9 MI.  
MAX. DEPTH 20 FT.

SCALE 1 inch Equals 150 FT.

DATE June 18 1941  
COMPILED \_\_\_\_\_  
TRACED BY W.P.S. (W.P.A.)  
SOURCE OF INFORMATION  
W.P.A. Lake Survey Project  
Aerial Photo  
SOUNDINGS at 200' intervals  
\_\_\_\_\_  
\_\_\_\_\_  
DATES OF MAP REVISION \_\_\_\_\_  
\_\_\_\_\_  
WORK AGENCY W. P. A.

| LAKE IMPROVEMENT RECORD |       |
|-------------------------|-------|
| TYPE                    | DATE  |
| ○ BRUSH REFUGES         | _____ |
| — SAPLING TANGLES       | _____ |
| □ SPAWNING BOXES        | _____ |
| * MINNOW SPAWNERS       | _____ |
| TOTAL                   | _____ |

| LEGEND |                    |
|--------|--------------------|
| ○      | WEED BEDS          |
| □      | ROCKY SHOALS       |
| Sd.    | SAND               |
| C      | CLAY               |
| G      | GRAVEL             |
| MK     | MUCK               |
| ■      | DWELLING           |
| □      | ABANDONED DWELLING |
| ■      | RESORT             |
| St.    | SILT               |

*Checked*  
*11/25*  
*1/27*  
*627*

Maps are not for navigation  
Source-Wisconsin Department of Natural Resources  
Hunt Fish Camp Wisconsin .Com 2005