

STATE OF WISCONSIN
DEPARTMENT OF NATURAL RESOURCES

LAKE SURVEY MAP

PICKEREL LAKE
VILAS COUNTY
SEC. 5.8 T.-40 - N. R. - 9- E.

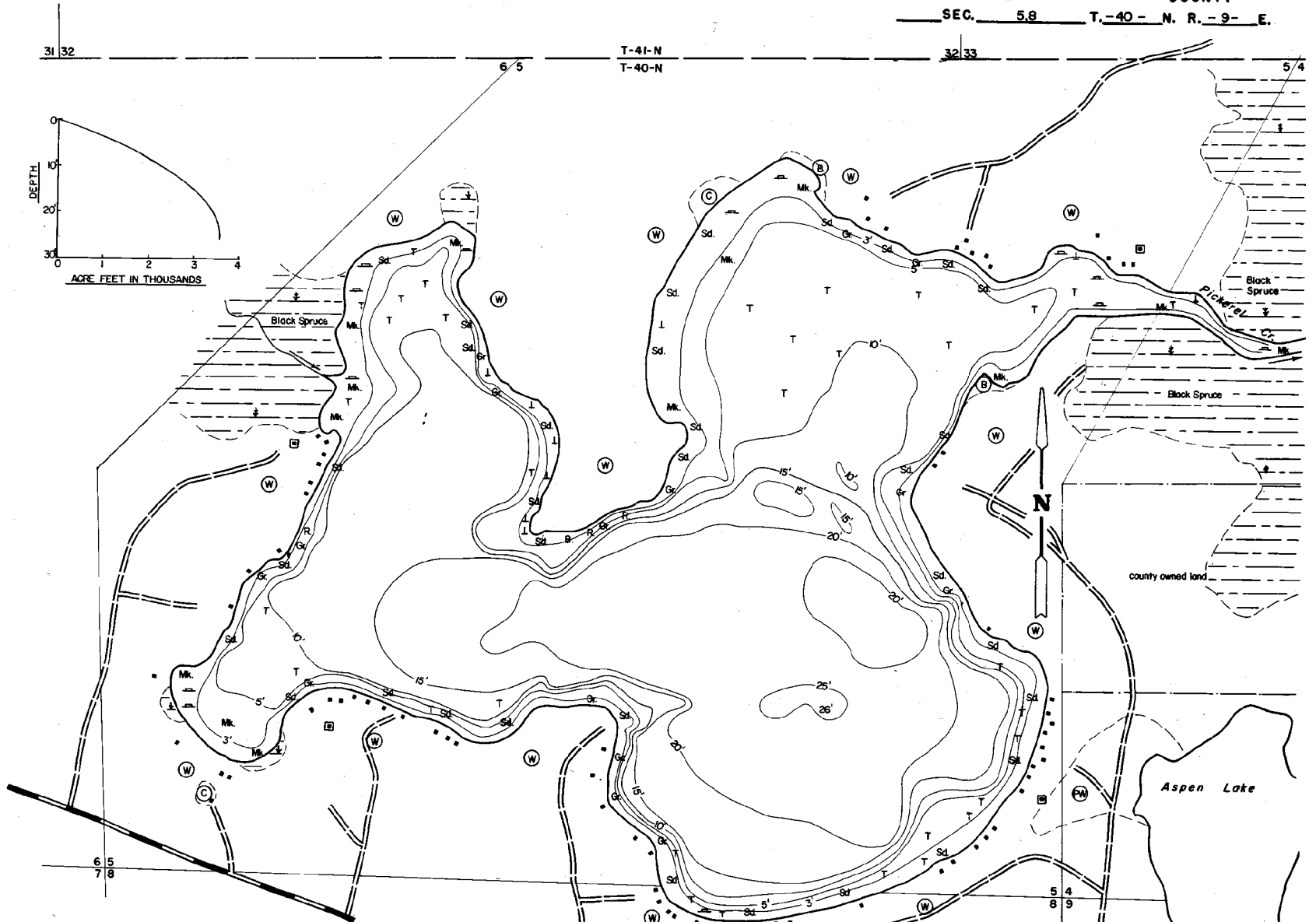

EQUIPMENT RECORDING SONAR MAPPED JULY 1968
MONTH YEAR
LAKE BOTTOM SYMBOLS

- | | | |
|----------------------------|----------------------------|----------------------------|
| TOPOGRAPHIC SYMBOLS | LAKE BOTTOM SYMBOLS | LAKE BOTTOM SYMBOLS |
| (B) Brush | Steep slope | P. Peat |
| (W) Partially wooded | ~ Indefinite shoreline | Mk. Muck |
| (W) Wooded | Marsh | C. Clay |
| (C) Cleared | Spring | M. Marl |
| (P) Pastured | Intermittent stream | Sd. Sand |
| (A) Agriculture | Permanent inlet | Sl. Silt |
| B.M. Bench Mark | Permanent outlet | Gr. Gravel |
| Dwelling | Dam | R. Rubble |
| Resort | D.N.R. State owned land | Bc Bedrock |
| | | B Boulders |
| | | Stumps & Snags |
| | | Rock danger to navigation |
| | | T Submergent vegetation |
| | | Emergent vegetation |
| | | Floating vegetation |
| | | Brush shelters |

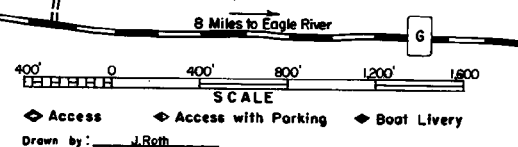

SPECIES OF FISH

Species	1968	1969	1970	1971	1972
Muskie	X	X	X	X	X
N. Pike	X	X	X	X	X
Walleye	X	X	X	X	X
L. M. Bass	X	X	X	X	X
S. M. Bass	X	X	X	X	X
Panfish	X	X	X	X	X
Trout	X	X	X	X	X

WATER AREA 293.0 ACRES
UNDER 3 FT. 13 %
OVER 20 FT. 23 %
MAX. DEPTH 26 FEET.
TOTAL ALK. 36 P.P.M.
VOLUME 3,555.3 ACRE FT.
SHORELINE 4.4 MILES