

STATE OF WISCONSIN  
DEPARTMENT OF NATURAL RESOURCES

LAKE SURVEY MAP

PIKE LAKE BAYFIELD COUNTY  
SEC. 21 T. 47 N. R. 8 W.

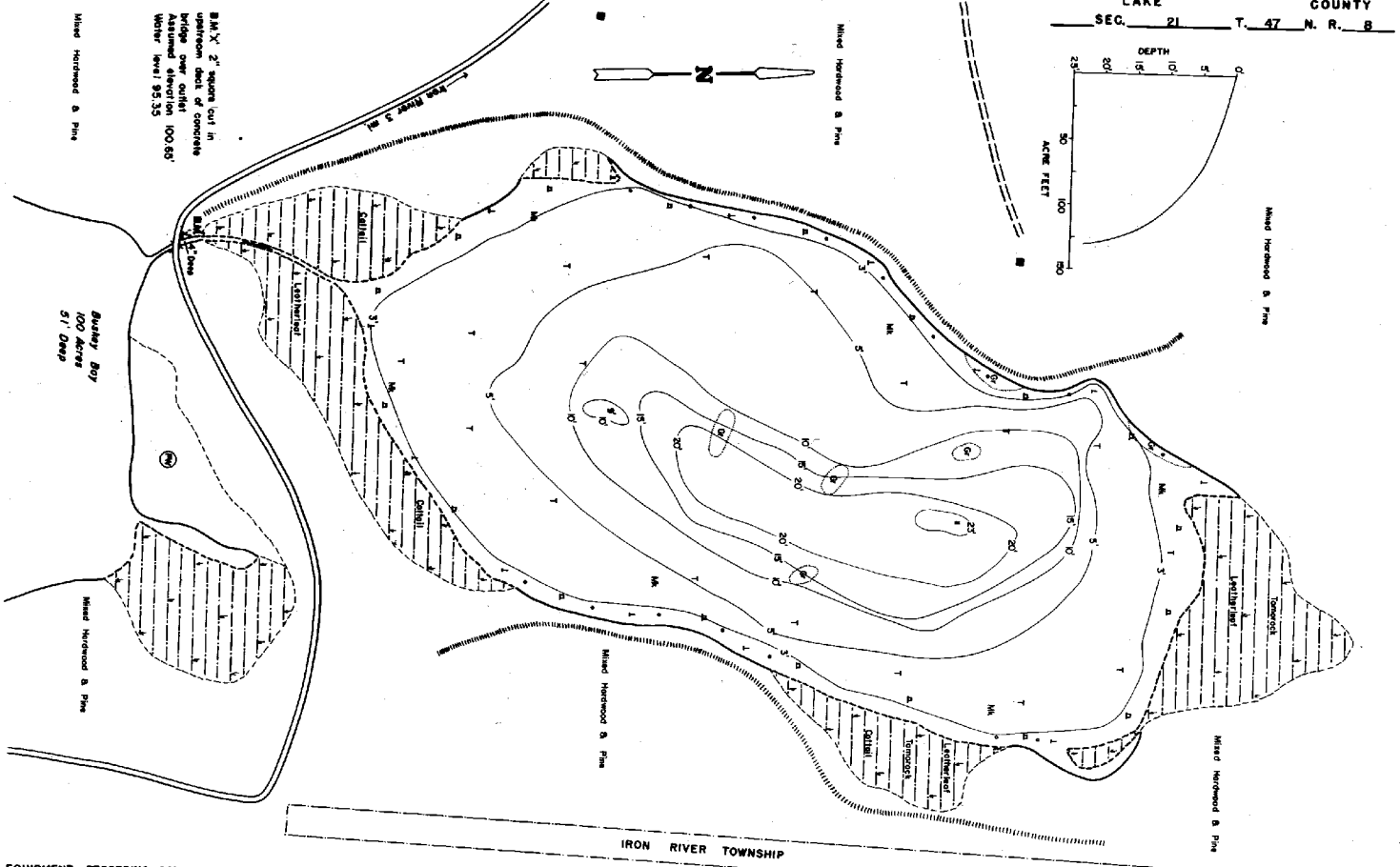

B.M. X 2" square cut in  
upstream deck of concrete  
bridge over outlet  
Assumed elevation 100.65'  
M.W.M. level 95.35

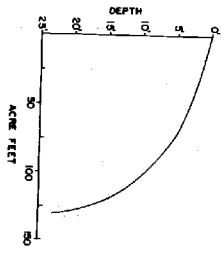

EQUIPMENT RECORDING SONAR MAPPED JULY 1972

TOPOGRAPHIC SYMBOLS	MONTH	YEAR	LAKE BOTTOM SYMBOLS
(A) Brush	(S) Steep slope	P. Peat	B Boulders
(P) Partially wooded	(L) Lenticular shoreline	Mt. Muck	S Stumps & Snags
(W) Wooded	(M) Marsh	C. Clay	R Rock danger to navigation
(C) Cleared	(S) Spring	M. Marl	T Submerged vegetation
(P) Pastured	(I) Intermittent stream	Sd. Sand	J Emergent vegetation
(A) Agricultural	(PI) Permanent inlet	Sl. Silt	F Floating vegetation
B.M. Bench Mark	(PO) Permanent outlet	Gr. Gravel	R Rubble
(D) Dwelling	(D) Dam	R. Rubble	BS Brush shelters
(R) Resort	(D.R.R.) State owned land	Gc. Bedrock	
(C) Camp			

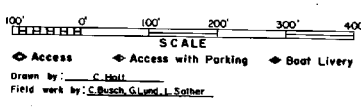

SPECIES OF FISH

SPECIES	1972	1973	1974	1975	1976	1977	1978	1979	1980
Muskie	X	X	X	X	X	X	X	X	X
N. Pike	X	X	X	X	X	X	X	X	X
Walleye	X	X	X	X	X	X	X	X	X
L. M. Bass	X	X	X	X	X	X	X	X	X
S. M. Bass	X	X	X	X	X	X	X	X	X
Panfish	X	X	X	X	X	X	X	X	X
Trout	X	X	X	X	X	X	X	X	X

WATER AREA 171 ACRES

UNDER 3 FT. 13.0 %  
OVER 20 FT. 8.0 %

MAX. DEPTH 23 FEET.

TOTAL ALK. 24 P.P.M.

VOLUME 131 ACRE FT.

MAIN SHORELINE 0.70 MI.  
ISLAND SHORELINE \_\_\_\_\_ MI.

Maps are not for navigation  
Source-Wisconsin Department of Natural Resources  
Hunt Fish Camp Wisconsin .Com 2005