

WISCONSIN CONSERVATION DEPARTMENT

LAKE SURVEY MAP

PLANTING GROUND
LAKE

ONEIDA
COUNTY

SEC. 19, 20, 29, 30 T. 39 N. R. 11 E.
31, 32

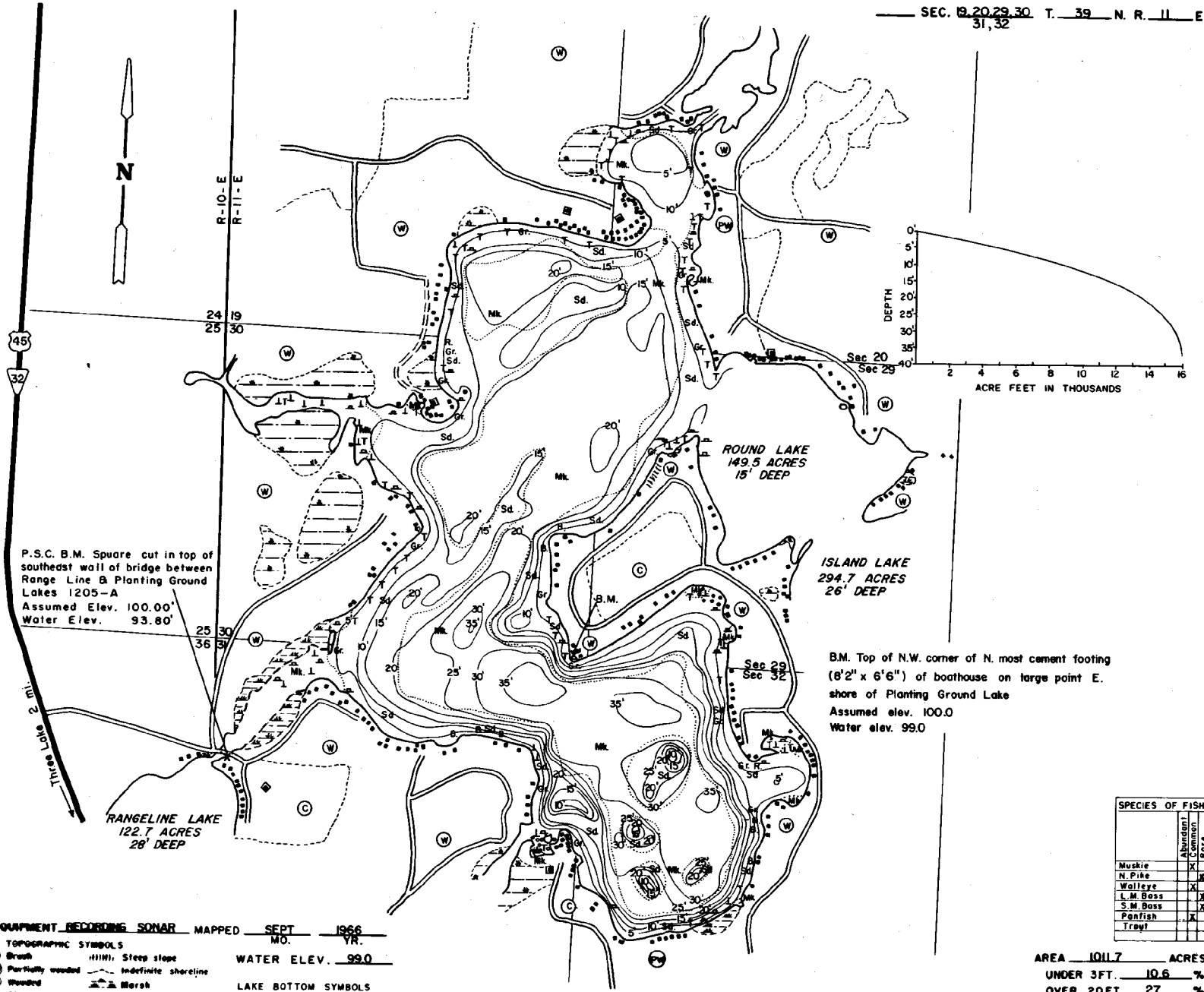

P.S.C. B.M. Square cut in top of southeast wall of bridge between Range Line & Planting Ground Lakes 1205-A
Assumed Elev. 100.00'
Water Elev. 93.60'

ROUND LAKE
149.5 ACRES
15' DEEP

ISLAND LAKE
294.7 ACRES
26' DEEP

RANGELINE LAKE
122.7 ACRES
28' DEEP

B.M. Top of N.W. corner of N. most cement footing (8'2" x 6'6") of boathouse on large point E. shore of Planting Ground Lake
Assumed elev. 100.0
Water elev. 99.0

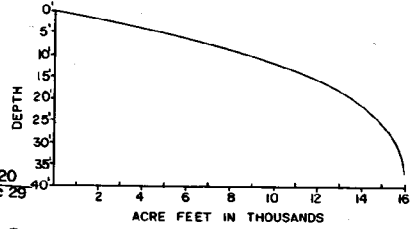

EQUIPMENT RECORDING SONAR MAPPED SEPT 1966

TOPOGRAPHIC SYMBOLS

- Brush
- Partially wooded
- Wooded
- Cleared
- Pastured
- Agricultural
- B.R. Birch Bark
- Swamp
- Hill
- Steep slope
- Marsh
- Spring
- Intermittent stream
- Permanent inlet
- Permanent outlet
- Indefinite shoreline
- LAKE BOTTOM SYMBOLS
- P. Peat
- Mk. Muck
- C. Clay
- M. Marl
- Gr. Gravel
- R. Rubble
- Br. Bedrock
- S. Stumps & Snags
- B. Boulders
- T. Submergent vegetation

WATER ELEV. 99.0



SPECIES OF FISH		Abundant	Common	Rare
Muskie		X		
N. Pike		X		
Walleye		X		
L.M. Bass		X		
S.M. Bass		X		
Panfish		X		
Treyf				

AREA 1011.7 ACRES
UNDER 3FT. 10.6 %
OVER 20FT. 27 %
VOLUME 15,983.2 ACRE FT.
TOTAL ALK. 28 P.P.M.
SHORELINE 10.5 MILES