

WISCONSIN CONSERVATION DEPARTMENT

LAKE SURVEY MAP

LAKE POLE LAKE  
SECTION 6  
TOWNSHIP 42  
RANGE 4 W  
TOWN \_\_\_\_\_  
COUNTY ASHLAND

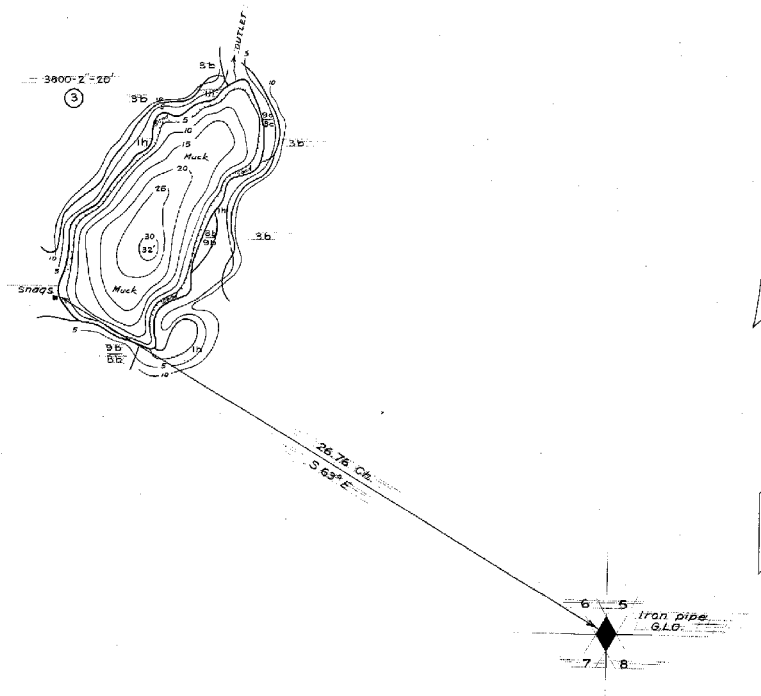

DATE March 15, 1938  
SOURCE OF INFORMATION \_\_\_\_\_  
U.S. Department of Agriculture  
Forest Service  
SOUNDINGS 5' intervals

AREA 10.5 Acres  
TOTAL SHORELINE .6 Miles  
MAX. DEPTH. 32 Feet  
SCALE: 16" = 1 Mile

Maps are not for navigation  
Source-Wisconsin Department of Natural Resources  
Hunt Fish Camp Wisconsin .Com 2005