

STATE OF WISCONSIN
DEPARTMENT OF NATURAL RESOURCES

LAKE SURVEY MAP

POPLAR LAKE
POLK COUNTY
SEC. 3.4 T. 33 N. R. 18 W.

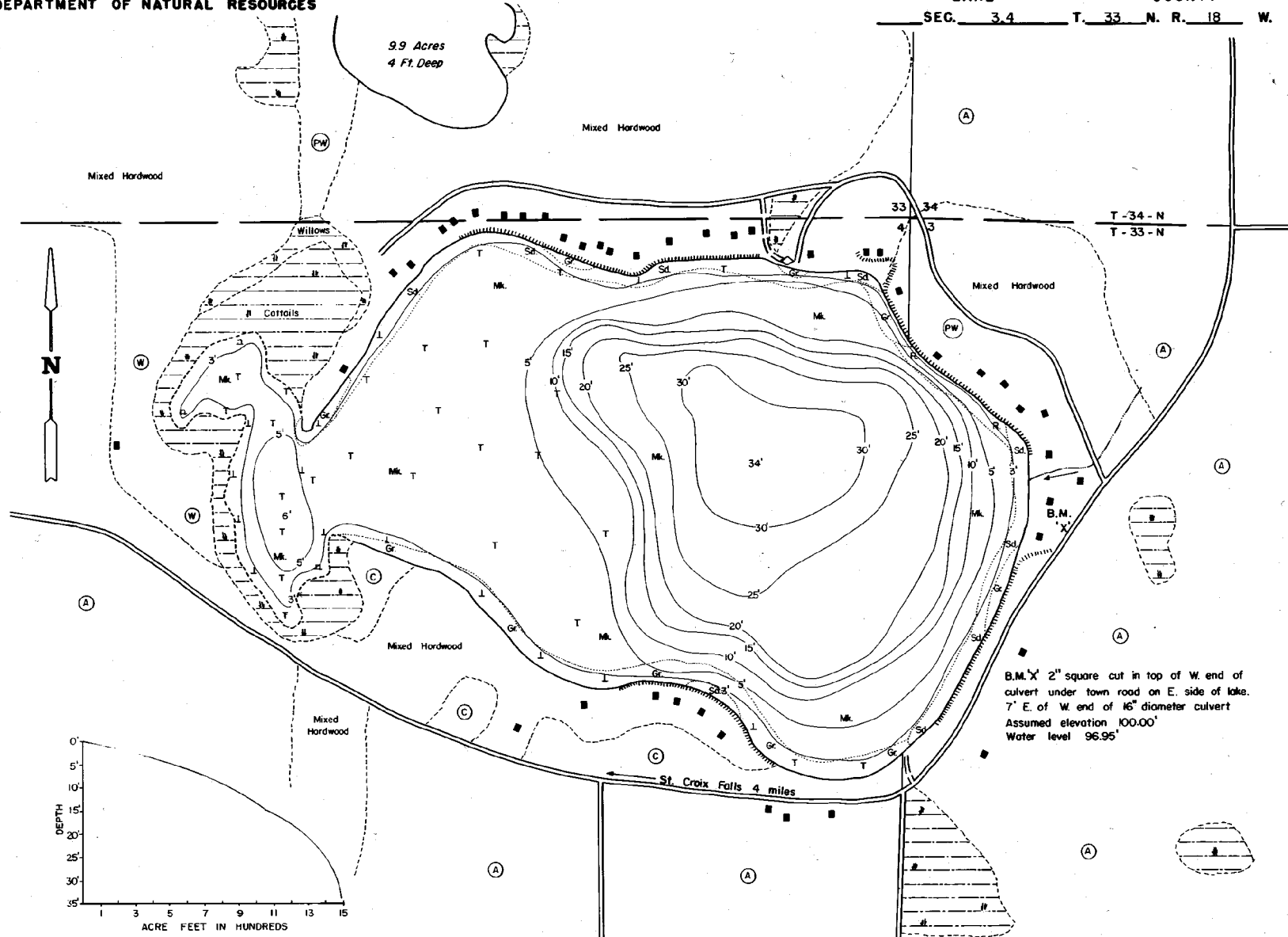

B.M. X 2" square cut in top of W. end of
culvert under town road on E. side of lake.
7' E. of W. end of 16" diameter culvert
Assumed elevation 100.00'
Water level 96.95'

EQUIPMENT RECORDING SONAR MAPPED AUG 1968

- | TOPOGRAPHIC SYMBOLS | | MONTH YEAR | | LAKE BOTTOM SYMBOLS | |
|-----------------------|-------------------------|------------|---------------------------|---------------------|--|
| (B) Brush | Steep slope | P. Peat | B Boulders | Stumps & Snags | |
| (PW) Partially wooded | — Indefinite shoreline | Mk. Muck | Rock danger to navigation | | |
| (M) Wooded | Marsh | C. Clay | Submergent vegetation | | |
| (C) Cleared | Spring | M. Marl | Emergent vegetation | | |
| (P) Pastured | Intermittent stream | Sd. Sand | Floating vegetation | | |
| (A) Agricultural | Permanent inlet | Sl. Silt | Brush shelters | | |
| B.M. (Black Mark) | Permanent outlet | Gr. Gravel | | | |
| □ Ditching | Dam | R. Rubble | | | |
| □ Resort | D.N.R. State owned land | Bc Bedrock | | | |
| □ Camp | | | | | |



Access Access with Parking Boat Livery

Drawn by: C. Holt

Field work by: C. Holt, S. Johnson, C. Holt

SPECIES OF FISH	ABUNDANCE		
	Abundant	Common	Rare
Bluegill			
H. Pike	X		
Walleye			
L. M. Bass	X		
S. M. Bass			
Panfish	X		
Trout			

WATER AREA 125.0 ACRES

UNDER 3 FT. 14 %

OVER 20 FT. 29 %

MAX. DEPTH 34 FEET.

TOTAL ALK. 39 P.P.M.

VOLUME 1485.9 ACRE FT.

SHORELINE 2.12 MILES