

STATE OF WISCONSIN  
DEPARTMENT OF NATURAL RESOURCES

LAKE SURVEY MAP

POTTER FLOWAGE LAKE      JACKSON COUNTY  
SEC. 16, 17, 20    T. 21 - N. R. 1 - W.  
(Sheet 2 of 3)

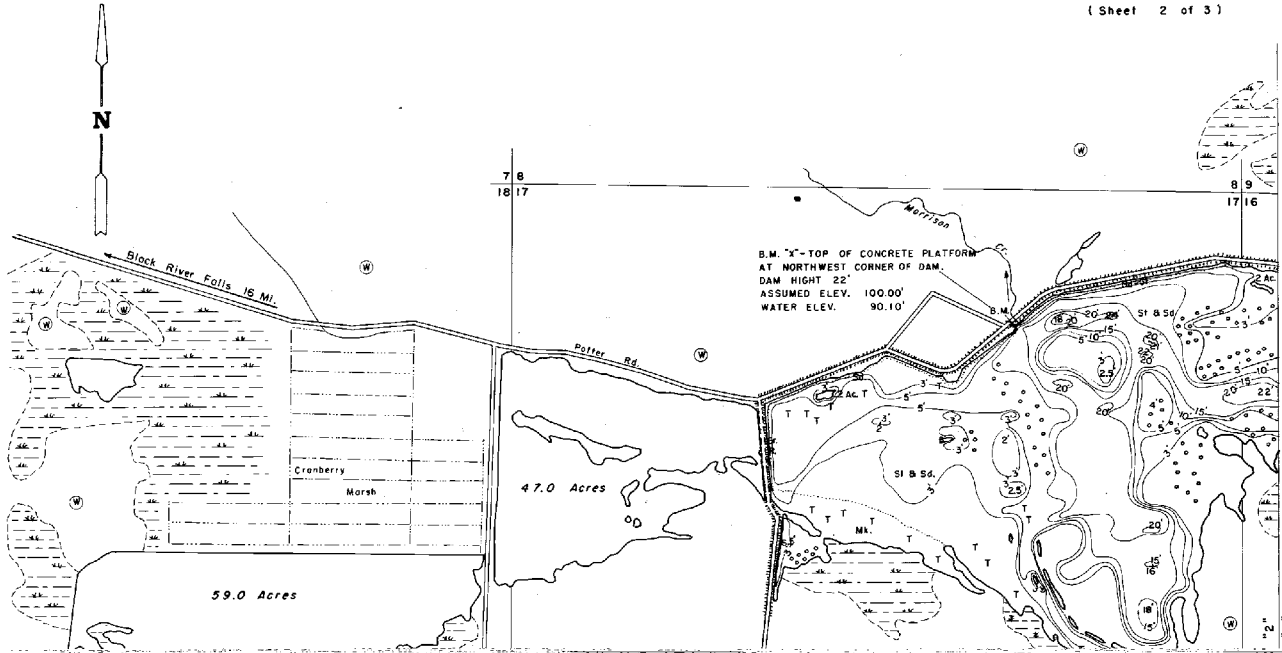

Maps are not for navigation  
Source-Wisconsin Department of Natural Resources  
Hunt Fish Camp Wisconsin .Com 2005