

STATE OF WISCONSIN
DEPARTMENT OF NATURAL RESOURCES

LAKE SURVEY MAP

PRICE LAKE
PRICE COUNTY
SEC. 19, 20 T. 38 N. R. 2 W.

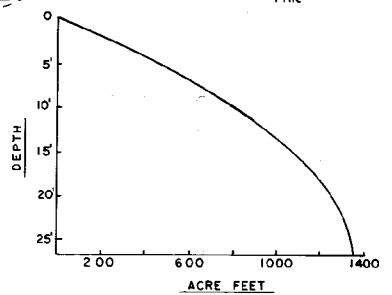
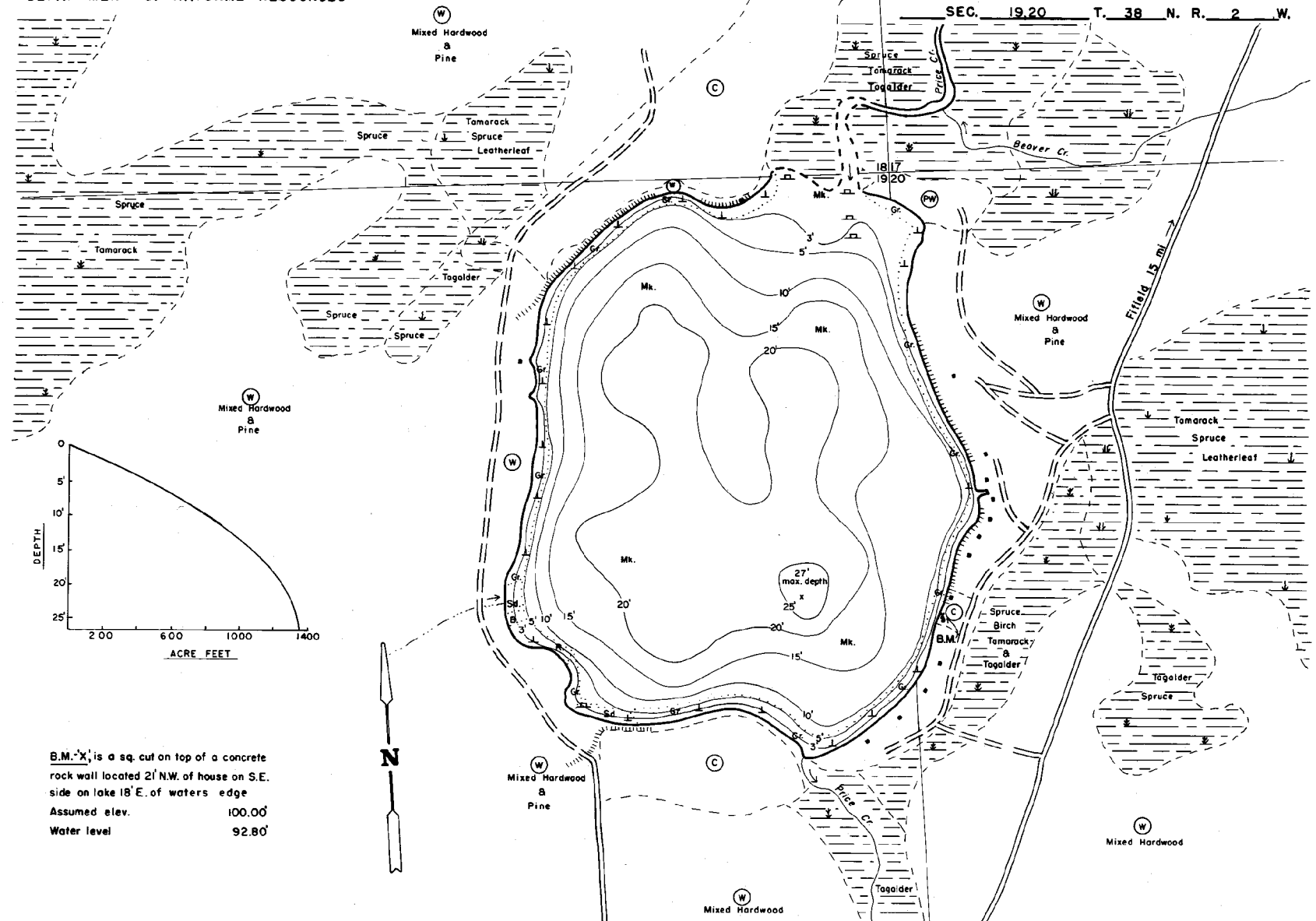

B.M. 'X' is a sq. cut on top of a concrete rock wall located 21' N.W. of house on S.E. side on lake 18' E. of waters edge
Assumed elev. 100.00'
Water level 92.80'

EQUIPMENT RECORDING		SONAR MAPPED		OCT 1969	
TOPOGRAPHIC SYMBOLS		MONTH		YEAR	
(B) Brush	() Steep slope	P. Peat	B. Boulders		
(W) Partly wooded	(---) Indefinite shoreline	Mk. Muck	(S) Stumps & Snags		
(W) Wooded	(M) Marsh	C. Clay	(R) Rock danger to navigation		
(C) Cleared	(S) Spring	M. Marl	(T) Submergent vegetation		
(P) Pastured	(---) Intermittent stream	Sd. Sand	(I) Emergent vegetation		
(A) Agricultural	(---) Permanent inlet	Sl. Silt	(F) Floating vegetation		
B.M. Bench Mark	(---) Permanent outlet	Gr. Gravel	(B) Brush shelters		
(D) Dwelling	(B) Dam	R. Rubble			
(R) Resort	(B.N.R.) State owned land	Bc. Bedrock			
(C) Camp					



Drawn by: T. Ginder
Field work by: C. Busch, G. Lund, & S. Johannes

SPECIES OF FISH	Abundance		
	Abundant	Common	Present
Muskie			X
N. Pike		X	
Walleye	X		
L. N. Bass		X	
S. N. Bass			X
Panfish	X		
Trout			

WATER AREA 91.8 ACRES
UNDER 3 FT. 8 %
OVER 20 FT. 28 %
MAX. DEPTH 27 FEET.
TOTAL ALK. 39 P.P.M.
VOLUME 1339.1 ACRE FT.
SHORELINE 1.50 MILES