

WISCONSIN CONSERVATION DEPARTMENT

LAKE SURVEY MAP

RANGELINE LAKE ONEIDA COUNTY  
 SEC. 36, 31 T. 39 N. R. 10, 11 E.

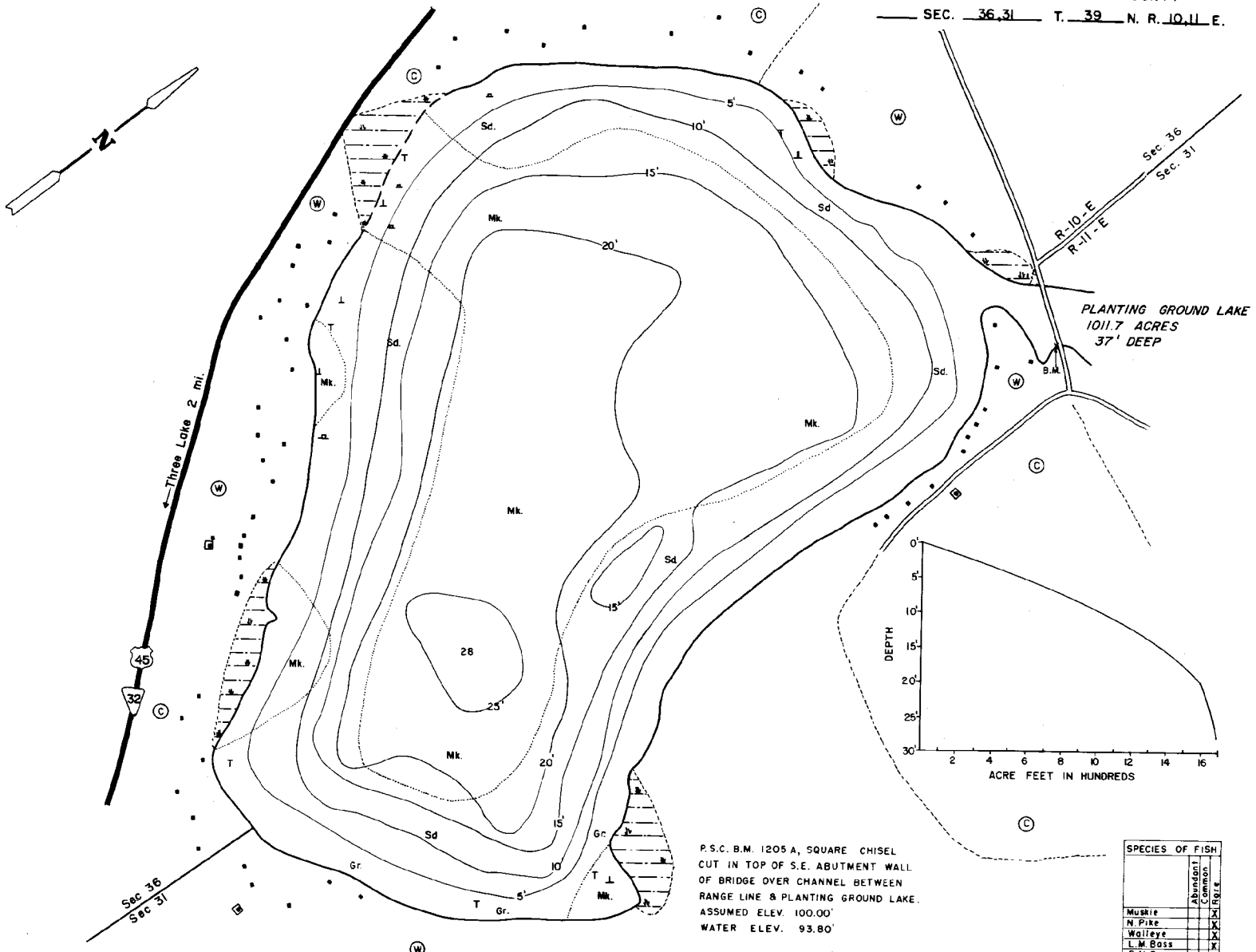

PLANTING GROUND LAKE  
 1011.7 ACRES  
 37' DEEP

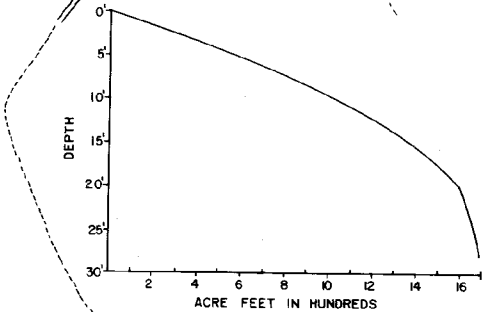

P.S.C. B.M. 1205 A, SQUARE CHISEL  
 CUT IN TOP OF S.E. ABUTMENT WALL  
 OF BRIDGE OVER CHANNEL BETWEEN  
 RANGE LINE & PLANTING GROUND LAKE.  
 ASSUMED ELEV. 100.00'  
 WATER ELEV. 93.80'

SPECIES OF FISH	Abundance	
	Common	Rare
Muskie		X
N Pike		X
Walleye		X
L.M. Bass		X
S.M. Bass		X
Panfish		X
Trout		

EQUIPMENT RECORDING SONAR MAPPED SEPT 1966  
 MO. YR.

- TOPOGRAPHIC SYMBOLS
- Brush
  - Partially wooded
  - Wooded
  - Cleared
  - Pastured
  - Agricultural
  - B.M. Bench Mark
  - Dwellings
  - Steep slope
  - Indefinite shoreline
  - Marsh
  - Spring
  - Intermittent stream
  - Permanent inlet
  - Permanent outlet
  - Dem.
- LAKE BOTTOM SYMBOLS
- P. Peat
  - C. Clay
  - M. Marl
  - Sd. Sand
  - Gr. Gravel
  - R. Rubble
  - Br. Bedrock
  - T. Submergent vegetation
  - Stumps & Snags

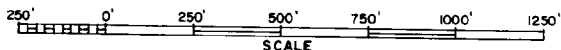

AREA 122.7 ACRES  
 UNDER 3FT. 11.7 %  
 OVER 20FT. 28 %  
 VOLUME 1696.5 ACRE FT.  
 TOTAL ALK. 30 P.P.M.  
 SHORELINE 1.8 MILES