

WISCONSIN CONSERVATION DEPARTMENT

LAKE SURVEY MAP

REDSTONE LAKE
 SAUK COUNTY
 SEC. 1, 2, 11, 12 T. -13- N. R. -3- E. #
 (Sheet 1 of 4)

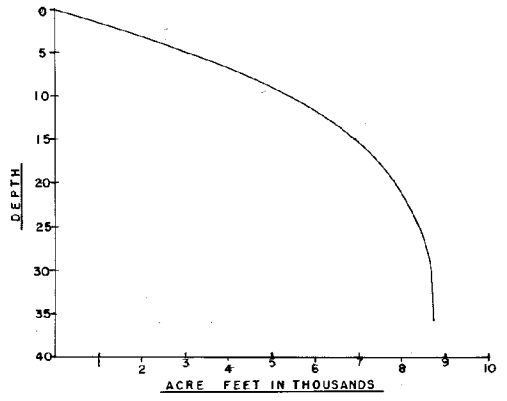
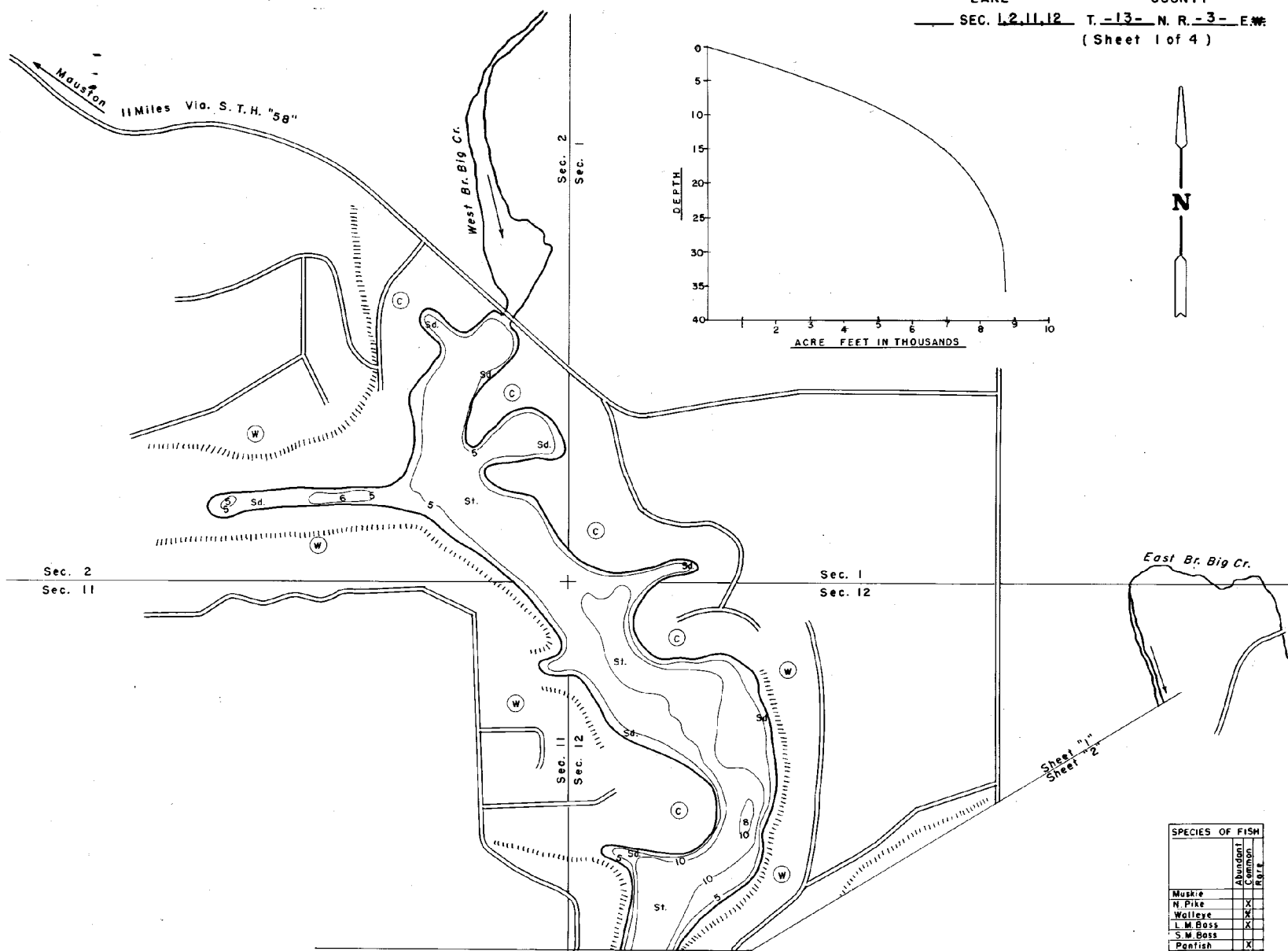

EQUIPMENT RECORDING SONAR MAPPED JUNE 1967
 MO. YR.

- TOPOGRAPHIC SYMBOLS**
- ⊙ Brush
 - ⊙ Partially wooded
 - ⊙ Wooded
 - ⊙ Cleared
 - ⊙ Pastured
 - ⊙ Agricultural
 - ⊙ B.M. Bench Mark
 - ⊙ Dwelling
 - ⊙ Resort
 - ⊙ Steep slope
 - ⊙ Indefinite shoreline
 - ⊙ Marsh
 - ⊙ Spring
 - ⊙ Intermittent stream
 - ⊙ Permanent inlet
 - ⊙ Permanent outlet
 - ⊙ Dam

- LAKE BOTTOM SYMBOLS**
- P. Peat
 - Mk. Muck
 - C. Clay
 - N. Marl
 - Sd. Sand
 - St. Silt
 - Gr. Gravel
 - R. Rubble
 - Br. Bedrock
 - T. Submergent vegetation
 - ⊙ Emergent vegetation
 - ⊙ Floating vegetation
 - ⊙ Stumps & Snags

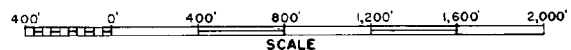

◇ Access ◀ Access with Parking ◆ Boat Livery
 Field work by H. Schwenn, R. Spielman Drawn by E. Epton

SPECIES OF FISH	
	Abundant & Common
Muskie	
N. Pike	X
Walleye	X
L. M. Bass	X
S. W. Bass	
Panfish	X
Trout	
Bullheads	X

AREA 612.1 ACRES
 UNDER 3FT. 7 %
 OVER 20FT. 24 %
 VOLUME 8,715.7 ACRE FT.
 TOTAL ALK. 128 P.P.M.
 SHORELINE 16.4 MILES
 MAX. DEPTH 36 FEET