

STATE OF WISCONSIN
DEPARTMENT OF NATURAL RESOURCES

LAKE SURVEY MAP

RICE LAKE POLK COUNTY
SEC. 11, 12 T. 32 N. R. 18 W.

B.M. 'X' is a sq. cut on top of a 2' x 3' boulder located 150' south of point on south side of lake, 20' west of centerline of trail, and 8' east of waters edge.
Assumed elevation = 100.00'
Water level = 95.96'
Taken 11/5/69

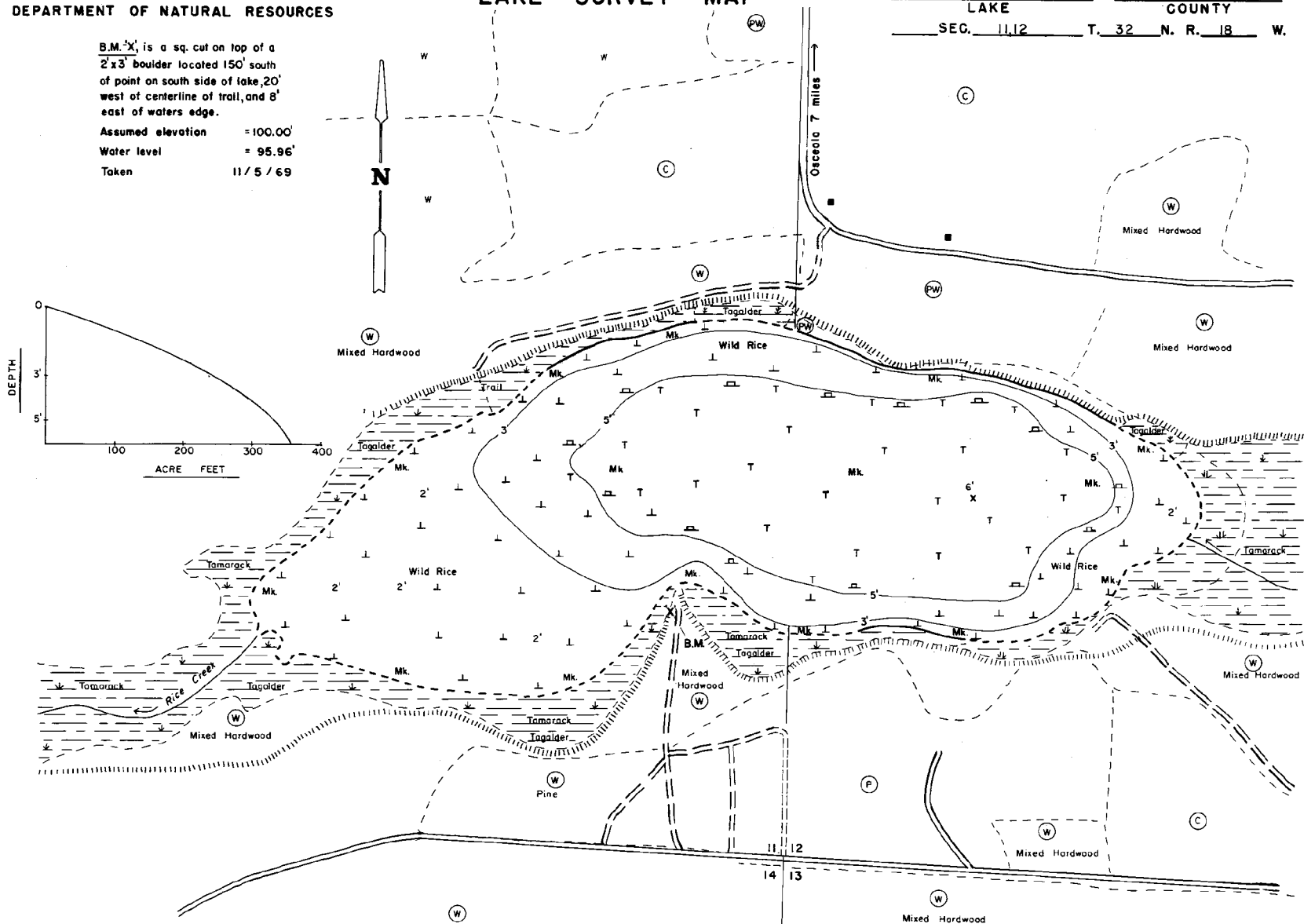
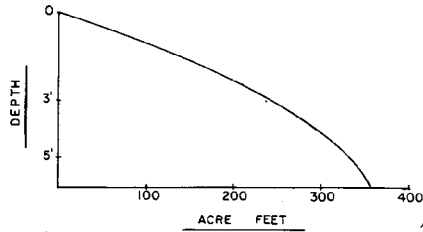

EQUIPMENT RECORDING SONAR MAPPED NOV. 1969
MONTH YEAR

- | TOPOGRAPHIC SYMBOLS | | LAKE BOTTOM SYMBOLS | |
|-----------------------|----------------------------|---------------------|-----------------------------|
| (B) Brush | Steep slope | P. Peat | B Boulders |
| (PW) Partially wooded | - - - Indefinite shoreline | Mk. Muck | ⚡ Stumps & Snags |
| (W) Wooded | Marsh | C. Clay | ⚡ Rock danger to navigation |
| (C) Cleared | o Spring | M. Marl | T Submergent vegetation |
| (P) Pastured | ~ Intermittent stream | Sd. Sand | ⬇ Emergent vegetation |
| (A) Agricultural | == Permanent inlet | St. Silt | ⬇ Floating vegetation |
| B.M. Bench Mark | == Permanent outlet | Gr. Gravel | ⬇ Brush shelters |
| ■ Dwelling | ⬇ Dam | R. Rubble | |
| ■ Resort | D.N.R. State owned land | Br. Bedrock | |
| ■ Camp | | | |



◆ Access ◆ Access with Parking ◆ Boat Livery
Drawn by: T. Ginder
Field work by: C. Busch, G. Lund, S. Johannes

SPECIES OF FISH	ABUNDANT		PRESENT	
	Common	Abundant	Common	Present
Muskie				
N Pike			X	
Walleye				
L.M. Bass			X	
S.M. Bass				
Panfish			X	
Trout				

WATER AREA 97.9 ACRES
UNDER 3 FT. 37 %
OVER 20 FT. 0 %
MAX. DEPTH 6 FEET
TOTAL ALK. 79 P.P.M.
VOLUME 357.8 ACRE FT.
SHORELINE 1.85 MILES