

STATE OF WISCONSIN  
DEPARTMENT OF NATURAL RESOURCES

LAKE SURVEY MAP

ROUND LAKE  
POLK COUNTY  
SEC. 26 T. 33 N. R. 18 W.

B.M. 'X' 1563-A  
IS A 2" + cut in Round Lake side  
of N. culvert under C.T.H. 'Y', 15' E. of  
centerline of C.T.H. 'Y'  
Assumed elevation 100.00'  
Water level 98.33'

Horse Lake  
2276 Acres  
11' Max. Depth

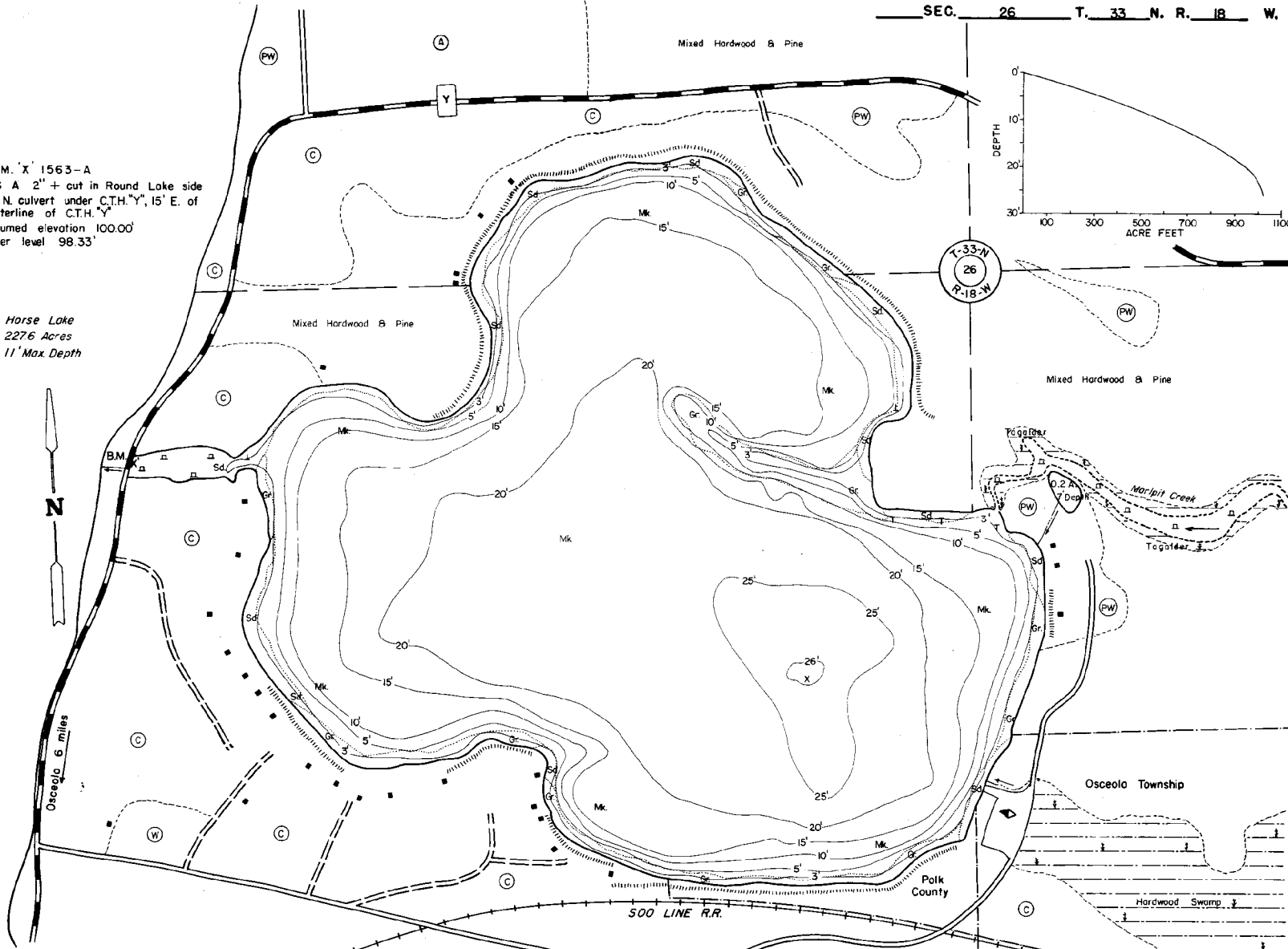

EQUIPMENT RECORDING SONAR MAPPED JUNE 1969

- | TOPOGRAPHIC SYMBOLS   |                           | LAKE BOTTOM SYMBOLS |                             |
|-----------------------|---------------------------|---------------------|-----------------------------|
| (B) Brush             | Steep slope               | P. Peat             | B Boulders                  |
| (PW) Partially wooded | ~ Indefinite shoreline    | Mk. Muck            | ☼ Stumps & Snags            |
| (W) Wooded            | ~ Marsh                   | C. Clay             | ⚠ Rock danger to navigation |
| (C) Cleared           | ~ Spring                  | M. Marl             | T Submergent vegetation     |
| (P) Pastured          | ~ Intermittent stream     | Sd. Sand            | J Emergent vegetation       |
| (A) Agricultural      | ~ Permanent inlet         | Sl. Silt            | △ Floating vegetation       |
| B.M. Bench Mark       | ~ Permanent outlet        | Gr. Gravel          | ⚡ Brush shelters            |
| ■ Dwelling            | ~ Dam                     | R. Rubble           |                             |
| ■ Resort              | ~ D.N.R. State owned land | Bc Bedrock          |                             |
| ■ Camp                |                           |                     |                             |



Access Access with Parking Boat Livery  
Drawn by: C. Holt  
Field work by: C. Busch, S. Johannes

SPECIES OF FISH	Abundance		
	Uncommon	Common	Present
Muskie			
N. Pike	X		
Walleye	X		
L. M. Bass	X		
S. M. Bass	X		
Panfish	X		
Trout			

WATER AREA 671 ACRES  
UNDER 3 FT. 76 %  
OVER 20 FT. 391 %  
MAX. DEPTH 26 FEET.  
TOTAL ALK. 110 P.P.M.  
VOLUME 1025.6 ACRE FT.  
SHORELINE 158 MILES