

STATE OF WISCONSIN
DEPARTMENT OF NATURAL RESOURCES

LAKE SURVEY MAP

SAND LAKE POLK COUNTY
SEC. 2 T. 33 N. R. 18 W.

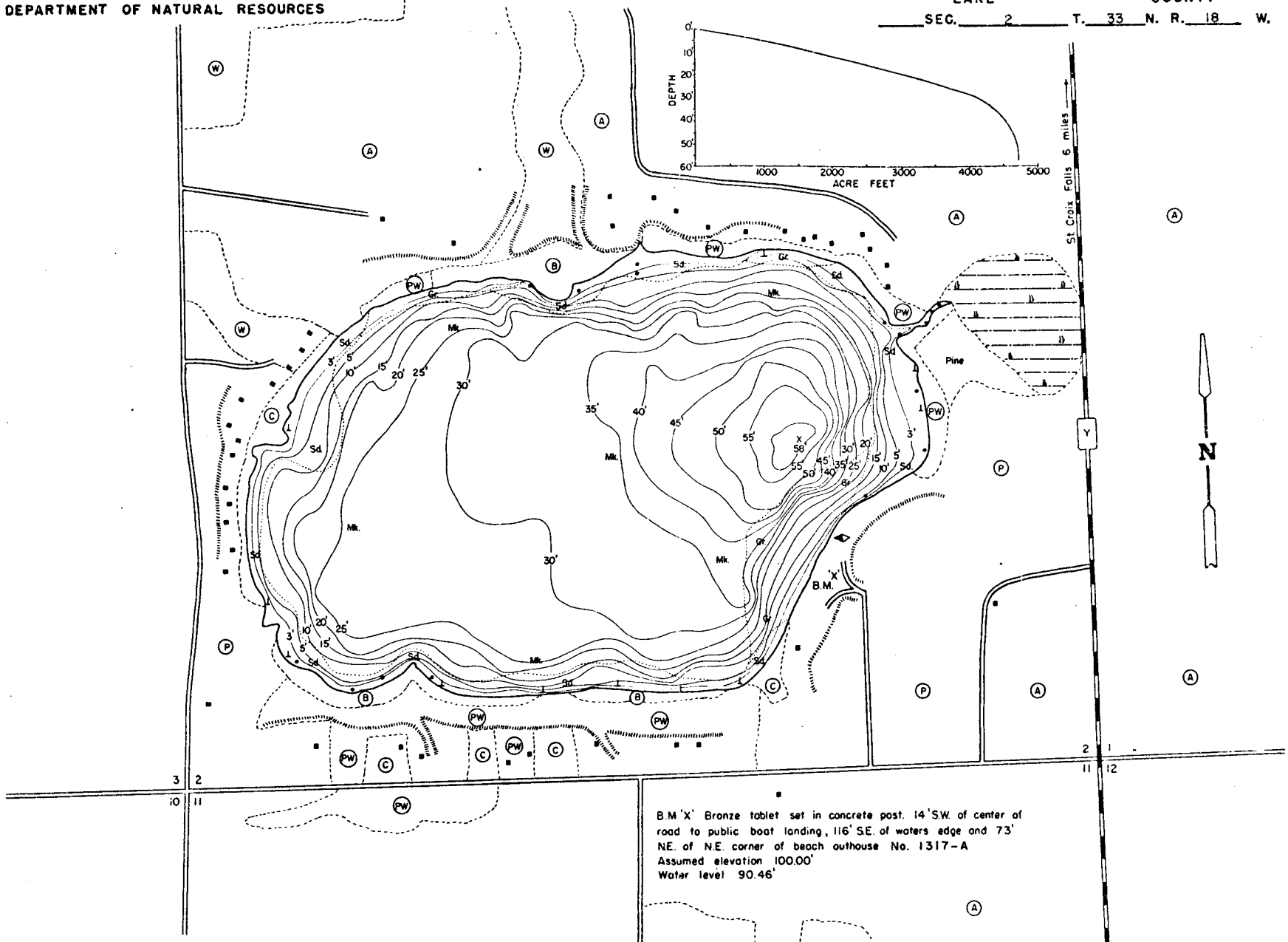

B.M. 'X' Bronze tablet set in concrete post. 14' SW. of center of road to public boat landing, 116' SE. of waters edge and 73' NE. of NE corner of beach outhouse No. 1317-A
Assumed elevation 100.00'
Water level 90.46'

EQUIPMENT RECORDING SONAR MAPPED OCT 1968

- TOPOGRAPHIC SYMBOLS**
- (B) Brush
 - (PW) Partially wooded
 - (W) Wooded
 - (C) Cleared
 - (P) Pastured
 - (A) Agricultural
 - B.M. Bench Mark
 - Dwelling
 - ▬ Sleep slope
 - Indefinite shoreline
 - ▬ Marsh
 - Spring
 - ▬ Intermittent stream
 - ▬ Permanent inlet
 - ▬ Permanent outlet
 - ▬ Dam

- LAKE BOTTOM SYMBOLS**
- P. Peat
 - Mk. Muck
 - C. Clay
 - M. Marl
 - Sd. Sand
 - St. Silt
 - Gr. Gravel
 - R. Rubble
 - B Boulders
 - ⊕ Stumps & Snags
 - ⊗ Rock danger to navigation
 - T Submergent vegetation
 - ⊥ Emergent vegetation
 - ⬆ Floating vegetation
 - ⬇ Brush shelters



Access Access with Parking Boat Livery

Drawn by: C. Holt

SPECIES OF FISH	ABUNDANCE		
	Abundant	Common	Present
Muskie			
N. Pike			
Walleye	X		
L. M. Bass			X
S. M. Bass			X
Pontfish	X		

WATER AREA 1870 ACRES
 UNDER 3 FT. 7 %
 OVER 20 FT. 66 %
 MAX. DEPTH 58 FEET.
 TOTAL ALK. 54 P.P.M.
 VOLUME 4721.8 ACRE FT.
 SHORELINE 2.61 MILES