

STATE OF WISCONSIN
DEPARTMENT OF NATURAL RESOURCES

LAKE SURVEY MAP

SAND LAKE SAWYER COUNTY
SEC. 16,17,20,21 T. 39 N. R. 9 W.

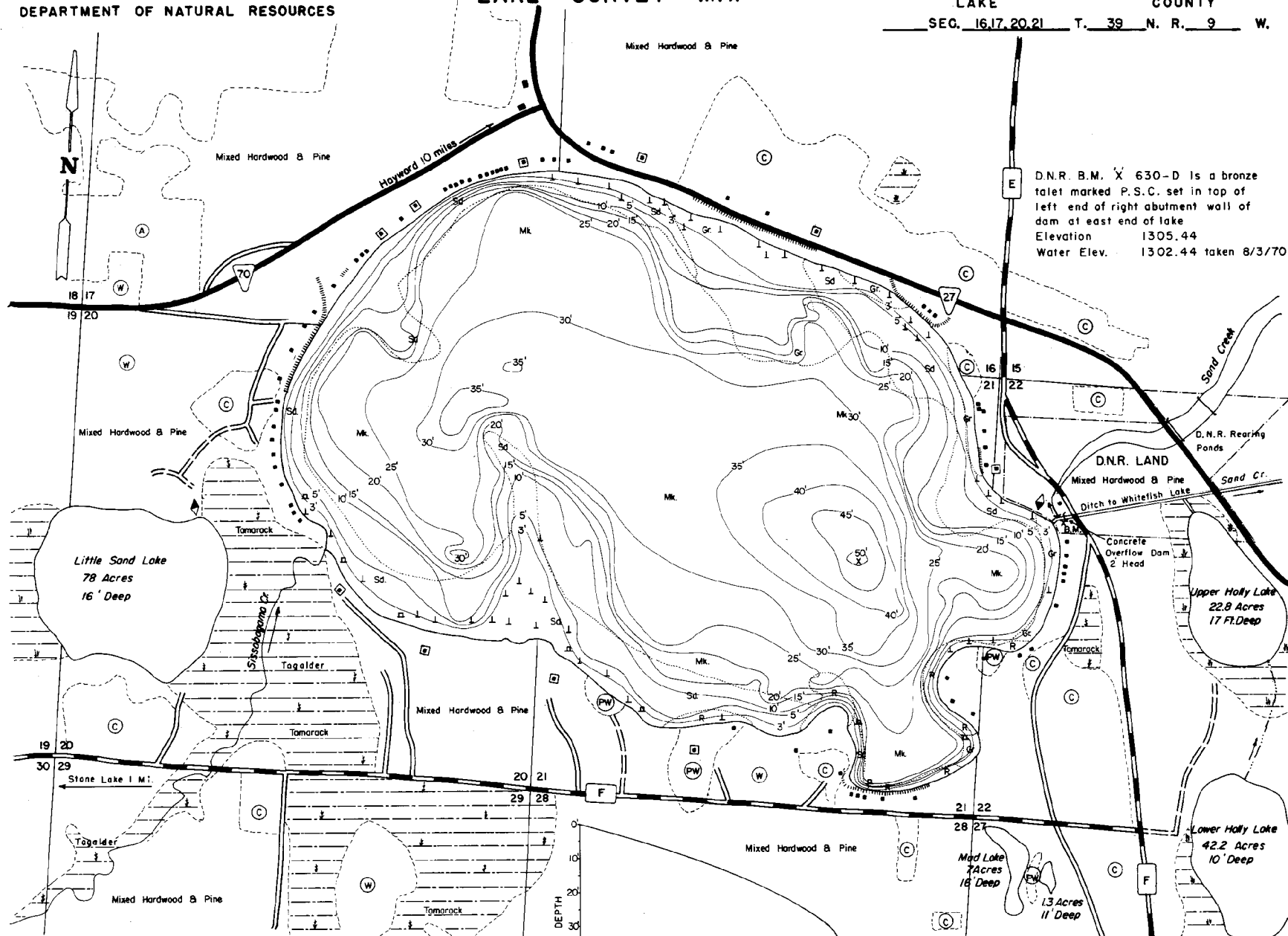

D.N.R. B.M. X 630-D is a bronze tablet marked P.S.C. set in top of left end of right abutment wall of dam at east end of lake
Elevation 1305.44
Water Elev. 1302.44 taken 8/3/70

EQUIPMENT RECORDING SONAR MAPPED MONTH YEAR
AUG 1970

- | TOPOGRAPHIC SYMBOLS | | LAKE BOTTOM SYMBOLS | |
|-----------------------|----------------------------|---------------------|-----------------------------|
| (B) Brush | Steep slope | P. Peat | B Boulders |
| (PW) Partially wooded | - - - Indefinite shoreline | Mk. Muck | ☼ Stumps & Snags |
| (W) Wooded | ▨ Marsh | C. Clay | ⊛ Rock danger to navigation |
| (C) Cleared | ○ Spring | M. Marl | T Submergent vegetation |
| (P) Pastured | ~ Intermittent stream | Sd. Sand | ⊥ Emergent vegetation |
| (A) Agricultural | ≡ Permanent inlet | St. Silt | △ Floating vegetation |
| B.M. Bench Mark | ≡ Permanent outlet | Gr. Gravel | ⬇ Brush shelters |
| ■ Dwelling | ▬ Dam | R. Rubble | |

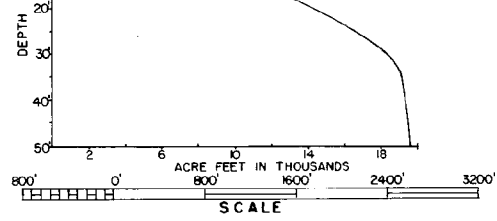

Access Access with Parking Boat Livery
Drawn by: C.Holt

SPECIES OF FISH	ABUNDANCE	
	Abundant	Present
Muskie		X
N. Pike		X
Walleye	X	
L. M. Bass		X
S. M. Bass		X
Panfish	X	
Trout		

WATER AREA 9280 ACRES
UNDER 3 FT. 8 %
OVER 20 FT. 58 %
MAX. DEPTH 50 FEET.
TOTAL ALK. 34 P.P.M.
VOLUME 19,561 ACRE FT.
SHORELINE 5.08 MILES