

STATE OF WISCONSIN  
DEPARTMENT OF NATURAL RESOURCES

LAKE SURVEY MAP

SHANNON LAKE  
VILAS COUNTY  
SEC. 12 T. 40 - N. R. 8 - E.

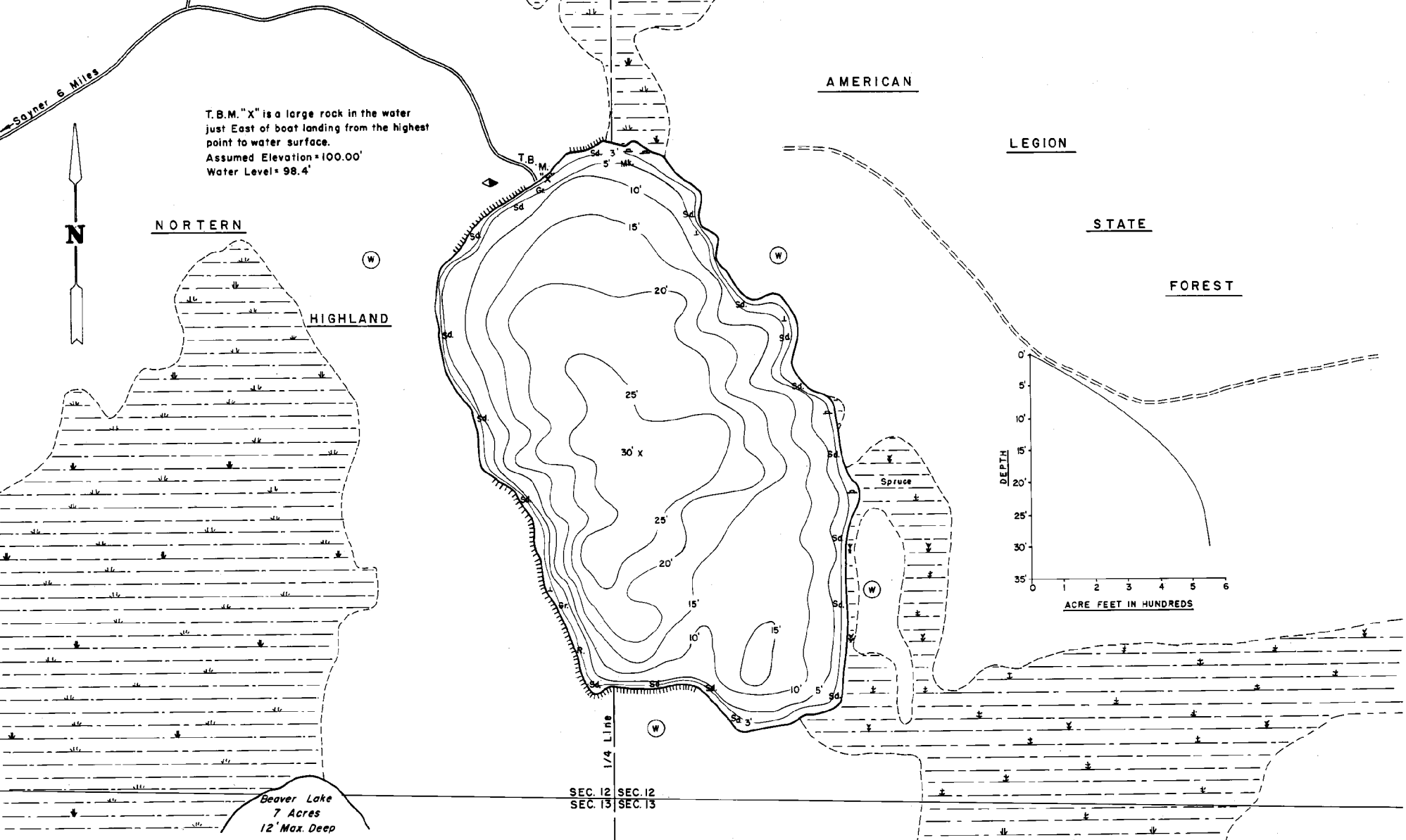

T.B.M. "X" is a large rock in the water just East of boat landing from the highest point to water surface.  
Assumed Elevation = 100.00'  
Water Level = 98.4'

AMERICAN LEGION

STATE FOREST

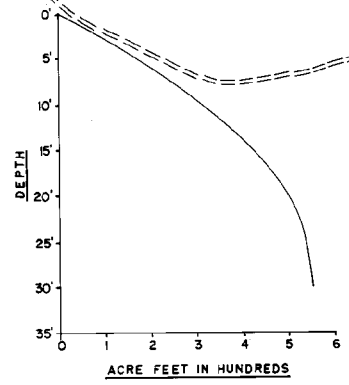

SEC. 12 SEC. 12  
SEC. 13 SEC. 13

1/4 Line

Beaver Lake  
7 Acres  
12' Max. Deep

- EQUIPMENT RECORDING SONAR MAPPED JULY 1975
- | TOPOGRAPHIC SYMBOLS  |                            | LAKE BOTTOM SYMBOLS |                             |
|----------------------|----------------------------|---------------------|-----------------------------|
| (B) Brush            | Steep slope                | P. Peat             | B Boulders                  |
| (W) Partially wooded | ----- Indefinite shoreline | Mk. Muck            | ☼ Stumps & Snags            |
| (W) Wooded           | ----- Marsh                | C. Clay             | ☼ Rock danger to navigation |
| (C) Cleared          | ----- Spring               | M. Marl             | T Submergent vegetation     |
| (P) Pastored         | ----- Intermittent stream  | Sd. Sand            | ↓ Emergent vegetation       |
| (A) Agricultural     | ----- Permanent inlet      | Sl. Silt            | ▲ Floating vegetation       |
| B.M. Bench Mark      | ----- Permanent outlet     | Gr. Gravel          | ☼ Brush shelters            |
| ● Dwelling           | ----- Dam                  | R. Rubble           |                             |

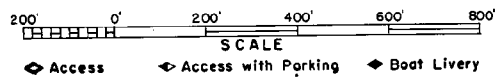

SPECIES OF FISH	ABUNDANT		PRESENT
	ABUNDANT	PRESENT	
Muskie			
N. Pike			
Walleye			
L.M. Bass			X
S.M. Bass			
Panfish	X		

WATER AREA 36.3 ACRES  
 UNDER 3 FT. 5.6 %  
 OVER 20 FT. 30.27 %  
 MAX. DEPTH 30 FEET.  
 TOTAL ALK. 2 P.P.M.  
 VOLUME 547.85 ACRE FT.  
 MAIN SHORELINE 1.00 MI.