

STATE OF WISCONSIN
DEPARTMENT OF NATURAL RESOURCES

LAKE SURVEY MAP

SOUTH TWO LAKE ONEIDA COUNTY
SEC. 15, 16, 21, 22 T. 38 N. R. 7 E.

North Two Lake
146.2 Acres
47 Ft. Deep

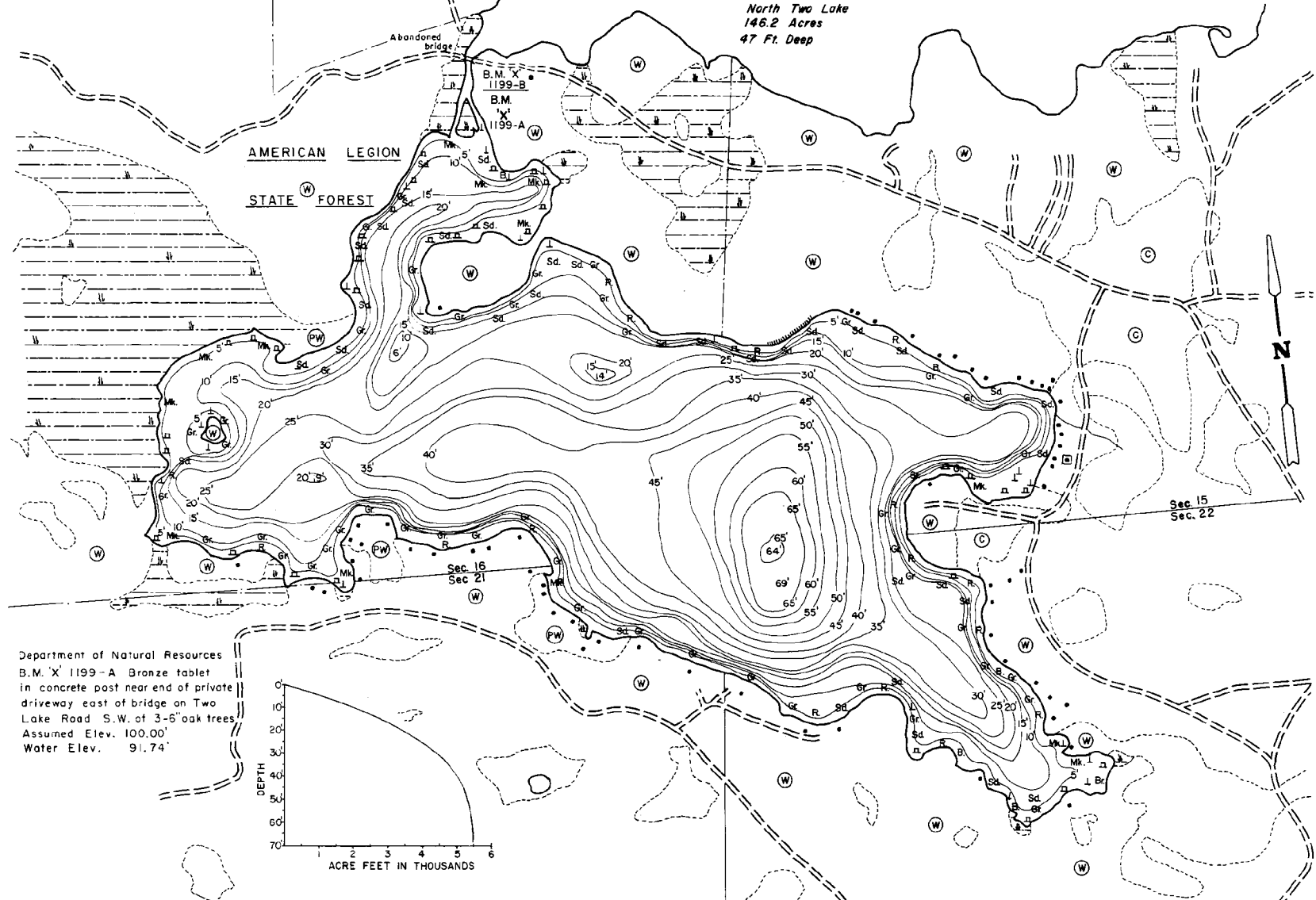

Department of Natural Resources
B.M. 'X' 1199-A Bronze tablet
in concrete post near end of private
driveway east of bridge on Two
Lake Road S.W. of 3-6" oak trees
Assumed Elev. 100.00'
Water Elev. 91.74'

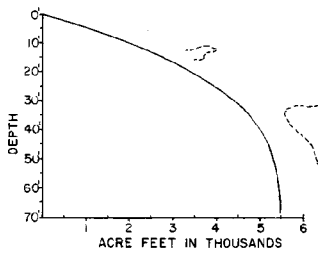

EQUIPMENT RECORDING SONAR MAPPED JUNE 1967
MONTH YEAR

- | TOPOGRAPHIC SYMBOLS | | LAKE BOTTOM SYMBOLS | |
|-----------------------|----------------------------|---------------------|-----------------------------|
| (B) Brush | Steep slope | P. Peat | B. Boulders |
| (PW) Partially wooded | - - - Indefinite shoreline | Mk. Muck | ☛ Stumps & Snags |
| (W) Wooded | Marsh | C. Clay | ☛ Rock danger to navigation |
| (C) Cleared | Spring | M. Marl | T. Submergent vegetation |
| (P) Pastured | Intermittent stream | Sd. Sand | ↓ Emergent vegetation |
| (A) Agricultural | Permanent inlet | Sl. Silt | ▲ Floating vegetation |
| B.M. Bench Mark | Permanent outlet | Gr. Gravel | ☛ Brush shelters |
| ■ Dwelling | Dam | R. Rubble | |
| ■ Resort | D.N.R. State owned land | Bc. Bedrock | |
| ■ Camp | | | |



Access Access with Parking Boat Livery
Drawn by: C. Holt
Field work by: P. Michelson, J. Smith

SPECIES OF FISH	ABUNDANCE		
	Abundant	Common	Present
Muskie			X
N. Pike			X
Walleye	X		
L. N. Bass	X		
S. M. Bass	X		
Panfish	X		
Trout			

WATER AREA 213.7 ACRES
UNDER 3 FT. 70 %
OVER 20 FT. 61.0 %
MAX. DEPTH 69 FEET.
TOTAL ALK. 17 P.P.M.
VOLUME 5497.9 ACRE FT.
SHORELINE 4.4 MILES
SHORELINE 4.3 MILES WITHOUT ISLAND