

STATE OF WISCONSIN
DEPARTMENT OF NATURAL RESOURCES

Department of Natural Resources Bench Mark 610-C.
Bronze tablet marked "Railroad Commission of Wisconsin"
set in top of 6" concrete post located 69' southwest of
48" pine tree, 54' west of 36" pine tree, 52' from
water's edge, and 69.7' east of east edge of dam.
Elevation 91.55'
Water Elevation 82.51' (May 27, 1969)

LAKE SURVEY MAP

SPIDER
LAKE

SAWYER
COUNTY

SEC. 14, 15, 22, 23, 24, 26 T. 42 - N. R. - 7 - W.
27, 28, 33, 34 Sheet 1 of 2 Sheets

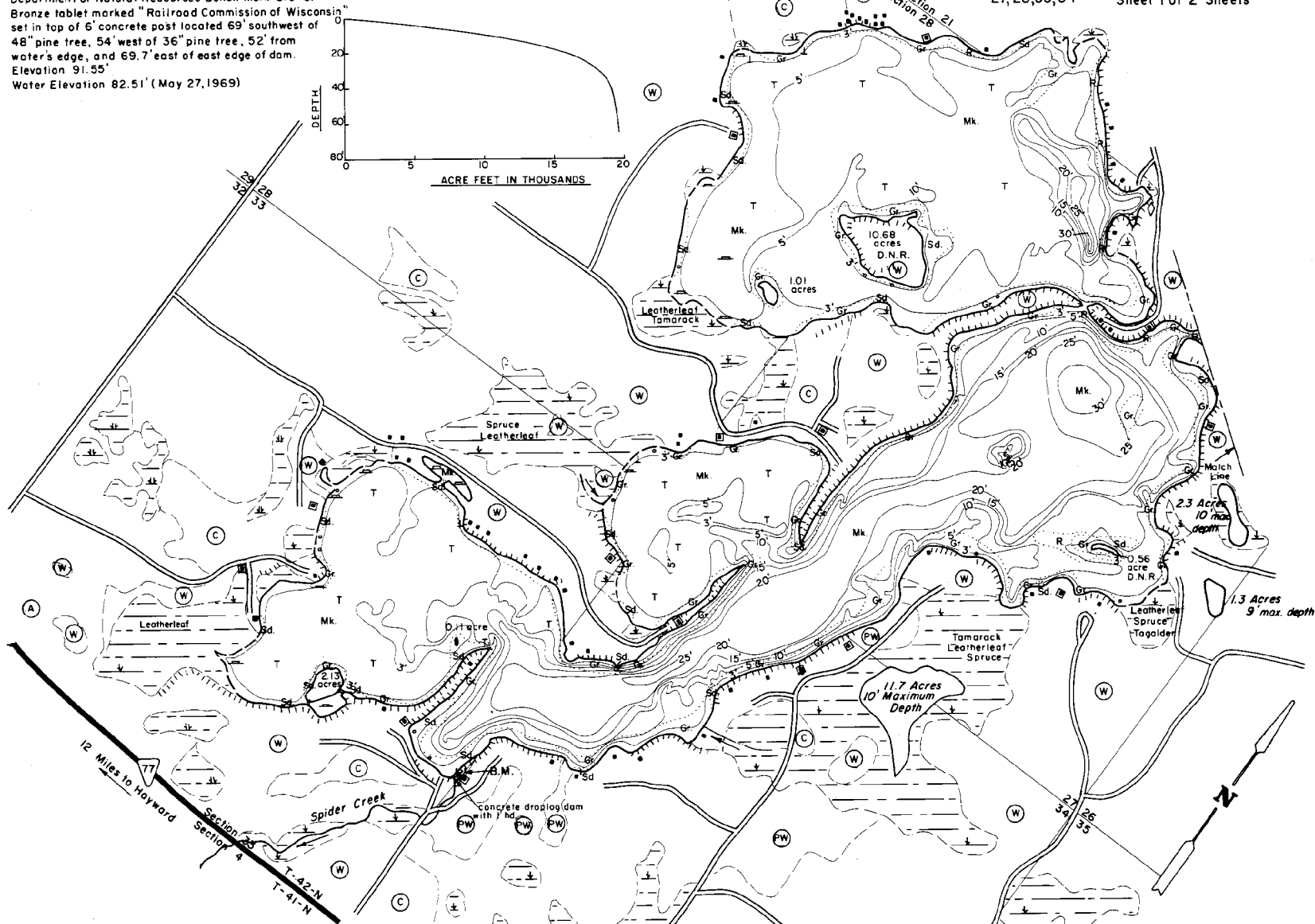

EQUIPMENT RECORDING SONAR MAPPED MAY 1969

TOPOGRAPHIC SYMBOLS		LAKE BOTTOM SYMBOLS	
(B) Brush	Steep slope	P. Peat	B. Boulders
(PW) Partly wooded	~ Indefinite shoreline	Mk. Muck	⚡ Stumps & Snags
(W) Wooded	~ Marsh	C. Clay	⚡ Rock danger to navigation
(C) Cleared	~ Spring	M. Marl	T. Submergent vegetation
(P) Pastured	~ Intermittent stream	Sd. Sand	J. Emergent vegetation
(A) Agricultural	~ Permanent inlet	Sl. Silt	F. Floating vegetation
B.M. Bench Mark	~ Permanent outlet	Gr. Gravel	⚡ Brush shelters
■ Dwelling	~ Dam	R. Rubble	
■ Resort	~ D.N.R. State owned land	Bc. Bedrock	



Drawn by: J. Roth
Field work by: C. Busch, C. Beller, S. Johannes

SPECIES OF FISH	STATUS	
	ABUNDANT	COMMON
Muskie	X	
N. Pike	X	
Walleye	X	
L.M. Bass	X	
S.M. Bass	X	
Panfish	X	
Traut		

WATER AREA	1,454.3	ACRES
UNDER 3 FT.	9	%
OVER 20 FT.	26	%
MAX. DEPTH	64	FEET.
TOTAL ALK.	59	P.P.M.
VOLUME	19,620.4	ACRE FT.
SHORELINE	20.75	MILES
18.35 MILES OF SHORELINE EXCLUDING ISLANDS		