

STATE OF WISCONSIN
DEPARTMENT OF NATURAL RESOURCES

LAKE SURVEY MAP

SPIRIT LAKE ONEIDA COUNTY
SEC. 4, 5, 8, 9 T. 38 N. R. 11 E.

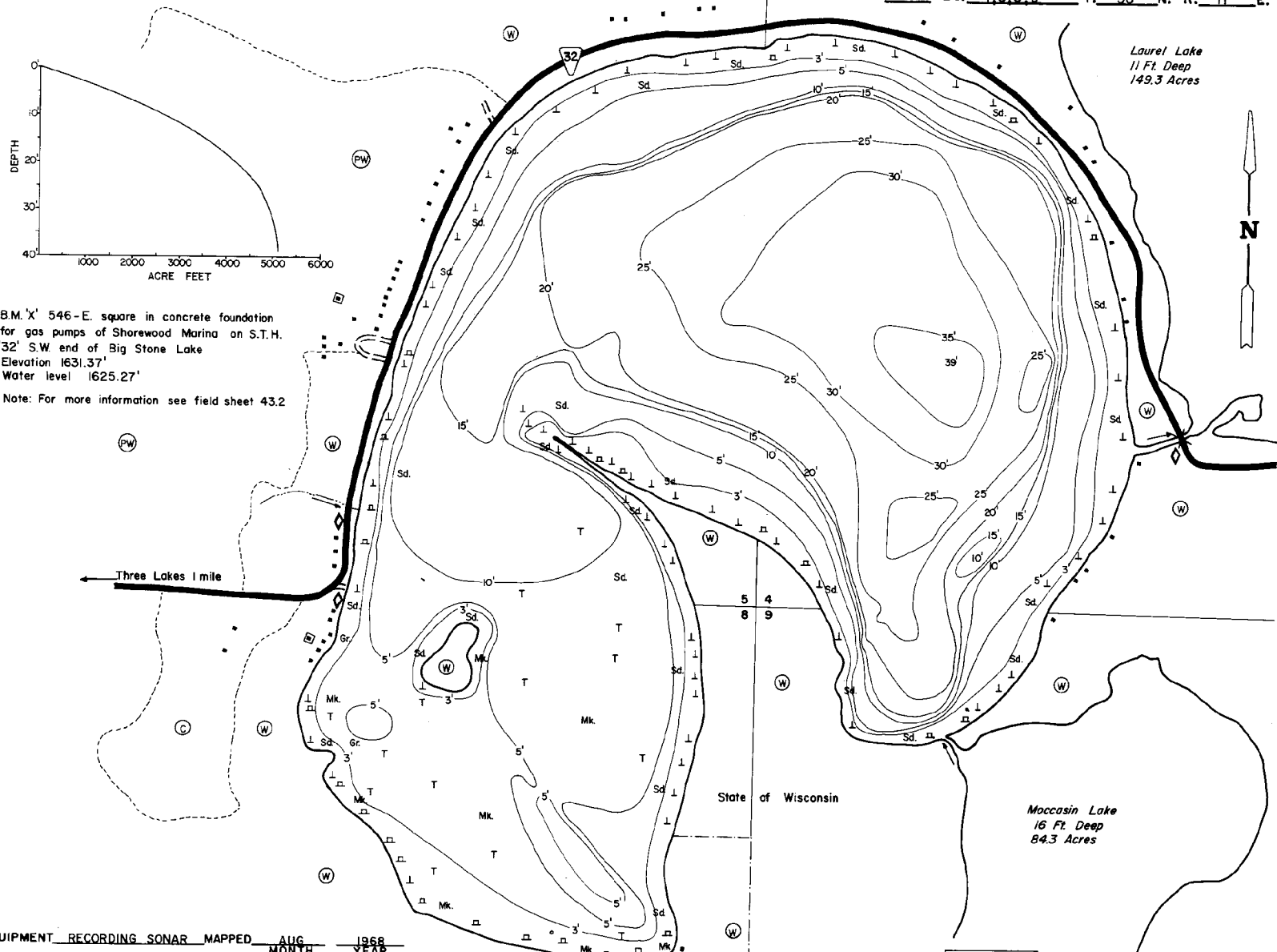

B.M. 'X' 546-E. square in concrete foundation for gas pumps of Shorewood Marina on S.T.H. '32' S.W. end of Big Stone Lake
Elevation 1631.37'
Water level 1625.27'
Note: For more information see field sheet 43.2

EQUIPMENT RECORDED SONAR MAPPED AUG 1968

TOPOGRAPHIC SYMBOLS		LAKE BOTTOM SYMBOLS
(B) Brush	() Steep slope	P. Peat
(PW) Partially wooded	(---) Indefinite shoreline	Mk. Muck
(W) Wooded	(---) Marsh	C. Clay
(C) Cleared	(---) Spring	M. Marl
(P) Pastured	(---) Intermittent stream	Sd. Sand
(A) Agricultural	(---) Permanent inlet	St. Silt
B.M. Bench Mark	(---) Permanent outlet	Gr. Gravel
(D) Dwelling	(---) Dam	R. Rubble
(R) Resort	(---) D.N.R. State owned land	Bc. Bedrock
		B. Boulders
		S. Stumps & Snags
		R. Rock danger to navigation
		T. Submergent vegetation
		E. Emergent vegetation
		F. Floating vegetation
		Bs. Brush shelters

400' 0' 400' 800' 1200' 1600'
SCALE
Access Access with Parking Boat Livery

Drawn by: C. Holt
Field work by: B. Michalek

SPECIES OF FISH	Abundance		
	Abundant	Common	Present
Mustie	X		
N. Pike	X		
Walleye	X		
L. M. Bass	X		
S. M. Bass	X		
Panfish	X		
Trout			

WATER AREA 368.2 ACRES
UNDER 3 FT. 14.5 %
OVER 20 FT. 35 %
MAX. DEPTH 39 FEET
TOTAL ALK. 23 P.P.M.
VOLUME 5086.5 ACRE FT.
SHORELINE 3.8 MILES