

STATE OF WISCONSIN  
DEPARTMENT OF NATURAL RESOURCES

LAKE SURVEY MAP

STAR LAKE VILAS COUNTY  
SEG. 10, 14, 15, 16, 21, 22 T. - 41 - N. R. - 8 - E. 23  
(Sheet 1 of 2)

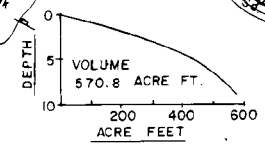
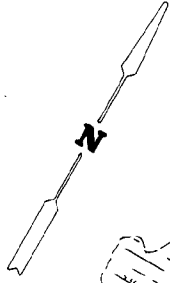
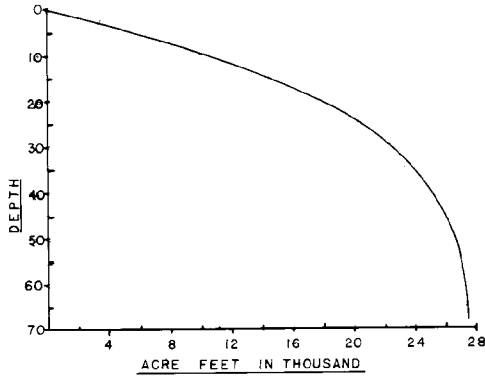

**LITTLE STAR LAKE**  
97.9 ACRES  
UNDER 3' 11%  
OVER 20' 0%  
TOTAL ALK. 36 P.P.M.  
MAIN SHORELINE 1.99 MI.

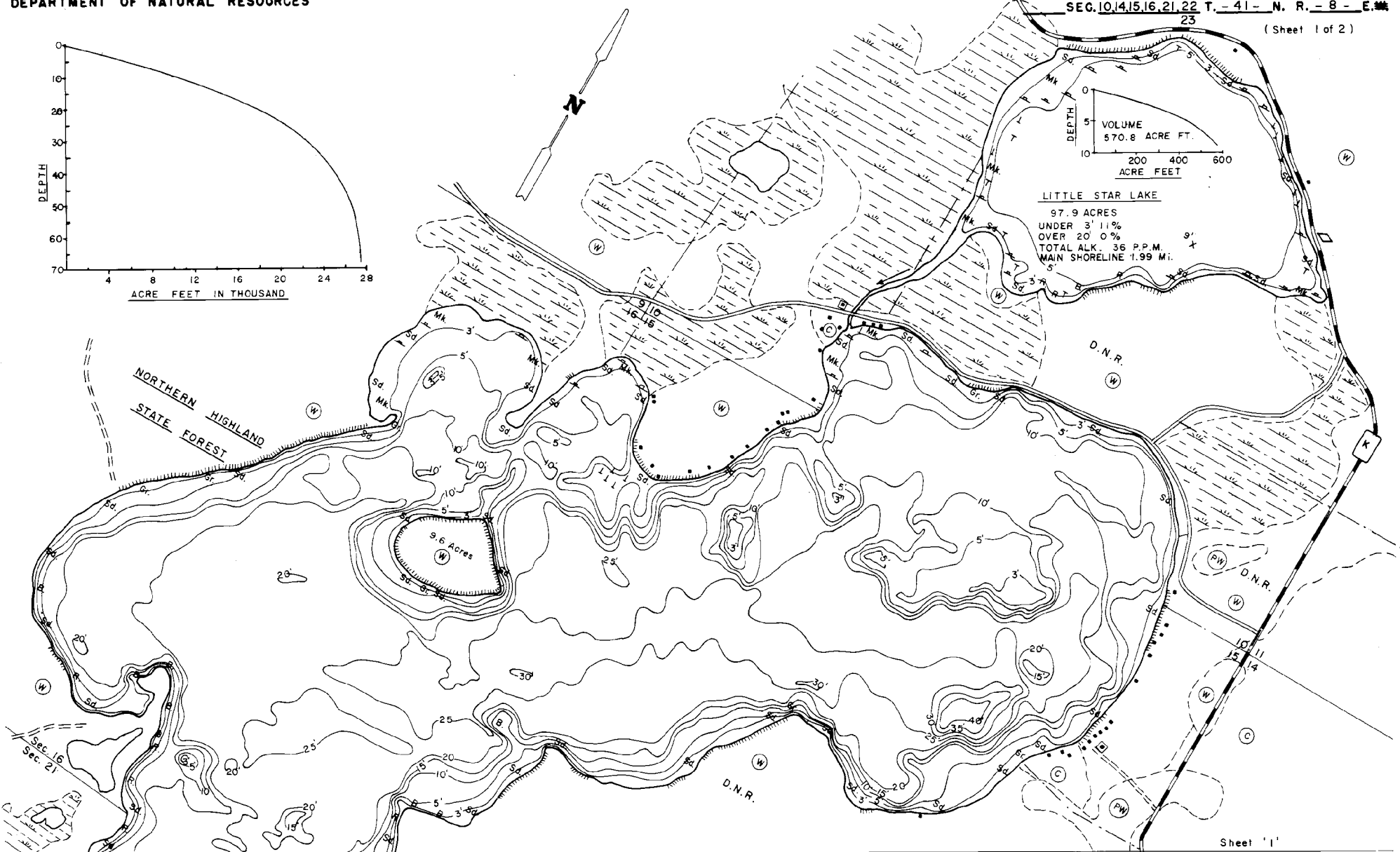

Sheet '1'  
Sheet '2'

EQUIPMENT RECORDING SONAR MAPPED OCTOBER 1976

MONTH YEAR  
LAKE BOTTOM SYMBOLS

- |  |   |   |
|--|---|---|
| <p><b>TOPOGRAPHIC SYMBOLS</b></p> <ul style="list-style-type: none"> <li>(B) Brush</li> <li>(PW) Partially wooded</li> <li>(W) Wooded</li> <li>(C) Cleared</li> <li>(P) Pastured</li> <li>(A) Agricultural</li> <li>B.M. Bench Mark</li> <li>Dwelling</li> </ul> | <ul style="list-style-type: none"> <li>      Steep slope</li> <li>- - - Indefinite shoreline</li> <li>Marsh</li> <li>Spring</li> <li>Intermittent stream</li> <li>Permanent inlet</li> <li>Permanent outlet</li> <li>Dam</li> </ul> | <ul style="list-style-type: none"> <li>P. Peat</li> <li>Mk. Muck</li> <li>C. Clay</li> <li>M. Marl</li> <li>Sd. Sand</li> <li>Sl. Silt</li> <li>Gr. Gravel</li> <li>R. Rubble</li> <li>B. Boulders</li> <li>Stumps &amp; Snags</li> <li>Rock danger to navigation</li> <li>T Submergent vegetation</li> <li>Emergent vegetation</li> <li>Floating vegetation</li> <li>Brush shelters</li> </ul> |
|--|---|---|



Access Access with Parking Boat Livery  
Drawn by: E. Eaton

SPECIES OF FISH	Abundance	
	Abundant	Present
Muskie	X	
N. Pike	X	
Walleye	X	
L. M. Bass	X	
S. M. Bass	X	
Panfish	X	
Trout	X	

WATER AREA 1,205.6 ACRES  
UNDER 3 FT. 7 %  
OVER 20 FT. 53 %  
MAX. DEPTH 68 FEET.  
TOTAL ALK. 32 P.P.M.  
VOLUME 27,469.3 ACRE FT.  
MAIN SHORELINE 10.97 MI.