

STATE OF WISCONSIN
DEPARTMENT OF NATURAL RESOURCES

LAKE SURVEY MAP

TEAL LAKE
SAWYER COUNTY
SEC. 26 27 28 33 34 T. -42 - N. R. -6 - W.

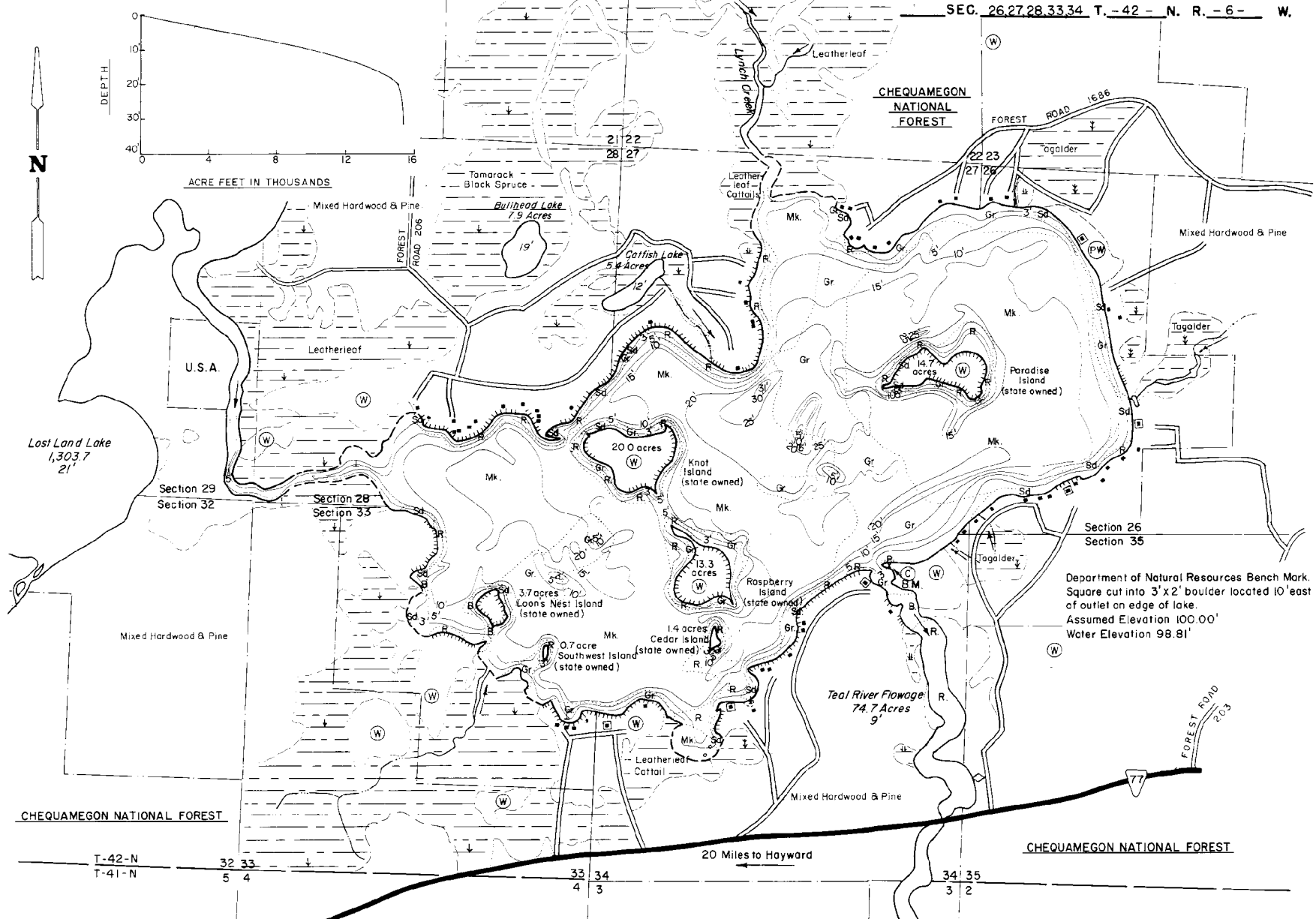

Department of Natural Resources Bench Mark.
Square cut into 3' x 2' boulder located 10' east
of outlet on edge of lake.
Assumed Elevation 100.00'
Water Elevation 98.81'

EQUIPMENT RECORDING SONAR MAPPED MAY 1969

- TOPOGRAPHIC SYMBOLS
- (B) Brush
 - (PW) Partially wooded
 - (W) Wooded
 - (C) Cleared
 - (P) Pastured
 - (A) Agricultural
 - B.M. Bench Mark
 - Dwelling
 - Dam
- LAKE BOTTOM SYMBOLS
- Steep slope
 - Indefinite shoreline
 - Marsh
 - Spring
 - Intermittent stream
 - Permanent inlet
 - Permanent outlet
 - Dam
- SOILS
- P. Peat
 - Mk. Muck
 - C. Clay
 - M. Marl
 - Sd. Sand
 - St. Silt
 - Gr. Gravel
 - R. Rubble
- LAKE BOTTOM SYMBOLS
- B Boulders
 - Stumps & Snags
 - Rock danger to navigation
 - T Submergent vegetation
 - Emergent vegetation
 - Floating vegetation
 - Brush shelters

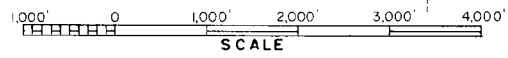

Access Access with Parking Boat Livery
Drawn by: J. Roth

SPECIES OF FISH	Abundance		
	Abundant	Common	Present
Muskie	X		
N. Pike			
Walleye	X		
L. M. Bass			X
S. M. Bass			X
Panfish	X		
T			

WATER AREA 1,048.9 ACRES
UNDER 3 FT. 1 %
OVER 20 FT. 9 %
MAX. DEPTH 31 FEET.
TOTAL ALK. 30 P.P.M.
VOLUME 15,387.9 ACRE FT.
SHORELINE 11.8 MILES