

LAKE SURVEY MAP

WISCONSIN CONSERVATION DEPARTMENT
 BIOLOGY DIVISION
 LAKE AND STREAM IMPROVEMENT SECTION

LAKE TRAVERS
 SECTION 6-7
 TOWNSHIP 45 N
 RANGE 8 W
 TOWN OF DRUMMOND
 COUNTY BAYFIELD

FORM FH17

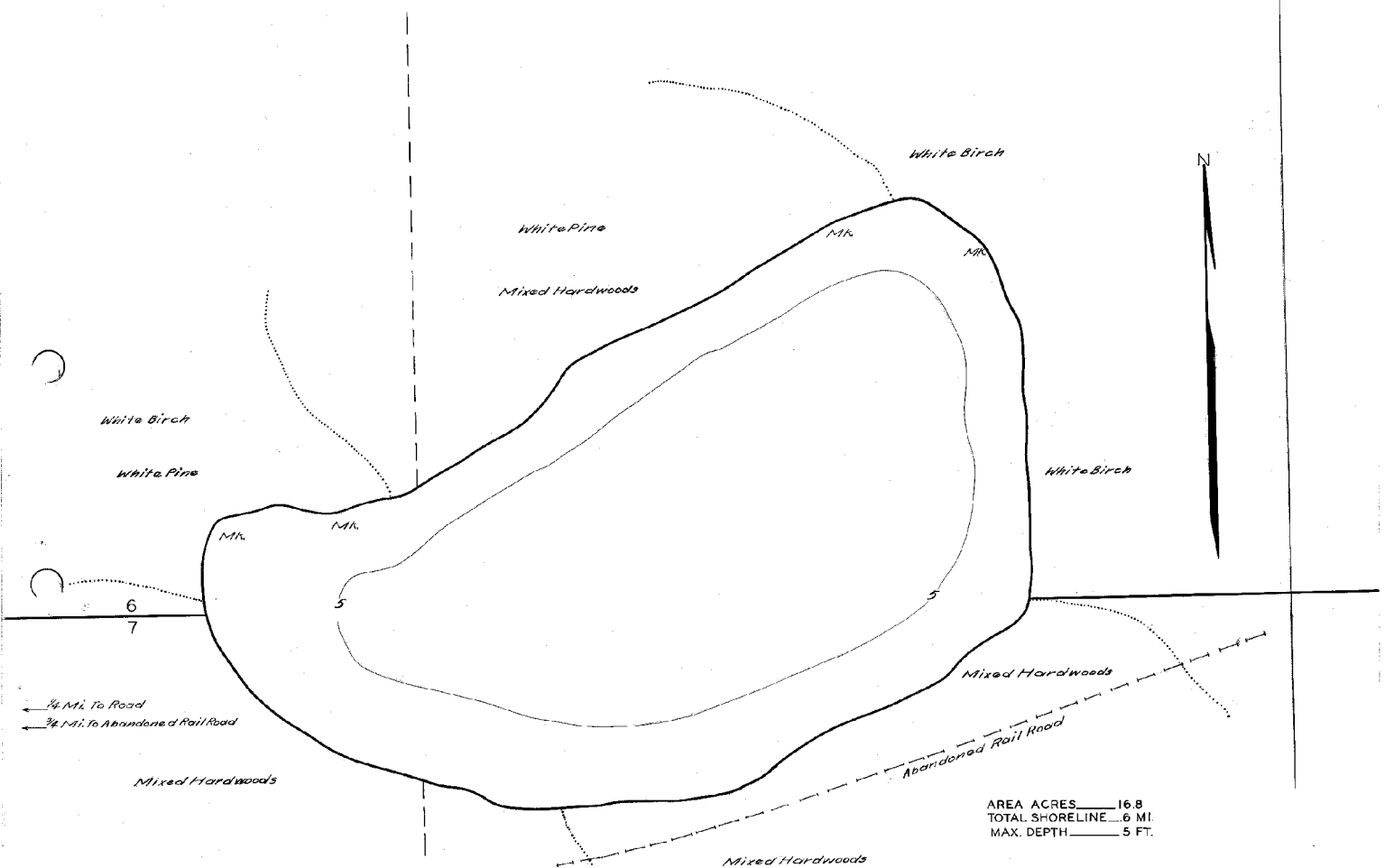

← 1/4 Mi. To Road
 ← 3/4 Mi. To Abandoned Rail Road

AREA ACRES 16.8
 TOTAL SHORELINE .6 MI.
 MAX. DEPTH 5 FT.

SCALE 1 INCH EQUALS 110 FT.

Checked
 W.P.S.
 EMK
 11/13/1941

DATE OCT. 1, 1941
 COMPILED BY _____
 TRACED BY W.T.Z. (W.P.A.)
 SOURCE OF INFORMATION
U.S. FOREST LAKE AND STREAM
SURVEY
 SOUNDINGS _____
 DATES OF MAP REVISION _____
 WORK AGENCY _____

LAKE IMPROVEMENT RECORD	
TYPE	DATE
BRUSH REFUGES	_____
SPAWNING BOXES	_____
SAPLING TANGLES	_____
* MINNOW SPAWNERS	_____
TOTAL	_____

LEGEND	
	WEED BEDS
	ROCKY SHOALS
	SAND
	CLAY
	GRAVEL
	MUCK
	DWELLING
	ABANDONED DWELLING
	RESORT

Maps are not for navigation
 Source-Wisconsin Department of Natural Resources
 Hunt Fish Camp Wisconsin .Com 2005