

STATE OF WISCONSIN
DEPARTMENT OF NATURAL RESOURCES

LAKE SURVEY MAP

TWO SISTERS LAKE ONEIDA COUNTY
SEC. 17, 18, 19, 20 T. 38 N. R. 8 E.

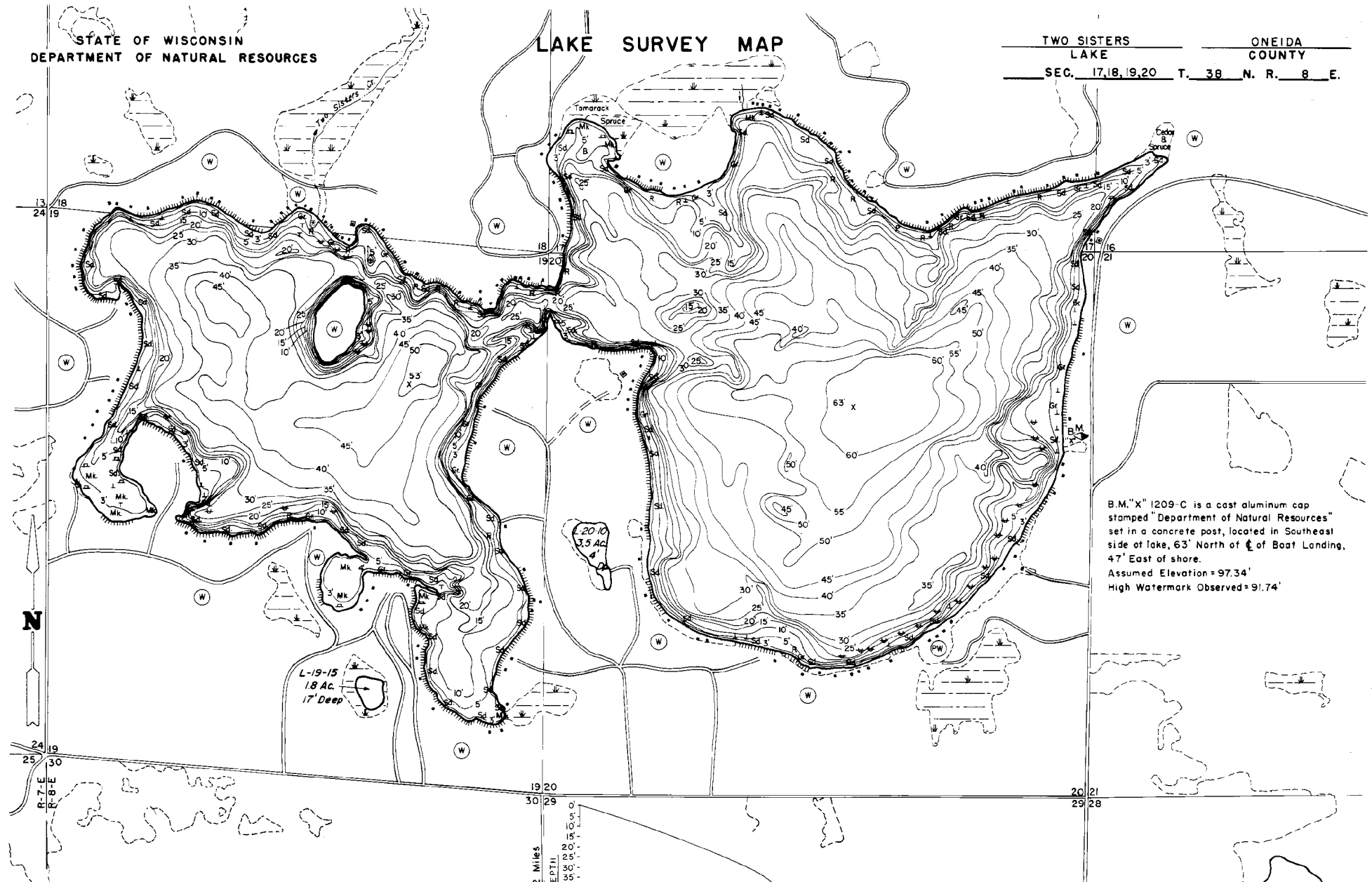

B.M. "X" 1209-C is a cast aluminum cap stamped "Department of Natural Resources" set in a concrete post, located in Southeast side of lake, 63' North of $\frac{1}{2}$ of Boat Landing, 47' East of shore.
Assumed Elevation = 97.34'
High Watermark Observed = 91.74'

EQUIPMENT RECORDING SONAR MAPPED OCT. 1975
MONTH YEAR

- TOPOGRAPHIC SYMBOLS**
- (B) Brush
 - (W) Partially wooded
 - (W) Wooded
 - (C) Cleared
 - (P) Pastured
 - (A) Agricultural
 - B.M. Bench Mark
 - Dwelling
 - Resort
 - Camp
- LAKE BOTTOM SYMBOLS**
- ||||| Steep slope
 - - - Indefinite shoreline
 - ~ Marsh
 - ~ Spring
 - - - Intermittent stream
 - Permanent inlet
 - Permanent outlet
 - Dam
 - D.N.R. State owned land
- LAKE BOTTOM SYMBOLS**
- P. Peat
 - Mk. Muck
 - C. Clay
 - M. Marl
 - Sd. Sand
 - Sl. Silt
 - Gr. Gravel
 - R. Rubble
 - Bc. Bedrock
 - B Boulders
 - ⊙ Stumps & Snags
 - ⊙ Rock danger to navigation
 - T Submergent vegetation
 - ⊥ Emergent vegetation
 - △ Floating vegetation
 - ⊙ Brush shelters

M. Naughton 2 Miles

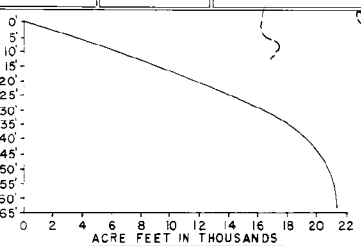

Access Access with Parking Boat Livery
Drawn by: G. Thuesen
Field work by: J. Smith, K. Arnold

SPECIES OF FISH	ABUNDANCE	
	Common	Present
Muskie	X	
N. Pike	X	
Walleye	X	
L. W. Bass	X	
S. W. Bass	X	
Panfish	X	
Traut		
Cisco	X	

WATER AREA 719 ACRES
UNDER 3 FT. 3.65 %
OVER 20 FT. 70.4 %
MAX. DEPTH 63 FEET.
TOTAL ALK. 26 P.P.M.
VOLUME 21325.6 ACRE FT.
MAIN SHORELINE 8.66 MI.
ISLAND SHORELINE 0.68 MI.