

WISCONSIN CONSERVATION DEPARTMENT

LAKE SURVEY MAP

VAN ORDER POND  
LAKE  
PORTAGE COUNTY  
SEC. 36, 31, 1, 6 T. 24, 25 N. R. 8, 9 E. 1/4

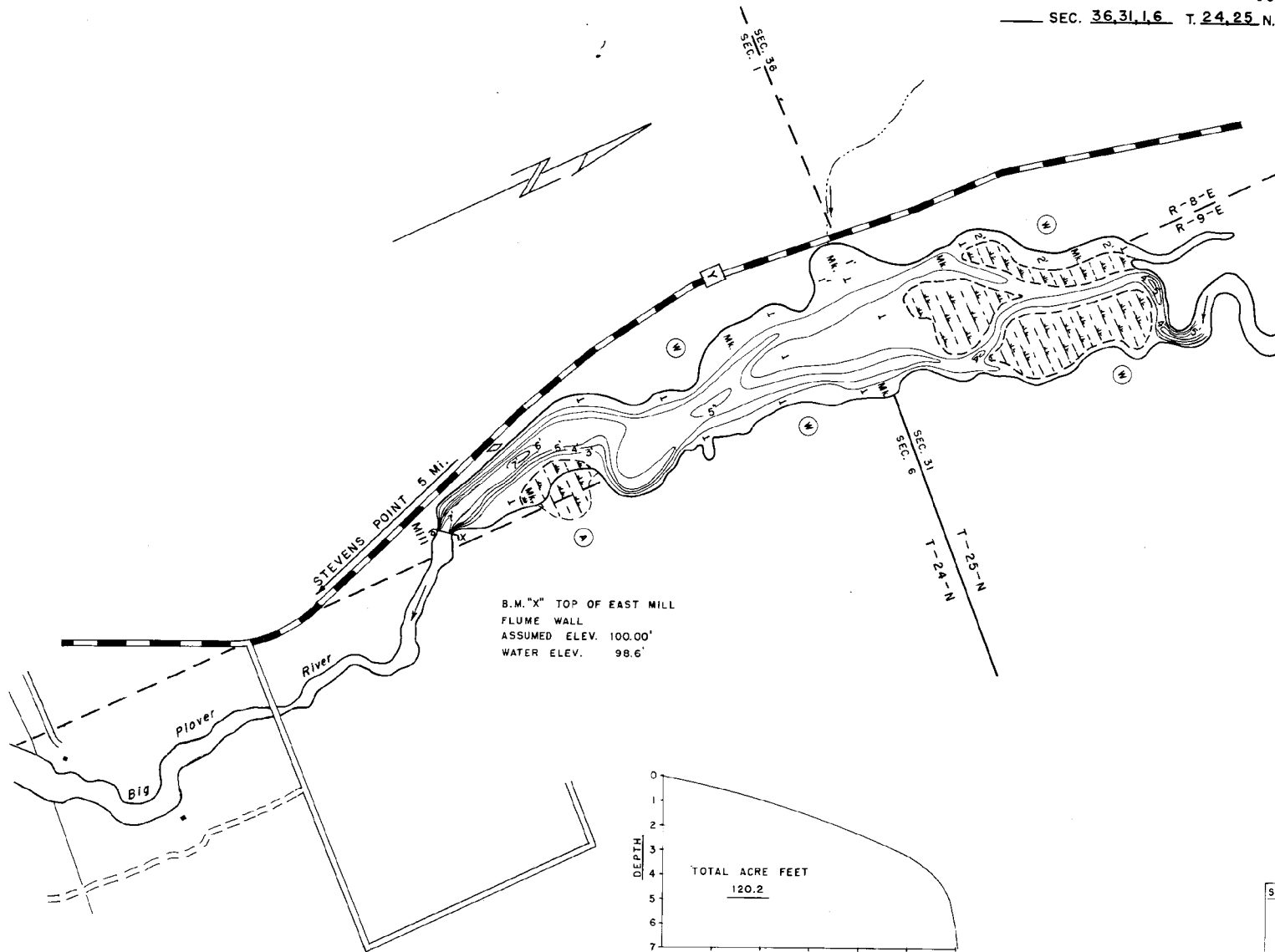

B.M. "X" TOP OF EAST MILL  
FLUME WALL  
ASSUMED ELEV. 100.00'  
WATER ELEV. 98.6'

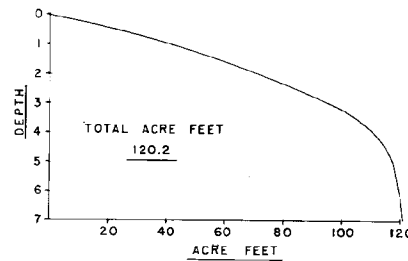

TOTAL ACRE FEET  
120.2

EQUIPMENT: SONAR MAPPED JUNE 1964

- TOPOGRAPHIC SYMBOLS
- (B) Brush
  - (PW) Partly wooded
  - (W) Wooded
  - (C) Cleared
  - (P) Pastured
  - (A) Agricultural
  - B.M. Bench Mark
  - Dwelling
  - Resort
- LAKE BOTTOM SYMBOLS
- ||||| Steep slope
  - - - Indefinite shoreline
  - Marsh
  - Spring
  - Intermittent stream
  - Permanent inlet
  - Permanent outlet
  - Dam
  - P. Peat
  - Mk. Muck
  - C. Clay
  - M. Marl
  - Sd. Sand
  - St. Silt
  - Gr. Gravel
  - R. Rubble
  - Br. Bedrock
  - T. Submergent vegetation
  - I. Emergent vegetation
  - △ Floating vegetation

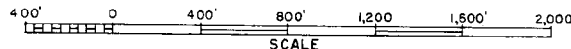

◇ Access    ◇ Access with Parking    ◆ Boat Livery  
Field work by: H. Schmude, F. Hibert    Drawn by: E. Eaton

SPECIES OF FISH		Abundant Common Rare
Muskie		
N. Pike		
Walleye		
L. M. Bass		
S. M. Bass		
Panfish		
Trot		

53.2 WITH MARSH  
AREA 41.6 ACRES  
UNDER 3FT. 46 %  
OVER 20FT. 0 %  
VOLUME 120.2 ACRE FT.  
TOTAL ALK. 172 P.P.M.  
SHORELINE 3.2 MILES  
MAX. DEPTH 7 FEET