

Hunt Fish Camp Wisconsin

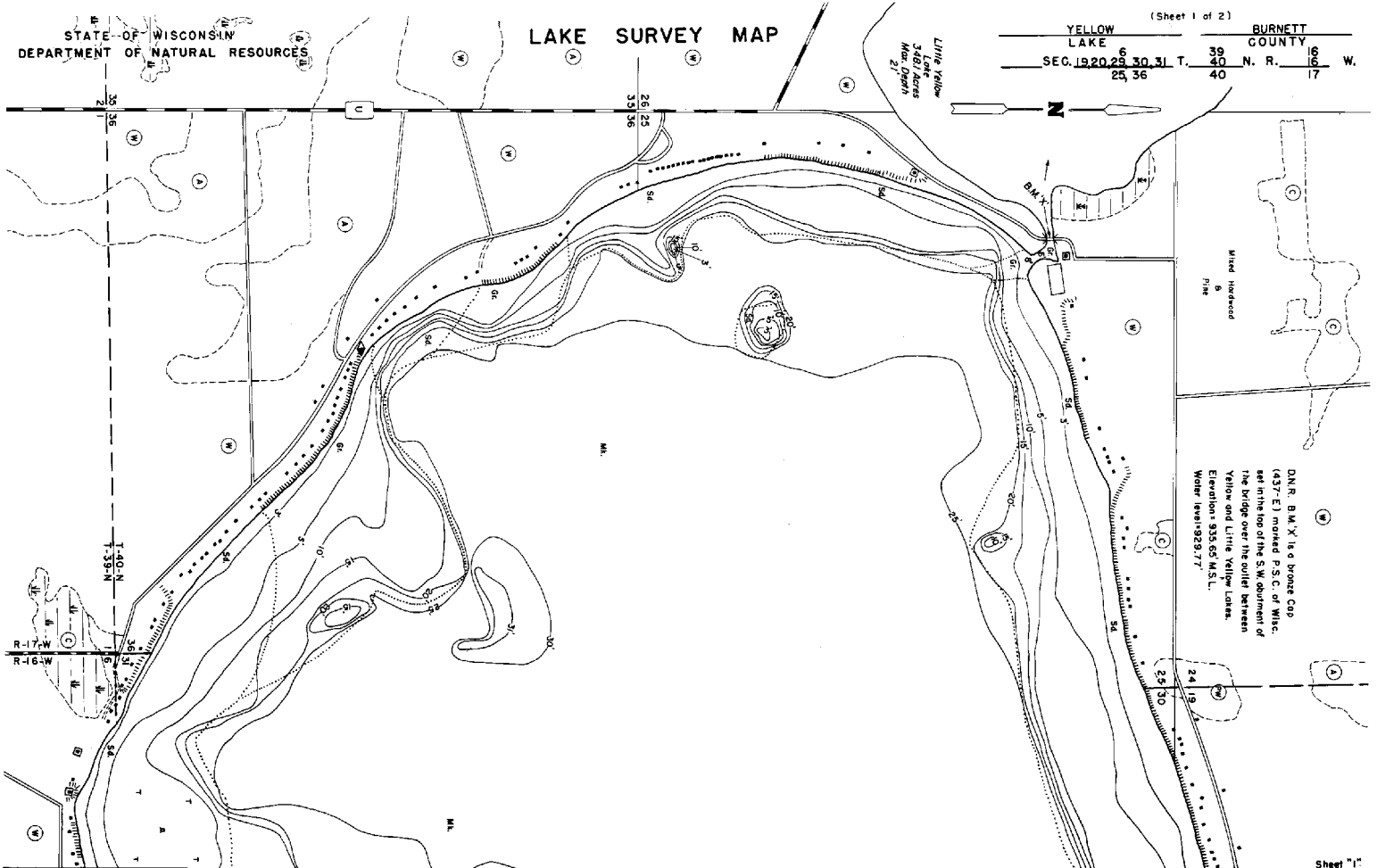

EQUIPMENT RECORDING SONAR MAPPED AUGUST 1973	
NORTH YEAR	
LAKE BOTTOM SYMBOLS	
TOPOGRAPHIC SYMBOLS	LAKE BOTTOM SYMBOLS
(B) Brush	P. Peat
(PW) Partially wooded	Mk. Muck
(W) Wooded	C. Clay
(C) Cleared	M. Marl
(P) Pastured	Sd. Sand
(A) Agricultural	Ss. Silt
B.M. Bench Mark	Gr. Gravel
(D) Dwelling	R. Rubble
(R) Resort	Bc. Bedrock
(C) Camp	
(S) Steep slope	B. Boulders
(I) Indefinite shoreline	St. Stumps & Snags
(M) Marsh	Rd. Rock danger to navigation
(S) Spring	T. Submergent vegetation
(IS) Intermittent stream	E. Emergent vegetation
(PI) Permanent inlet	F. Flooding vegetation
(PO) Permanent outlet	BS. Brush shelters
(Dm) Dam	
(D.N.R.) State owned land	

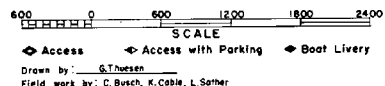

SPECIES OF FISH	ABUNDANCE	
	Common	Present
Muskie	X	X
T. Pike	X	X
Walleye	X	X
L. M. Bass	X	X
S. M. Bass	X	X
Panfish	X	X
Lake Sturgeon	X	X
Cisco	X	X

WATER AREA	2287.0 ACRES
UNDER 3 FT.	7 %
OVER 20 FT.	68 %
MAX. DEPTH	31 FEET.
TOTAL ALK.	80 P.P.M.
VOLUME	43334.2 ACRE FT.
MAIN SHORELINE	7.87 MI.
ISLAND SHORELINE	MI.

Maps are not for navigation
 Source-Wisconsin Department of Natural Resources
 Hunt Fish Camp Wisconsin .Com 2005