

STATE OF WISCONSIN  
DEPARTMENT OF NATURAL RESOURCES

LAKE SURVEY MAP

APPLE FALLS FLOWAGE  
LAKE  
ST. CROIX  
COUNTY  
SEC. 22, 26, 27 T. 31 N. R. 19 W.  
SHEET 1 OF 2

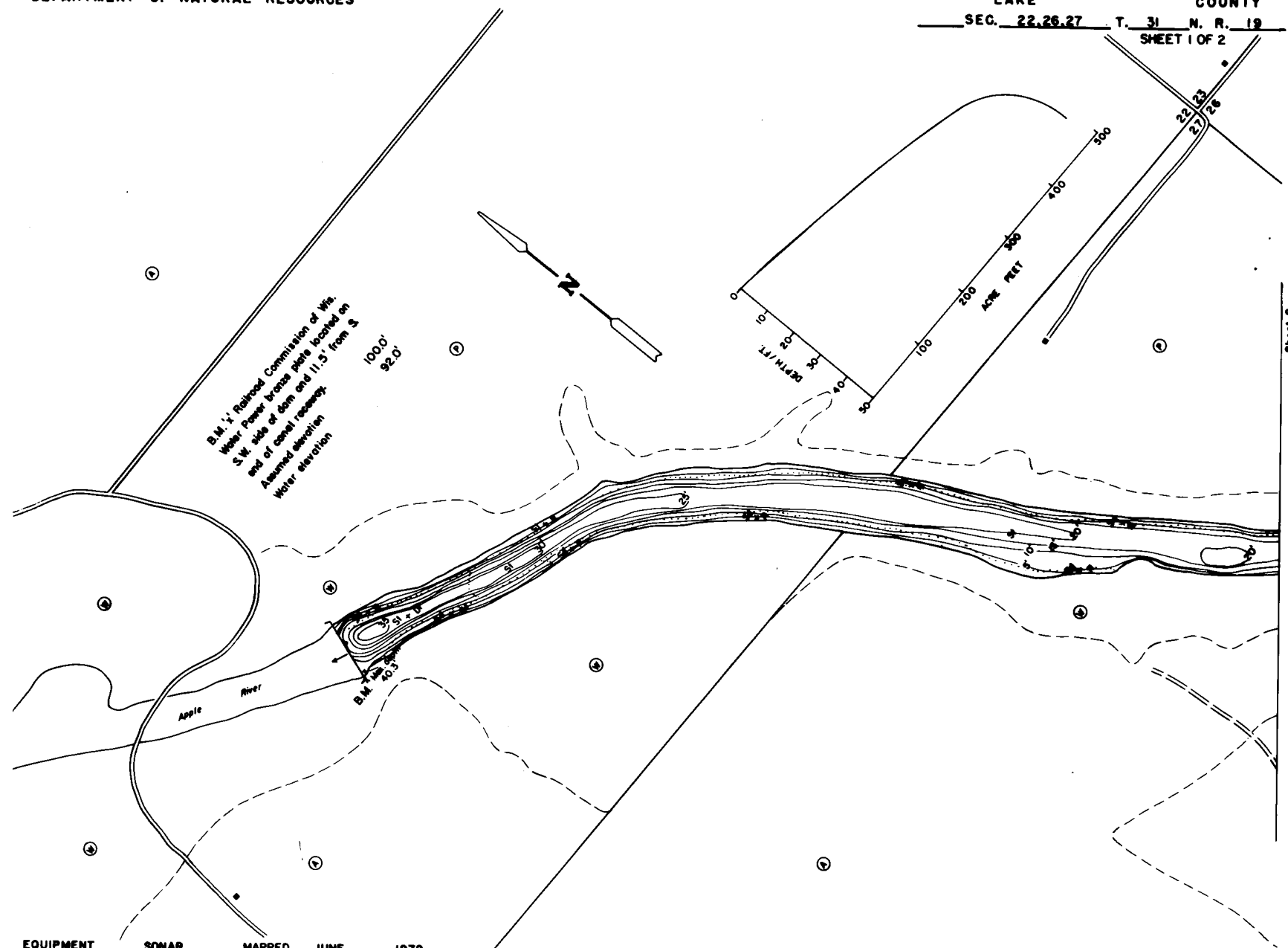

Sheet 2

EQUIPMENT SONAR MAPPED JUNE 1972

- TOPOGRAPHIC SYMBOLS
- (B) Brush
  - (PW) Partially wooded
  - (W) Wooded
  - (C) Cleared
  - (P) Pastured
  - (A) Agricultural
  - B.M. Bench Mark
  - ||||| Steep slope
  - - - Indefinite shoreline
  - Marsh
  - Spring
  - Intermittent stream
  - Permanent inlet
  - Permanent outlet
  - P. Peat
  - Mk. Muck
  - C. Clay
  - M. Marl
  - Sd. Sand
  - Sl. Silt
  - Gr. Gravel
  - B Boulders
  - Stumps & Snags
  - Rock danger to navigation
  - T Submergent vegetation
  - Emergent vegetation
  - Floating vegetation
  - Brush shelters



Access Access with Parking Boat Livery

SPECIES OF FISH	ABUNDANCE	
	Abundant	Common
Muskie		
N. Pike		
Walleye		
L. M. Bass		
S. M. Bass	X	

WATER AREA 39.1 ACRES  
 UNDER 3 FT. 12.3 %  
 OVER 20 FT. 17.4 %  
 MAX. DEPTH 40.3 FEET.  
 TOTAL ALK. 124 P.P.M.  
 VOLUME 495.3 ACRE FT.