

WISCONSIN DEPARTMENT OF NATURAL RESOURCES

LAKE SURVEY MAP

LAKE CLEAR
 SECTION 20
 TOWNSHIP 4-N
 RANGE 13-E
 TOWN MILTON
 COUNTY ROCK

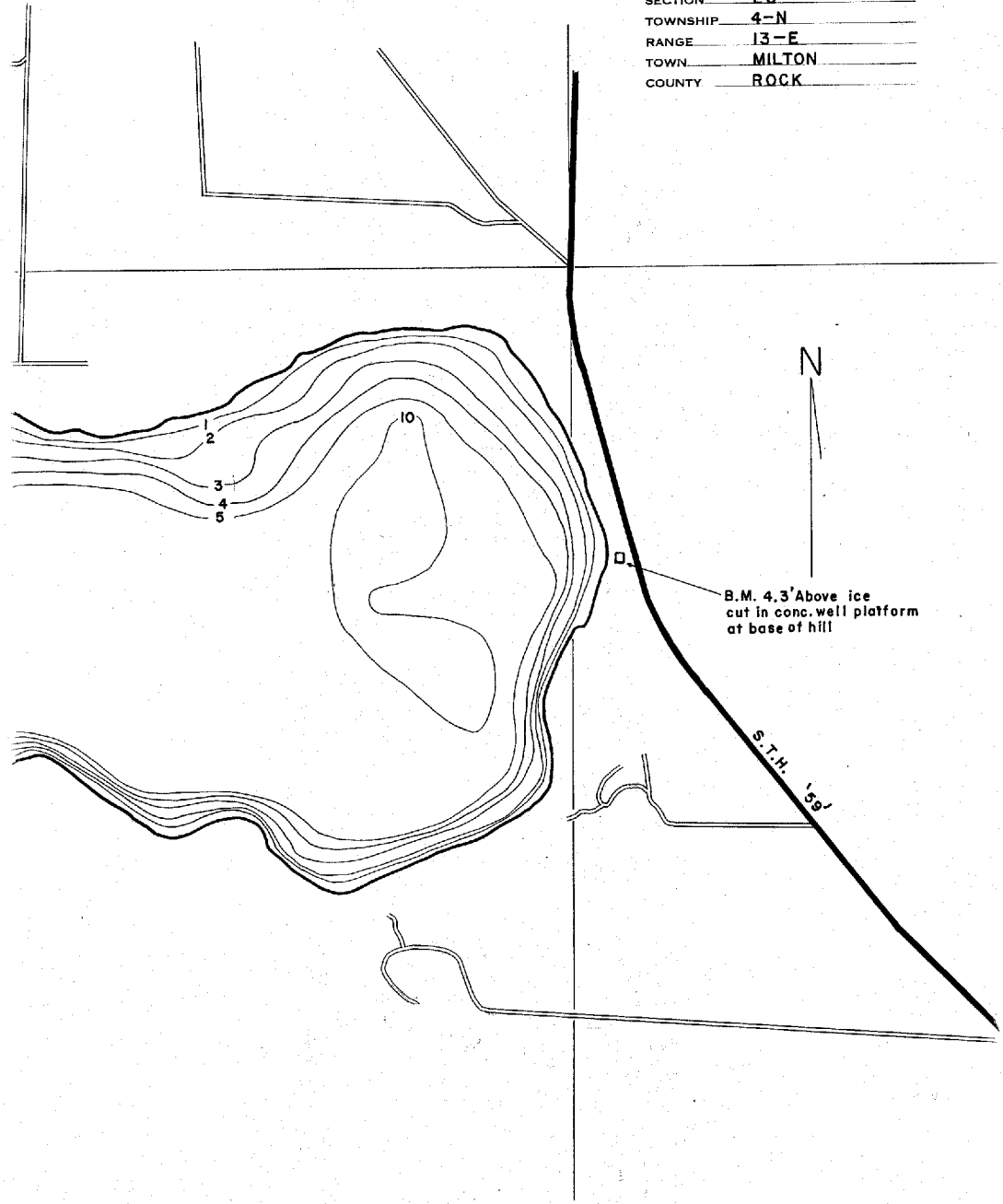

AREA 87.5 Acres
 TOTAL SHORELINE 1.1 Mile
 MAX. DEPTH 12 Feet

SCALE: 1" = 300'