

WISCONSIN CONSERVATION DEPARTMENT

LAKE SURVEY MAP

EMERY LAKE MARQUETTE COUNTY  
 SEC. 8, 17 T. 15- N. R. 9- E.W.

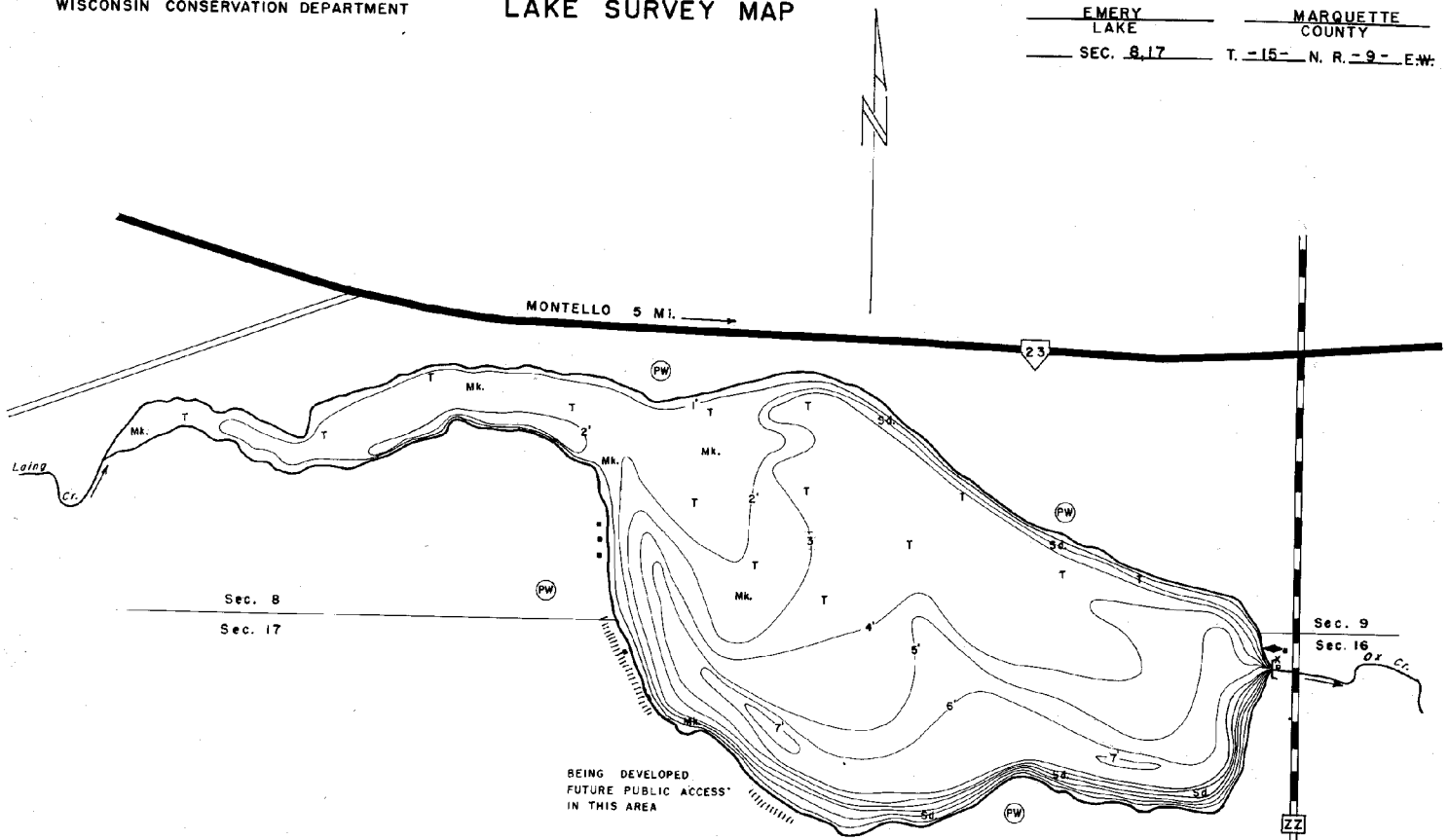

BEING DEVELOPED  
 FUTURE PUBLIC ACCESS  
 IN THIS AREA

B.M. "X" TOP CEMENT PLATFORM NEAREST  
 TO DAM GATE WITH IRON BEAM IN EDGE  
 ASSUMED ELEV. 100.00'  
 WATER ELEV. 97.5'

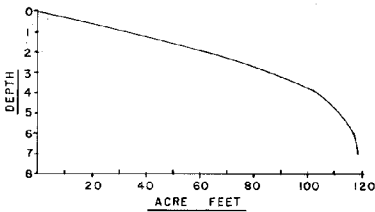

SPECIES OF FISH		Abundant	Rare
Muskie			
N. Pike	X		
Walleye			
L.M. Bass	X		
S.M. Bass			
Parfish	X		
Trot			

EQUIPMENT SONAR MAPPED MAY 1964  
 MO. YR.

- TOPOGRAPHIC SYMBOLS
- (B) Brush
  - (PW) Partially wooded
  - (W) Wooded
  - (C) Cleared
  - (P) Pastured
  - (A) Agricultural
  - B.M. Bench Mark
  - Dwelling
  - Resort
- LAKE BOTTOM SYMBOLS
- P. Peat
  - MK. Muck
  - C. Clay
  - M. Marl
  - Sd. Sand
  - Sf. Silt
  - Gr. Gravel
  - R. Rubble
  - Br. Bedrock
  - T. Submergent vegetation
  - I. Emergent vegetation
  - F. Floating vegetation

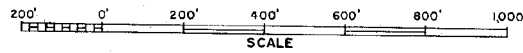

Access Access with Parking Boat Livery  
 Field work by H. Schmede, F. Hilbert Drawn by: E. Eaton

AREA 34.5 ACRES  
 UNDER 3FT. 38 %  
 OVER 20FT. 0 %  
 VOLUME 118.8 ACRE FT.  
 TOTAL ALK. 160 P.P.M.  
 SHORELINE 1.3 MILES  
 MAX. DEPTH 7 FEET

Maps are not for navigation  
 Source-Wisconsin Department of Natural Resources  
 Hunt Fish Camp Wisconsin .Com 2005