

WISCONSIN CONSERVATION DEPARTMENT

LAKE SURVEY MAP

LAWRENCE LAKE MARQUETTE COUNTY  
 SEC. 5, 8, 9 T. - 16 - N. R. - 8 - E. W.

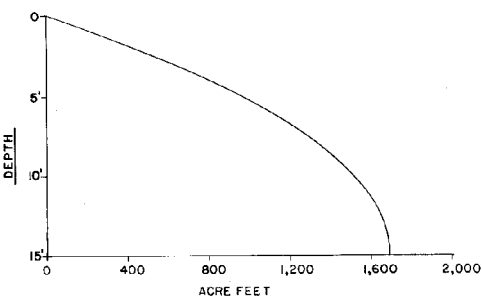
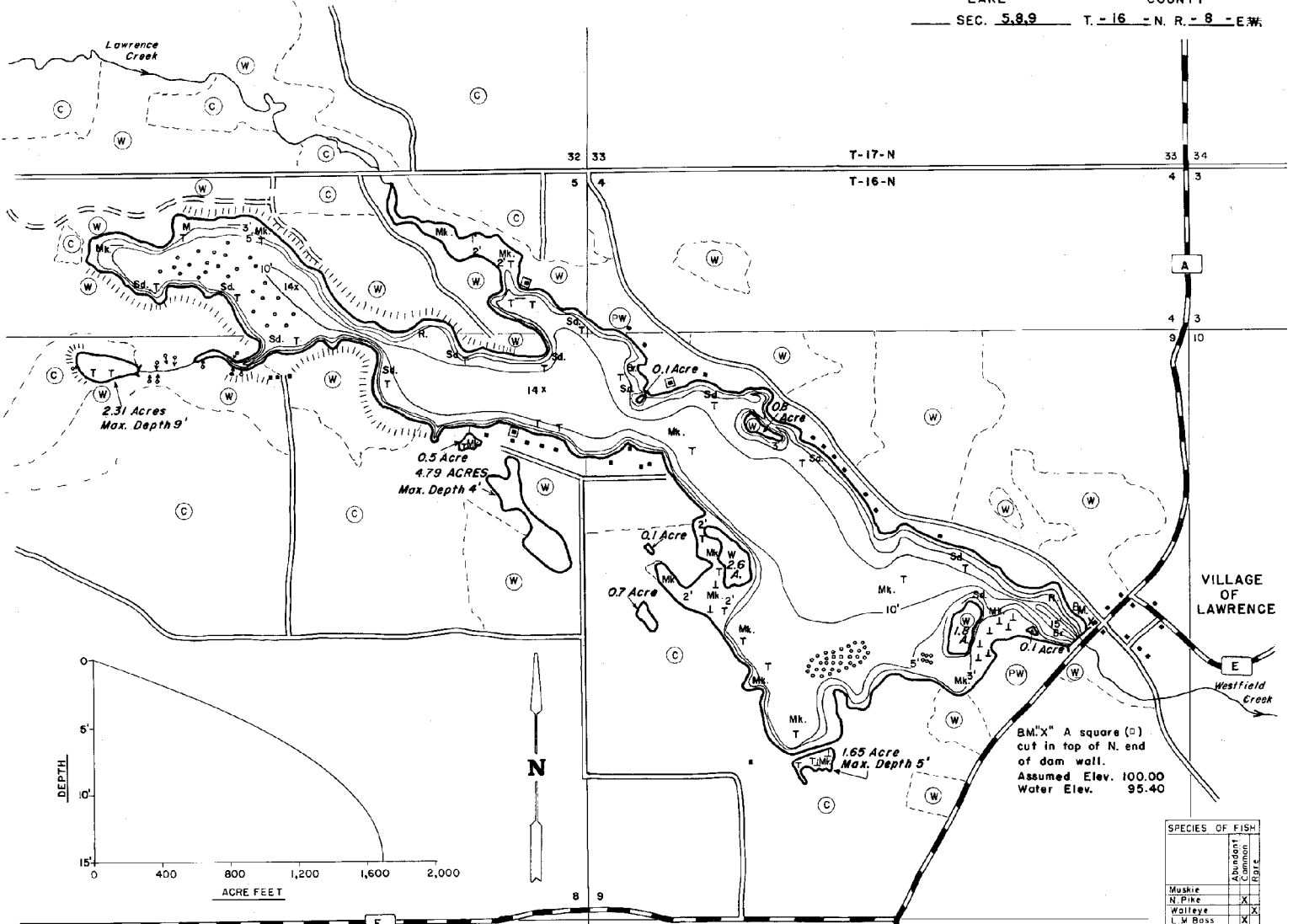

BM "X" A square (□) cut in top of N. end of dam wall. Assumed Elev. 100.00 Water Elev. 95.40

SPECIES OF FISH		Abundance	Percentage
Species	Count		
Muskie			
N. Pike		X	
Walleye		X	
L. W. Bass		X	
S. W. Bass		X	
Ponfish		X	
Trotl			

- EQUIPMENT SONAR MAPPED MAY 1966  
 MO. YR.  
 WATER ELEV. 95.40
- TOPOGRAPHIC SYMBOLS**
- (B) Brush
  - (W) Partially wooded
  - (C) Cleared
  - (P) Pastured
  - (A) Agricultural
  - BM Bench Mark
  - Dwelling
  - ▣ Resort
- LAKE BOTTOM SYMBOLS**
- P. Peat
  - Mk. Muck
  - C. Clay
  - M. Marl
  - Sd. Sand
  - St. Silt
  - Gr. Gravel
  - R. Rubble
  - Br. Bedrock
  - T. Submergent vegetation
  - ↓ Emergent vegetation
  - ⊕ Floating vegetation
- Other Symbols:** Steep slope, indefinite shoreline, Marsh, Spring, Intermittent stream, Permanent inlet, Permanent outlet, Dam

600' 0' 600' 1,200' 1,800' 2,400' 3,000'  
 SCALE  
 ◊ Access      ◊ Access with Parking      ◊ Boat Livery  
 Field work by: H. Schmuide, T. Corbett Drawn by: C. Harrison

WITH ISLANDS 225.91 ACRES  
 AREA 220.54 ACRES  
 UNDER 3 FT. 14 %  
 OVER 20 FT. 0 %  
 VOLUME 1688.0 ACRE FT.  
 TOTAL ALK. 90 P.P.M.  
 SHORELINE 6.87 MILES  
 MAX. DEPTH 14 FEET

Maps are not for navigation  
 Source-Wisconsin Department of Natural Resources  
 Hunt Fish Camp Wisconsin .Com 2005