

STATE OF WISCONSIN  
DEPARTMENT OF NATURAL RESOURCES

LAKE SURVEY MAP

LITTLE FALLS POND  
LAKE

ST. CROIX  
COUNTY

SEC. 4.8.9

T.-29- N. R.-19- P.W.

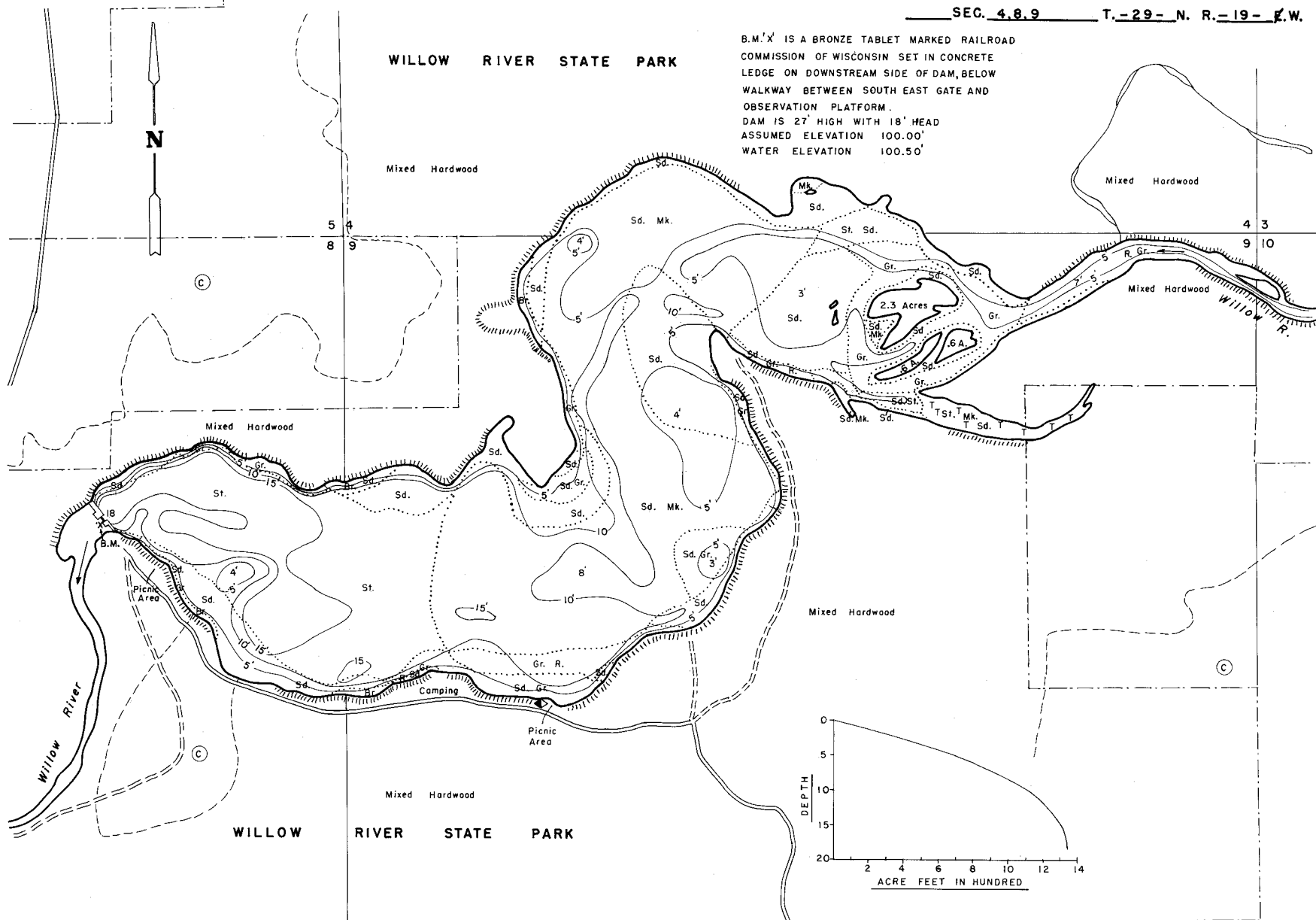

B.M.'X IS A BRONZE TABLET MARKED RAILROAD COMMISSION OF WISCONSIN SET IN CONCRETE LEDGE ON DOWNSTREAM SIDE OF DAM, BELOW WALKWAY BETWEEN SOUTH EAST GATE AND OBSERVATION PLATFORM.  
DAM IS 27' HIGH WITH 18' HEAD ASSUMED ELEVATION 100.00' WATER ELEVATION 100.50'

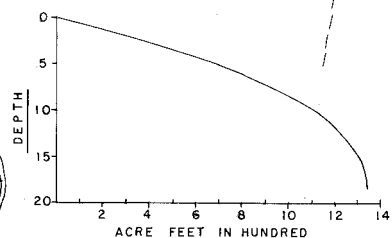

EQUIPMENT SONAR & POLE MAPPED MAY 1970

- | TOPOGRAPHIC SYMBOLS   |                            | LAKE BOTTOM SYMBOLS |                             |
|-----------------------|----------------------------|---------------------|-----------------------------|
| (B) Brush             | (     ) Steep slope        | P. Peat             | B. Boulders                 |
| (PW) Partially wooded | (---) Indefinite shoreline | Mk. Muck            | ☼ Stumps & Snags            |
| (W) Wooded            | (~) Marsh                  | C. Clay             | ⚡ Rock danger to navigation |
| (C) Cleared           | (o) Spring                 | M. Marl             | T Submergent vegetation     |
| (P) Pastured          | (---) Intermittent stream  | Sd. Sand            | ⌋ Emergent vegetation       |
| (A) Agricultural      | (---) Permanent inlet      | St. Silt            | ⌋ Floating vegetation       |
| B.M. Bench Mark       | (---) Permanent outlet     | Gr. Gravel          | ⌋ Brush shelters            |
| (■) Dwelling          | (---) Dam                  | R. Rubble           |                             |

Hudson 3 Miles



◆ Access    ◆ Access with Parking    ◆ Boat Livery

Drawn by: E. Eaton

SPECIES OF FISH	Abundance		
	Abundant	Common	Present
Muskie			
N. Pike			
Walleye			
L.M. Bass		X	
S.M. Bass		X	
Panfish	X		

WATER AREA 171.6 ACRES  
 UNDER 3 FT. 38 %  
 OVER 20 FT. 0 %  
 MAX. DEPTH 18 FEET.  
 TOTAL ALK. 147 P.P.M.  
 VOLUME 1,342.8 ACRE FT.  
 SHORELINE 4.86 MILES