

STATE OF WISCONSIN  
DEPARTMENT OF NATURAL RESOURCES

LAKE SURVEY MAP

LAKE MALLALIEU LAKE ST CROIX COUNTY  
SEC. 18, 19, 13, 24 T. -29- N. R. -20- W.

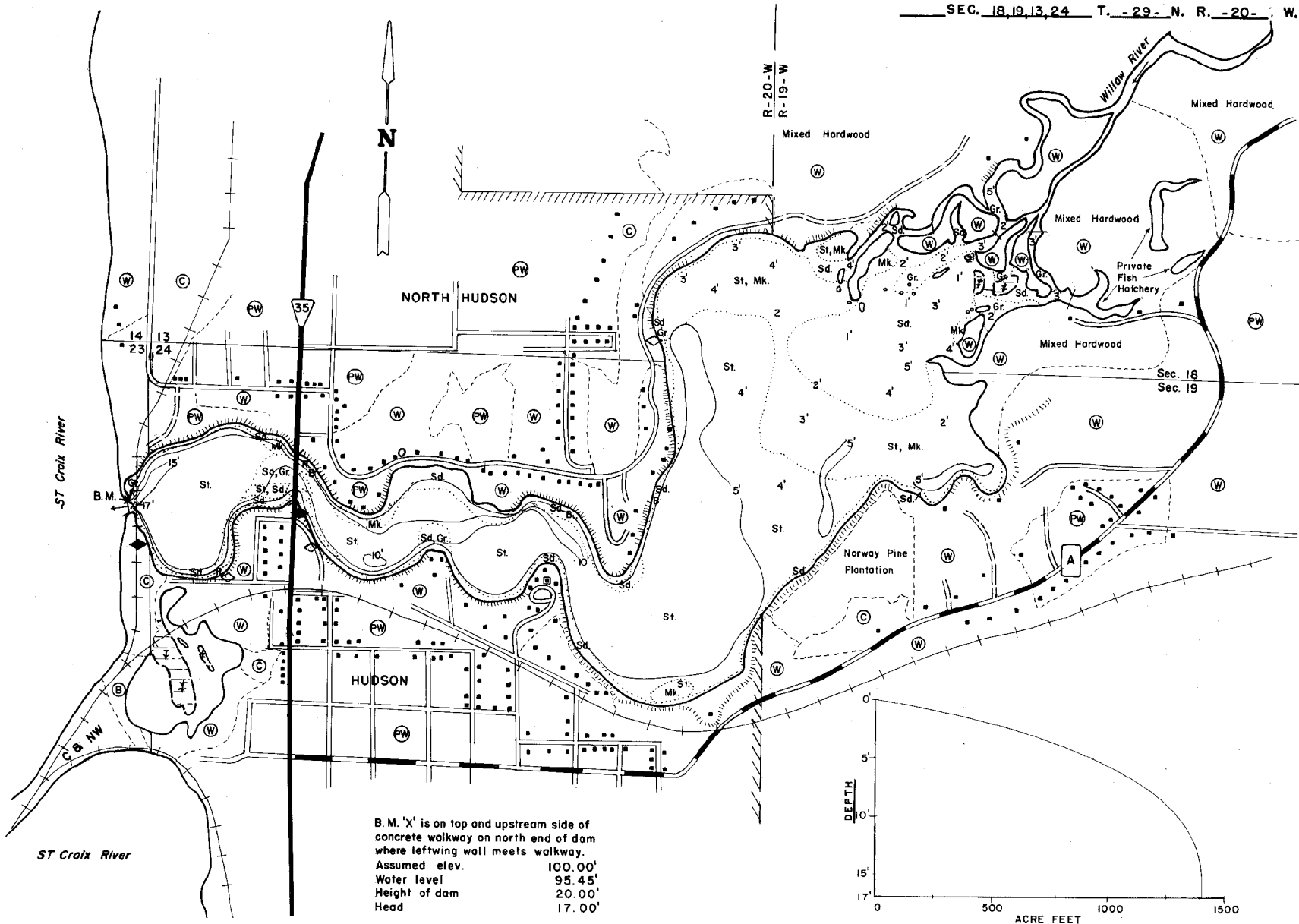

B.M. 'X' is on top and upstream side of concrete walkway on north end of dam where lefting wall meets walkway.  
Assumed elev. 100.00'  
Water level 95.45'  
Height of dam 20.00'  
Head 17.00'

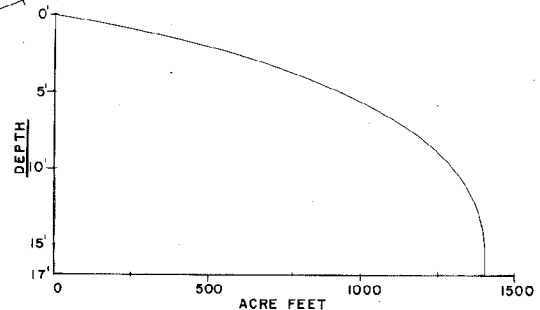

EQUIPMENT RECORDING SONAR MAPPED MAY 1970

- | TOPOGRAPHIC SYMBOLS   |                            | LAKE BOTTOM SYMBOLS |                             |
|-----------------------|----------------------------|---------------------|-----------------------------|
| (B) Brush             | Steep slope                | P. Peat             | B Boulders                  |
| (PW) Partially wooded | - - - Indefinite shoreline | Mk. Muck            | ⊙ Stumps & Snags            |
| (W) Wooded            | ▨ Marsh                    | C. Clay             | ⊙ Rock danger to navigation |
| (C) Cleared           | ○ Spring                   | M. Marl             | ⊙ Submergent vegetation     |
| (P) Pastured          | ~ Intermittent stream      | Sd. Sand            | ⊙ Emergent vegetation       |
| (A) Agricultural      | ▬ Permanent inlet          | St. Silt            | ⊙ Floating vegetation       |
| B.M. Bench Mark       | ▬ Permanent outlet         | Gr. Gravel          | ⊙ Brush shelters            |
| ■ Dwelling            | ▬ Dam                      | R. Rubble           |                             |
| □ Resort              | ▬ State owned land         | Rc. Redcock         |                             |



Access Access with Parking Boat Livery  
Drawn by: W. Snyders

SPECIES OF FISH	Abundance		
	Abundant	Common	Present
Muskie			
N. Pike			X
Walleye			X
L. M. Bass			X
S. M. Bass			X
Panfish			X
Trout			X

WATER AREA 269.6 ACRES  
UNDER 5 FT. 59 %  
OVER 20 FT. 0 %  
MAX. DEPTH 17 FEET.  
TOTAL ALK. \_\_\_\_\_ P.P.M.  
VOLUME 1388 ACRE FT.  
SHORELINE 5.02 MILES